



PRICED AT  
**\$424,900**

 1703 Sq Ft

 3 Beds

 3.5 Baths

 1 Car Garage

 3.0 Story

Elevate Your Savings at Market Square with Preferred Lender Rate Buy Downs for the month of February! Discover the Oleander Plan built by The Providence Group. Quick Move In! The Oleander Plan spans 3 levels and offers 3 bedrooms, 3.5 bathrooms, and 1,703 sq. ft. of stylish, low-maintenance living. Designed and curated with The Providence Group's Cool Linen Design Collection, this home is perfect for modern lifestyles. **Terrace Level:** Enter from your oversized 1-car garage with EV charger and a private driveway for additional parking. Enjoy an oversized private bedroom with full bath and access to a covered terrace—ideal for guests, a home office, or personal gym. An additional coat closet and Laundry with GE Profiles 2 in 1 Washer/Dryer included with the home! **Main Level:** The open-concept layout is perfect for entertaining, featuring a spacious 8 ft. island topped with Calacatta Ultra quartz countertops and accented by pendant lighting. The kitchen includes 42" soft-close white cabinetry, GE appliances, and a GE Profile refrigerator, making this home truly turn-key. Piedmont Ambassador flooring flows throughout the main level, offering a sleek, low-maintenance surface ideal for hosting. Additional pantry space provides ample storage, and a convenient half bath completes this level. **Upper ...**

**Want to Know More  
About This Home?**

CONTACT OUR COMMUNITY SALES MANAGER  
Call Us @ 678.372.1644

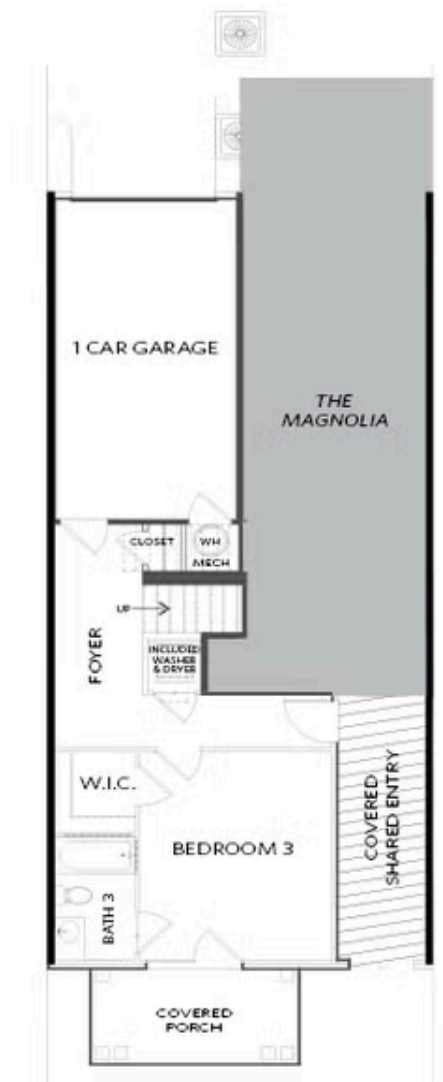

FIRST FLOOR

Elevations 1 & 1A Floor Plan Layout

Want to Know More  
About This Home?

CONTACT OUR COMMUNITY SALES MANAGER  
Call Us @ 678.372.1644

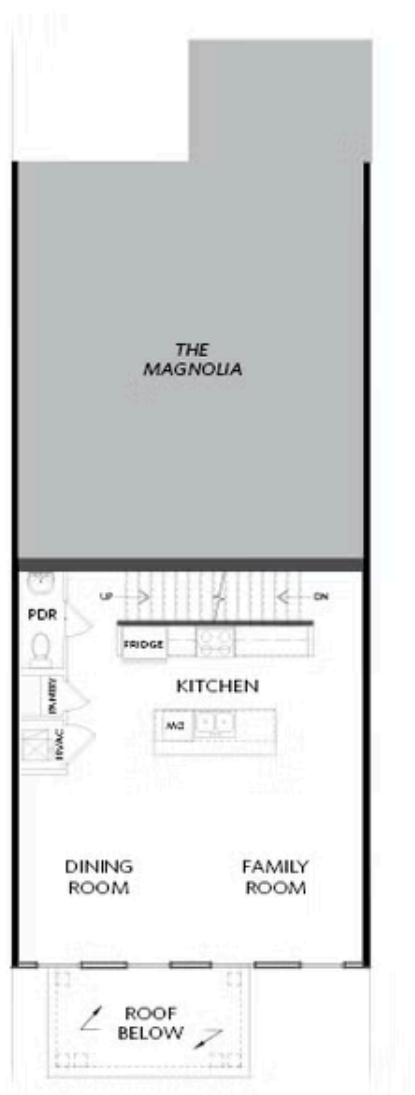

## SECOND FLOOR

Elevations 1 & 1A Floor Plan Layout

Want to Know More  
About This Home?

CONTACT OUR COMMUNITY SALES MANAGER  
Call Us @ 678.372.1644

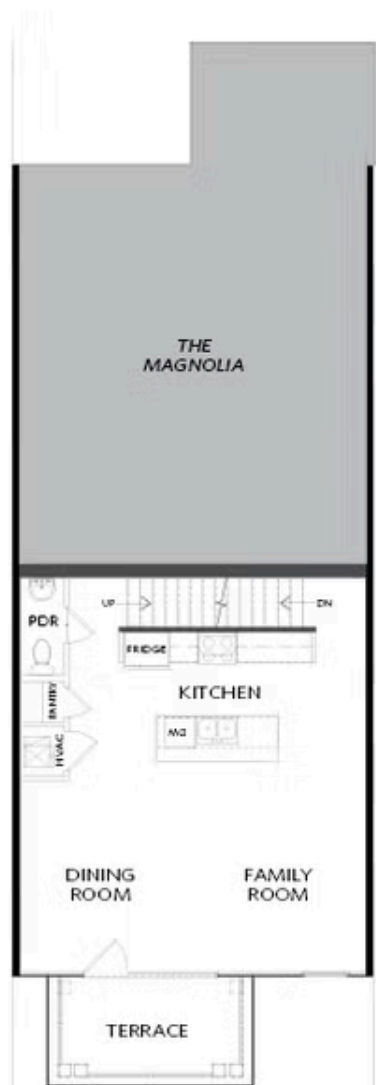

SECOND FLOOR

Elevations 1 & 1A Floor Plan Layout

Want to Know More  
About This Home?

CONTACT OUR COMMUNITY SALES MANAGER  
Call Us @ 678.372.1644

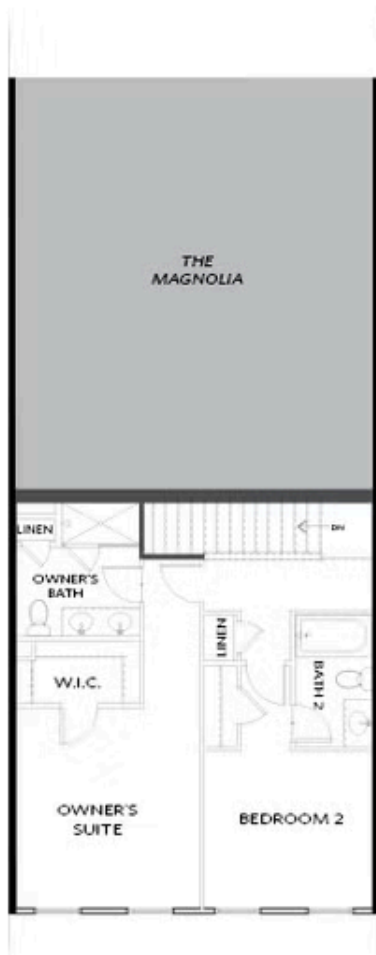

THIRD FLOOR

Elevations 1 & 1A Floor Plan Layout

Want to Know More  
About This Home?

CONTACT OUR COMMUNITY SALES MANAGER  
Call Us @ 678.372.1644