



PRICED AT
\$414,900

 1373 Sq Ft

 2 Beds

 2.5 Baths

 1 Car Garage

 3.0 Story

Your Home, Your Way with LOW 30 YEAR FIXED RATES: 4.875% FHA or 5.25% Conventional with Preferred Lender, Capital City Home Loans PLUS Move In Ready Package (Refrigerator, Blinds - GE Profile Combo Washer/Dryer already included). Ends August 31, 2025. Welcome to Market Square at Sawnee Village Discover the perfect blend of style, convenience, and value in the heart of Cumming, GA. Market Square at Sawnee Village places you just steps from local shops, dining, and entertainment, offering an urban lifestyle in a vibrant suburban setting. Whether you're a first-time buyer or looking to right-size, this community delivers a lifestyle you'll love. The Magnolia Plan - Modern Comfort Meets Timeless Design This 3-story stacked townhome with condominium ownership features 2 bedrooms, 2.5 bathrooms, and 1,373 sq. ft., curated with The Providence Group's Cool Linen Design Collection for a fresh, contemporary look. Terrace Level: Inviting foyer entry with a conveniently located laundry area. Main Level: Enjoy an open-concept layout connecting the family room, dining area, and chef-inspired kitchen with 42" cabinets, quartz countertops, stainless steel GE appliances, tile backsplash, and a spacious island. Natural light flows throughout, leading to a private deck—ideal for morning coffee or evening gatherings. Third Level: Relax ...

**Want to Know More
About This Home?**

CONTACT OUR COMMUNITY SALES MANAGER
Call Us @ 678.372.1644

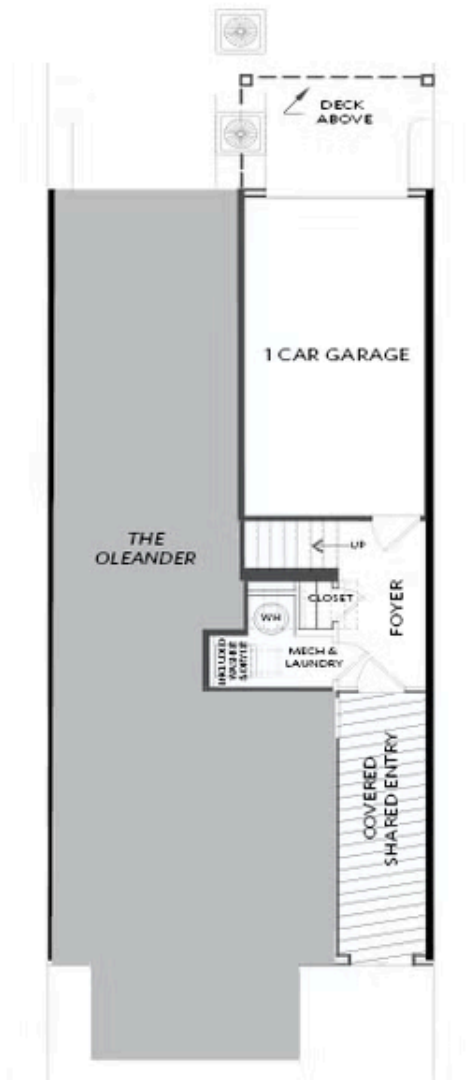

FIRST FLOOR

Elevations 1 & 1A Floor Plan Layout

Want to Know More
About This Home?

CONTACT OUR COMMUNITY SALES MANAGER
Call Us @ 678.372.1644



SECOND FLOOR

Elevations 1 & 1A Floor Plan Layout

Want to Know More
About This Home?

CONTACT OUR COMMUNITY SALES MANAGER
Call Us @ 678.372.1644

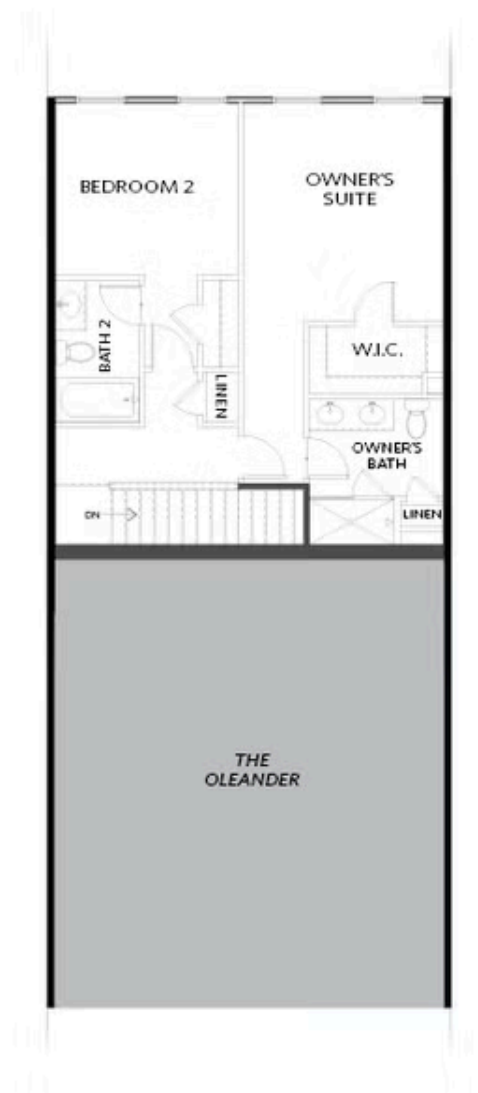

THIRD FLOOR

Elevations 1 & 1A Floor Plan Layout

Want to Know More
About This Home?

CONTACT OUR COMMUNITY SALES MANAGER
Call Us @ 678.372.1644