







PRICED AT
\$363,520

-  1373 Sq Ft
-  2 Beds
-  2.5 Baths
-  1 Car Garage
-  3.0 Story

Season of Savings here at Market Square with an additional \$2,500 Towards Closing Cost + GE French Door Refrigerator & Blinds! Turn Key Home - Discover the Magnolia Plan built by The Providence Group. Move In Ready. This 3-story stacked townhome with condominium ownership features 2 bedrooms, 2.5 bathrooms, and 1,373 sq. ft., curated with The Providence Group's Cool Linen Design Collection for a fresh, contemporary look. Terrace Level: Inviting foyer entry with a conveniently located laundry area. Main Level: Enjoy an open-concept layout connecting the family room, dining area, and chef-inspired kitchen with 42" cabinets, quartz countertops, stainless steel GE appliances, tile backsplash, and a spacious island. Natural light flows throughout, leading to a private deck—ideal for morning coffee or evening gatherings. Third Level: Relax in the Primary Suite with a walk-in closet and spa-inspired bath featuring dual vanities and a walk-in shower. A secondary bedroom with private bath provides comfort and flexibility. More Than a Home—A Lifestyle. With Forsyth County's top-ranked schools, future shops and restaurants at your doorstep, and walkability to the Cumming City Center, Market Square offers unmatched convenience.

**Want to Know More
About This Home?**

CONTACT OUR COMMUNITY SALES MANAGER
Call Us @ 678.372.1644

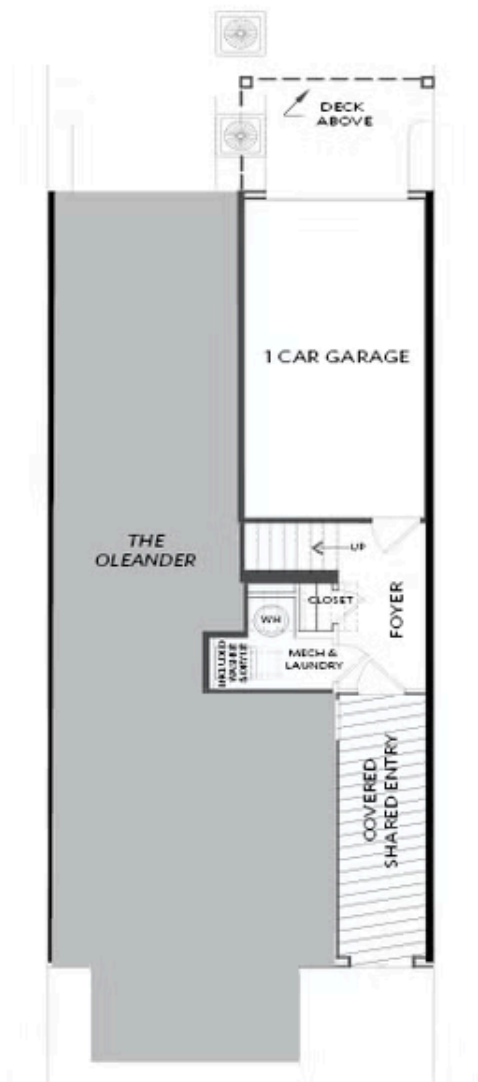

FIRST FLOOR

Elevations 1 & 1A Floor Plan Layout

Want to Know More
About This Home?

CONTACT OUR COMMUNITY SALES MANAGER
Call Us @ 678.372.1644

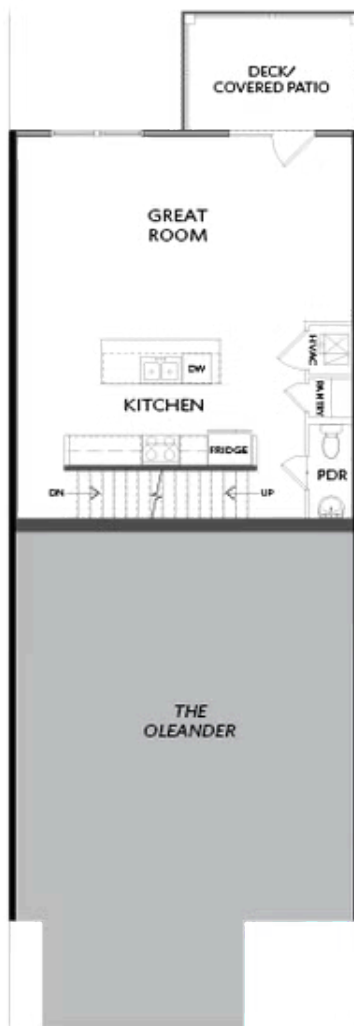

SECOND FLOOR

Elevations 1 & 1A Floor Plan Layout

Want to Know More
About This Home?

CONTACT OUR COMMUNITY SALES MANAGER
Call Us @ 678.372.1644



THIRD FLOOR

Elevations 1 & 1A Floor Plan Layout

Want to Know More
About This Home?

CONTACT OUR COMMUNITY SALES MANAGER
Call Us @ 678.372.1644