





PRICED AT
\$513,400

-  1703 Sq Ft
-  3 Beds
-  3.5 Baths
-  1 Car Garage
-  3.0 Story

Kick off this Fall with your dream home — Up to \$40K off with closings by November! Experience low-maintenance urban living in the heart of Cumming, GA—just steps from shopping, dining, and entertainment in the vibrant Market Square District. Whether you're a first-time homebuyer or looking to right-size, this community offers modern comfort and convenience in a walkable location. This 3-story Oleander plan features 3 bedrooms, 3.5 bathrooms, and 1,703 sq ft of thoughtfully designed living space with Condominium Ownership. Showcasing The Providence Group's Warm Stone Design Collection, this luxury Homesite is apart of a limited selection of homes that feature a deck off the Main Level Living. With premium finishes including Light Gray cabinets, Alto quartz countertops, and Piedmont Hickory hardwood flooring throughout the main living level & Hallways. The terrace level includes a private bedroom with full ensuite—perfect for guests, a home office, or personal gym. On the main level, enjoy an open-concept layout with a spacious family room, dining area, and a chef-inspired kitchen featuring 42" cabinetry, stainless GE appliances, tile backsplash, and modern lighting. Upstairs, the Primary Suite includes a large walk-in closet and spa-like bath with double vanities and a walk-in shower. A secondary bedroom ...

**Want to Know More
About This Home?**

CONTACT OUR COMMUNITY SALES MANAGER
Call Us @ 678.372.1644

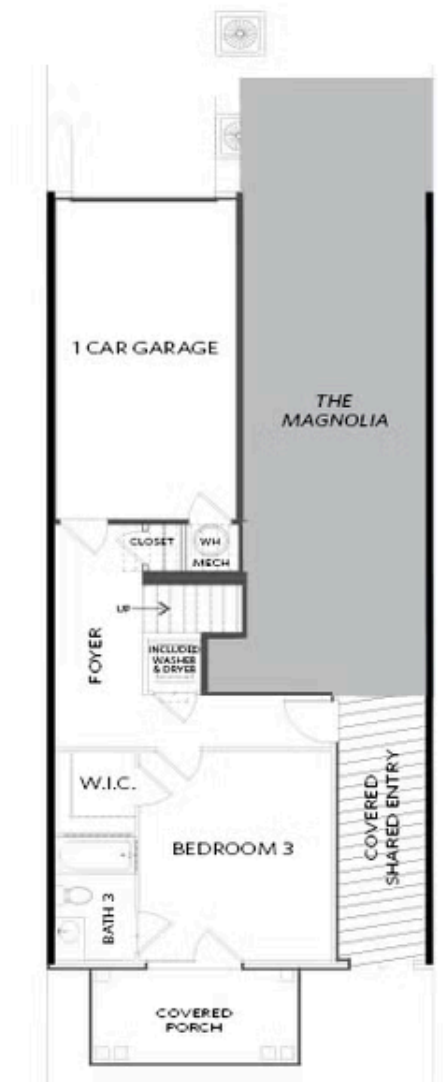

FIRST FLOOR

Elevations 1 & 1A Floor Plan Layout

Want to Know More
About This Home?

CONTACT OUR COMMUNITY SALES MANAGER
Call Us @ 678.372.1644

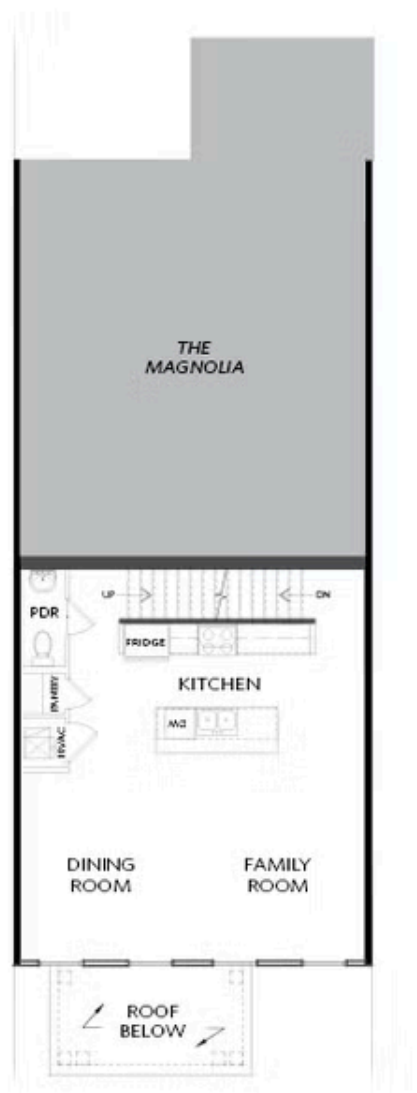

SECOND FLOOR

Elevations 1 & 1A Floor Plan Layout

Want to Know More
About This Home?

CONTACT OUR COMMUNITY SALES MANAGER
Call Us @ 678.372.1644



SECOND FLOOR

Elevations 1 & 1A Floor Plan Layout

Want to Know More
About This Home?

CONTACT OUR COMMUNITY SALES MANAGER
Call Us @ 678.372.1644

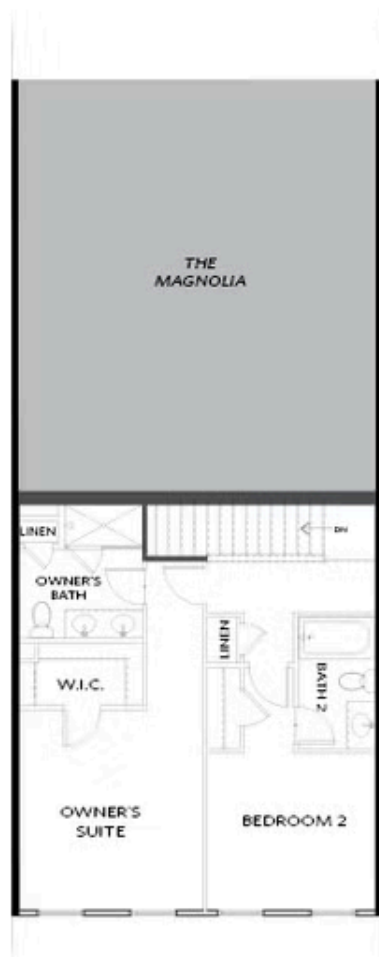

THIRD FLOOR

Elevations 1 & 1A Floor Plan Layout

Want to Know More
About This Home?

CONTACT OUR COMMUNITY SALES MANAGER
Call Us @ 678.372.1644