







PRICED AT
\$394,900

-  1373 Sq Ft
-  2 Beds
-  2.5 Baths
-  1 Car Garage
-  3.0 Story

Discover the Magnolia Plan built by The Providence Group. Quick Move-In Opportunity! Experience elevated living in the heart of the vibrant Market Square District at Sawnee Village, where shopping, dining, and entertainment are all just outside your door. Perfect for first-time buyers, professionals, or those looking to simplify without sacrificing style, Market Square delivers a low-maintenance lifestyle in an unbeatable location in Cumming. Homesite D9 features the Magnolia Plan with The Providence Group's stunning Cool Linen Design Collection, blending soft contemporary finishes with timeless sophistication. This thoughtfully designed 3-story stacked townhome with condominium ownership offers 2 bedrooms, 2.5 bathrooms, and approximately 1,373 sq. ft. of beautifully curated living space. The terrace level welcomes you with a private foyer entry and convenient laundry room. Upstairs, the open-concept main living area is designed for effortless entertaining, featuring a spacious family room, dining area, and chef-inspired kitchen complete with 42" cabinetry, quartz countertops, stainless-steel GE appliances, tile backsplash, and designer lighting selections. A covered porch extends the living space outdoors, creating the perfect spot to unwind. Retreat to the upper level where the spacious Owner's Suite includes a large walk-in closet and spa-like bath with double vanities and modern finishes. An additional secondary ...

**Want to Know More
About This Home?**

CONTACT OUR COMMUNITY SALES MANAGER
Call Us @ 678.372.1644



FIRST FLOOR

Elevations 1 & 1A Floor Plan Layout

Want to Know More
About This Home?

CONTACT OUR COMMUNITY SALES MANAGER
Call Us @ 678.372.1644

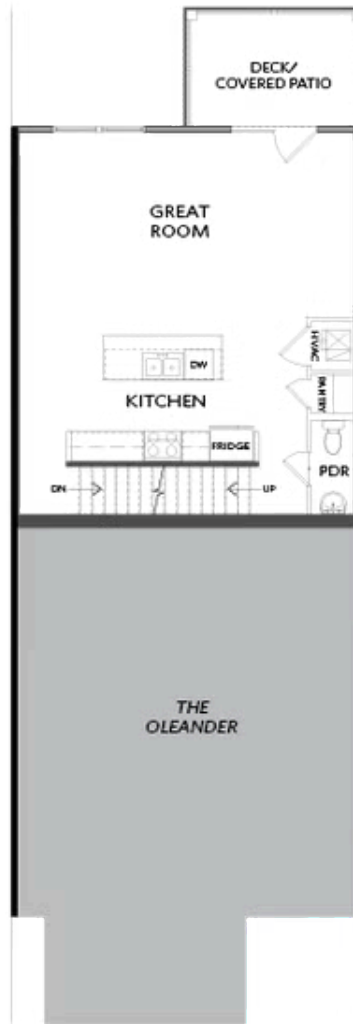

SECOND FLOOR

Elevations 1 & 1A Floor Plan Layout

Want to Know More
About This Home?

CONTACT OUR COMMUNITY SALES MANAGER
Call Us @ 678.372.1644

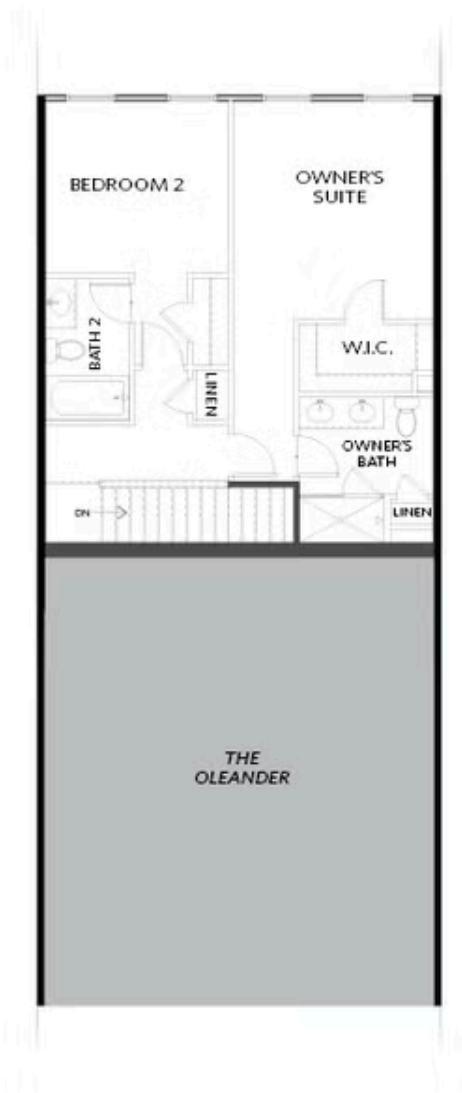

THIRD FLOOR

Elevations 1 & 1A Floor Plan Layout

**Want to Know More
About This Home?**

CONTACT OUR COMMUNITY SALES MANAGER
Call Us @ 678.372.1644