

PRICED AT  
**\$434,900**

 1373 Sq Ft

 2 Beds

 2.5 Baths

 1 Car Garage

 3.0 Story

Your Home, Your Way with LOW 30 YEAR FIXED RATES: 4.875% FHA or 5.25% Conventional with Preferred Lender, Capital City Home Loans PLUS Move In Ready Package (Refrigerator, Blinds - GE Profile Combo Washer/Dryer already included). Investor? No problem! Come visit us & learn about your opportunities! Ends August 31, 2025. Welcome to Market Square at Sawnee Village—where vibrant living meets everyday convenience. Located in the heart of Cumming, GA, this walkable community places an eclectic mix of shops and dining just steps from your front door. Perfect for first-time buyers or those looking to right-size, Market Square offers stylish homes designed for modern living. The Magnolia Plan - Sophisticated & Functional This 3-story stacked townhome with condominium ownership offers 2 bedrooms, 2.5 bathrooms, and 1,373 sq. ft., thoughtfully designed with The Providence Group's Warm Linen Design Collection for a contemporary, inviting feel. Terrace Level: Entry foyer with convenient laundry space for added functionality. Main Level: Open-concept living connects the family room, dining area, and chef-inspired kitchen featuring 42" cabinets, quartz countertops, a spacious island, stainless-steel GE appliances, tile backsplash, and designer lighting. The sun-filled dining area opens to an expansive covered deck, perfect for relaxing or entertaining. Third Level: ...

Want to Know More  
About This Home?

CONTACT OUR COMMUNITY SALES MANAGER  
Call Us @ 678.372.1644

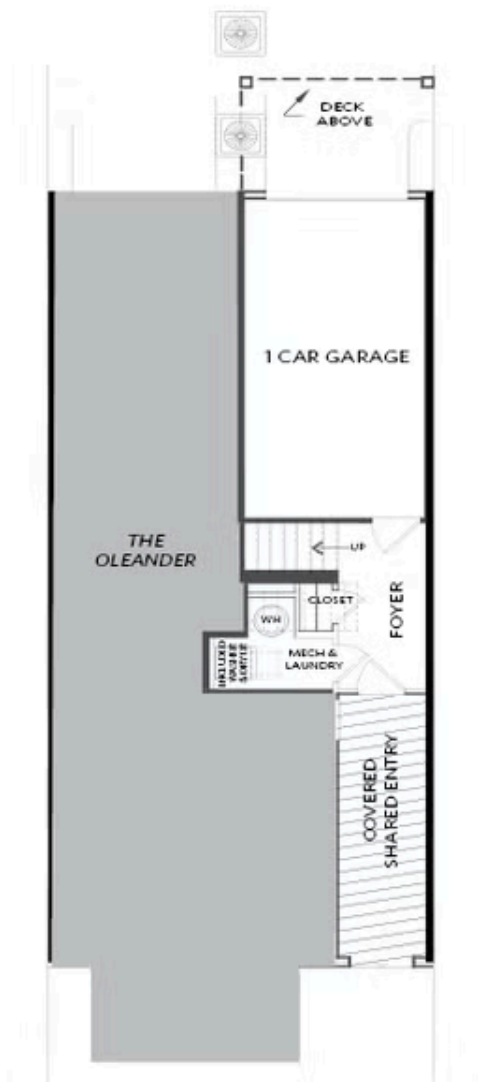

FIRST FLOOR

Elevations 1 & 1A Floor Plan Layout

Want to Know More  
About This Home?

CONTACT OUR COMMUNITY SALES MANAGER  
Call Us @ 678.372.1644



SECOND FLOOR

Elevations 1 & 1A Floor Plan Layout

Want to Know More  
About This Home?

CONTACT OUR COMMUNITY SALES MANAGER  
Call Us @ 678.372.1644



THIRD FLOOR

Elevations 1 & 1A Floor Plan Layout

Want to Know More  
About This Home?

CONTACT OUR COMMUNITY SALES MANAGER  
Call Us @ 678.372.1644