





PRICED AT  
**\$468,900**

-  1703 Sq Ft
-  3 Beds
-  3.5 Baths
-  1 Car Garage
-  3.0 Story

Kick off the New Year at Market Square! Discover the Oleander Plan built by The Providence Group. Move In Ready. Low-maintenance urban living in the heart of Cumming, GA—just steps from shopping, dining, and entertainment in the vibrant Market Square District. Whether you're a first-time homebuyer or looking to right-size, this community offers modern comfort and convenience. This 3-story Oleander plan features 3 bedrooms, 3.5 bathrooms, and 1,703 sq ft of thoughtfully designed living space with Condominium Ownership. Showcasing The Providence Group's Warm Wheat Design Collection, this end unit impresses with stylish finishes throughout. The terrace level includes a private bedroom with full ensuite—perfect for guests, a home office, or personal gym. The main level offers an open-concept layout with a spacious family room, dining area, and chef-inspired kitchen featuring 42" cabinetry, quartz countertops, stainless GE appliances, tile backsplash, and modern lighting. Upstairs, the Primary Suite includes a large walk-in closet and spa-like bath with double vanities and walk-in shower. A secondary bedroom with a private bath completes the top floor. Market Square at Sawnee Village is more than a home—it's a lifestyle. Enjoy walkable access to the Cumming City Center, with future retail and dining planned at the community ...

Want to Know More  
About This Home?

CONTACT OUR COMMUNITY SALES MANAGER  
Call Us @ 678.372.1644

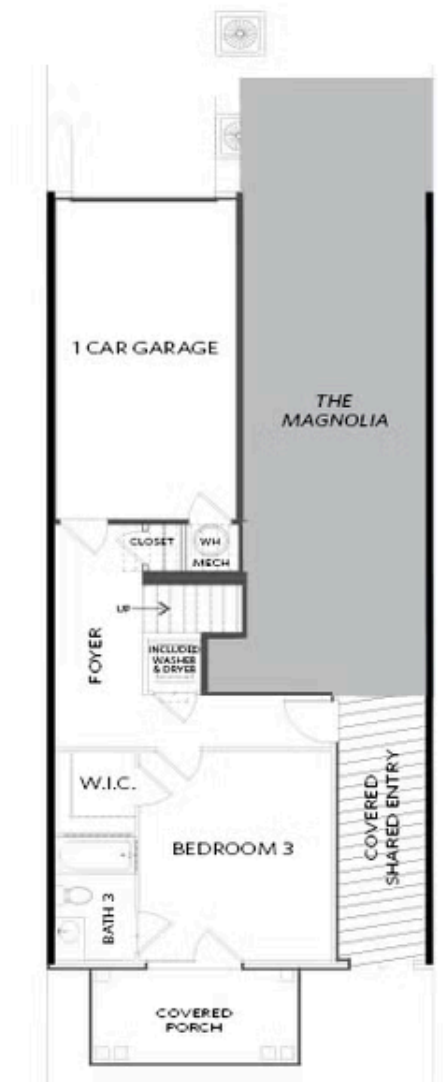

FIRST FLOOR

Elevations 1 & 1A Floor Plan Layout

Want to Know More  
About This Home?

CONTACT OUR COMMUNITY SALES MANAGER  
Call Us @ 678.372.1644

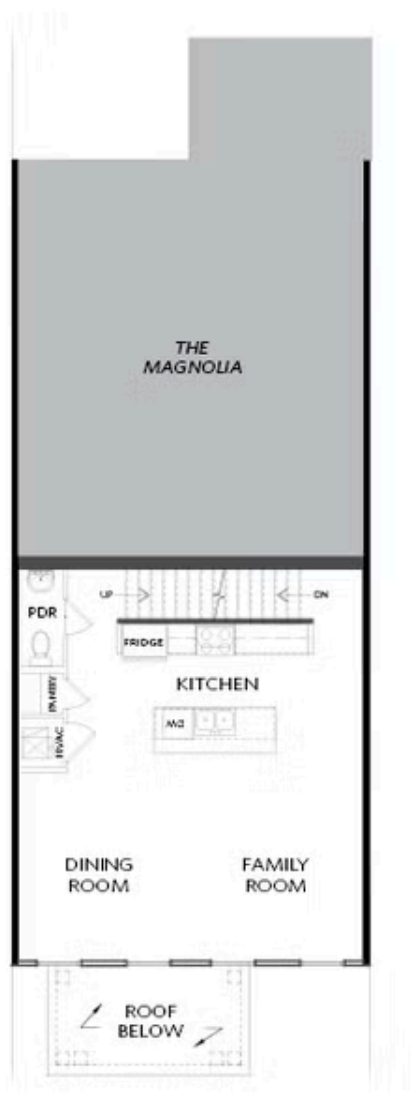

SECOND FLOOR

Elevations 1 & 1A Floor Plan Layout

Want to Know More  
About This Home?

CONTACT OUR COMMUNITY SALES MANAGER  
Call Us @ 678.372.1644



SECOND FLOOR

Elevations 1 & 1A Floor Plan Layout

Want to Know More  
About This Home?

CONTACT OUR COMMUNITY SALES MANAGER  
Call Us @ 678.372.1644

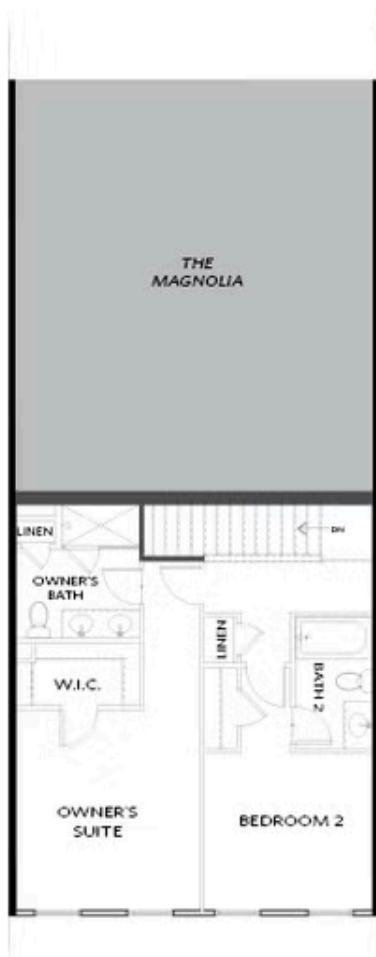

THIRD FLOOR

Elevations 1 & 1A Floor Plan Layout

Want to Know More  
About This Home?

CONTACT OUR COMMUNITY SALES MANAGER  
Call Us @ 678.372.1644