







PRICED AT  
**\$409,900**

-  1703 Sq Ft
-  3 Beds
-  3.5 Baths
-  1 Car Garage
-  3.0 Story

Elevate Your Savings at Market Square with our Home of the Month! Discover the Oleander Plan built by The Providence Group. Quick Move In! This 3-story Oleander plan features 3 bedrooms, 3.5 bathrooms, and 1,703 sq ft of thoughtfully designed living space. Showcasing The Providence Group's Warm Wheat Design Collection, this luxury Homesite is apart of a limited selection of homes that feature a deck off the Main Level Living. With premium finishes including Alabaster Soft Close cabinets + Almond island, quartz countertops, and light oak flooring throughout the main living level & Hallways. Terrace Level: Guest enter from the front door into a foyer with an oversized bedroom, walk in closet and full bathroom. This space also includes a covered patio making this a dreamy guest room, office space or workout room. Additional Laundry with our 2 in 1 GE Profile Washer/Dryer is already Our 1 car garage already includes an EV Charger. On the main level, enjoy an open-concept layout with a spacious family room, dining area, and a chef-inspired kitchen featuring 42" cabinetry, stainless GE appliances, tile backsplash, and modern lighting. Upstairs, the Primary Suite includes a large walk-in closet and spa-like bath with double vanities and ...

**Want to Know More  
About This Home?**

CONTACT OUR COMMUNITY SALES MANAGER  
Call Us @ 678.372.1644



FIRST FLOOR

Elevations 1 & 1A Floor Plan Layout

Want to Know More  
About This Home?

CONTACT OUR COMMUNITY SALES MANAGER  
Call Us @ 678.372.1644

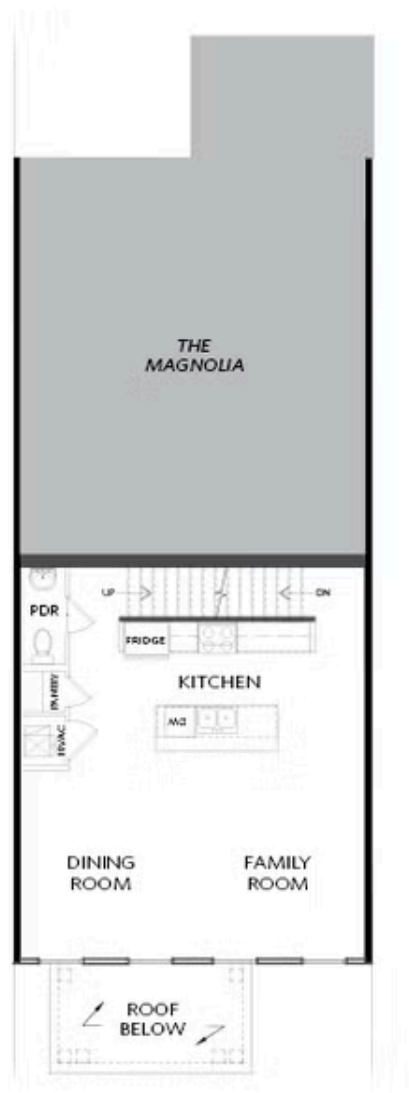

SECOND FLOOR

Elevations 1 & 1A Floor Plan Layout

Want to Know More  
About This Home?

CONTACT OUR COMMUNITY SALES MANAGER  
Call Us @ 678.372.1644

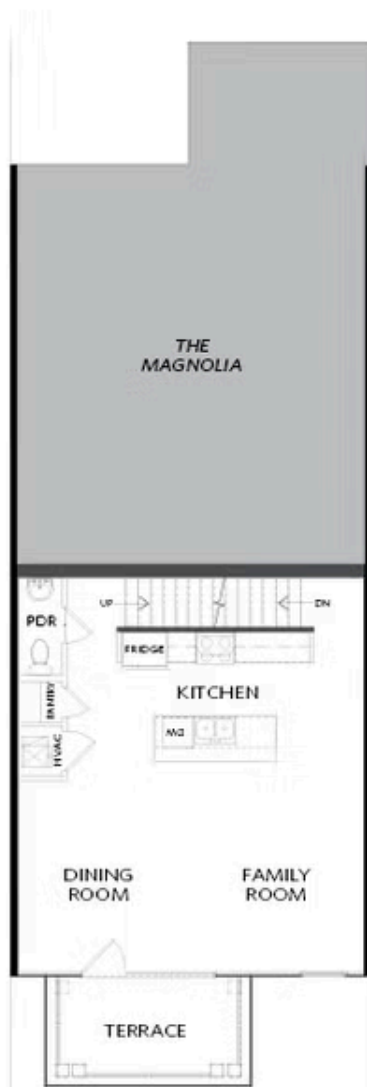

SECOND FLOOR

Elevations 1 & 1A Floor Plan Layout

Want to Know More  
About This Home?

CONTACT OUR COMMUNITY SALES MANAGER  
Call Us @ 678.372.1644

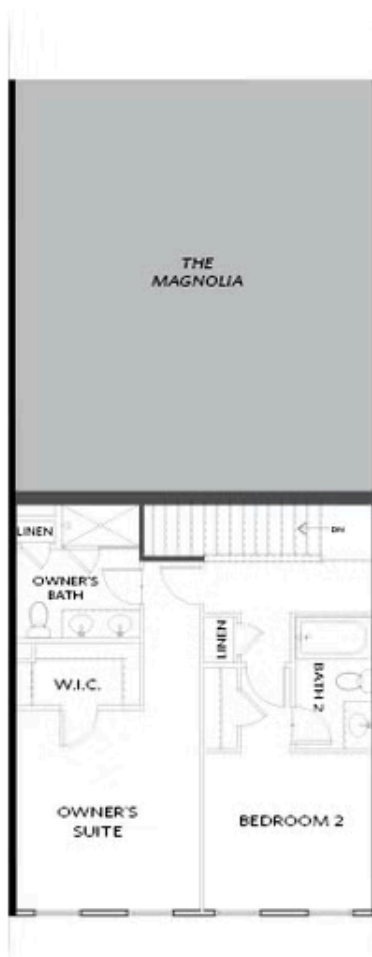

THIRD FLOOR

Elevations 1 & 1A Floor Plan Layout

Want to Know More  
About This Home?

CONTACT OUR COMMUNITY SALES MANAGER  
Call Us @ 678.372.1644