



PRICED AT  
**\$485,900**

 **1703 Sq Ft**

 **3 Beds**

 **3.5 Baths**

 **1 Car Garage**

 **3.0 Story**

**New Year, New Home, New You! \$15,000 Towards Closing Cost for Contracts written in February when financing is completed with Preferred Lender, Capital City Home Loans PLUS Move In Package: GE Refrigerator & Blinds throughout home for contracts written in February! \*Homes already include GE Profile 2 in 1 Washer Dryer! \* Welcome to Market Square at Sawnee Village Discover the perfect balance of urban excitement and suburban comfort in this vibrant community located in the heart of Cumming, GA. Situated in the lively Market Square District, you'll be steps away from an array of retail and dining options, blending convenience and adventure for a truly dynamic lifestyle. The Oleander Plan: A Modern 3 Story Stacked Townhome with Condominium Ownership. Designed with sophistication and functionality in mind, this townhome embraces The Providence Group's Cool Linen Design Collection and spans three impressive levels: Terrace Level: A private bedroom with an ensuite bath awaits—ideal for hosting guests, setting up your home office, or creating a personal fitness retreat. Main Level: Entertain with ease in the open-concept layout featuring a family room, dining area, and a chef-inspired kitchen. The kitchen boasts 42" cabinetry, quartz countertops, stainless-steel GE appliances, a sleek tile backsplash, and ...**

Want to Know More  
About This Home?

CONTACT OUR COMMUNITY SALES MANAGER  
Call Us @ 678.372.1644



FIRST FLOOR

Elevations 1 & 1A Floor Plan Layout

Want to Know More  
About This Home?

CONTACT OUR COMMUNITY SALES MANAGER  
Call Us @ 678.372.1644

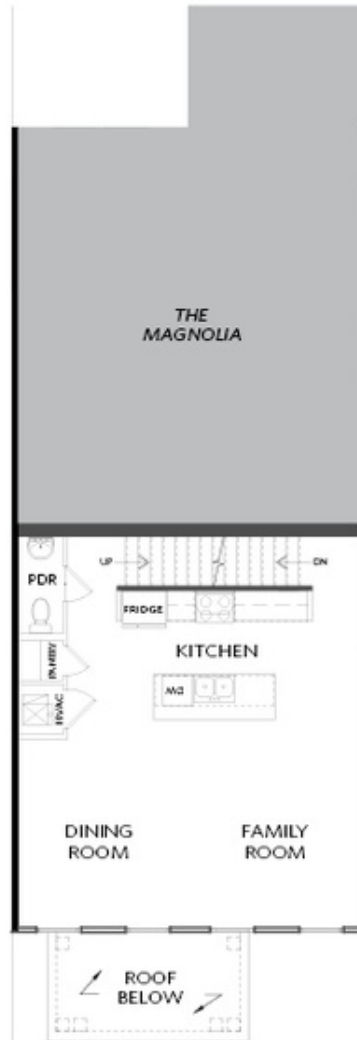

SECOND FLOOR

Elevations 1 & 1A Floor Plan Layout

Want to Know More  
About This Home?

CONTACT OUR COMMUNITY SALES MANAGER  
Call Us @ 678.372.1644

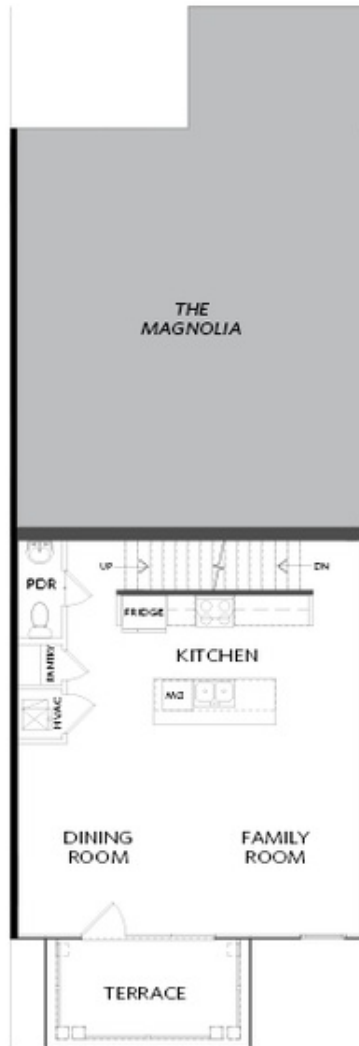

**SECOND FLOOR**

Elevations 1 & 1A Floor Plan Layout

**Want to Know More  
About This Home?**

**CONTACT OUR COMMUNITY SALES MANAGER**  
**Call Us @ 678.372.1644**

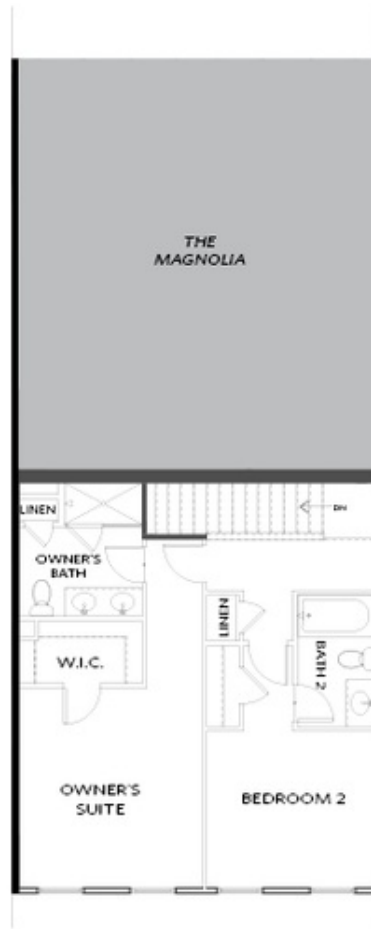

THIRD FLOOR

Elevations 1 & 1A Floor Plan Layout

Want to Know More  
About This Home?

CONTACT OUR COMMUNITY SALES MANAGER  
Call Us @ 678.372.1644