







PRICED AT
\$524,950

-  1903 Sq Ft
-  3 Beds
-  3.5 Baths
-  2 Car Garage
-  3.0 Story

Sizzling Summer Savings - Experience urban living at its finest in the bustling Market Square District of Sawnee Village. Enjoy the convenience of having an array of retail and dining options right at your fingertips. Market Square caters to both first-time homebuyers and those looking for high-quality downsizing options, ensuring there's something for everyone. Located in Cumming, GA, this community boasts stylish townhomes tailored to your needs. This end unit, Glendale Plan showcases The Providence Groups' Warm Wheat Design Collection, spanning three levels with 3 bedrooms and 3.5 bathrooms across 1903 sq. ft. The terrace level features a luxurious ensuite bedroom, perfect for guests, a home office, or gym. The main level seamlessly integrates the family room, dining area, and chef-style kitchen with 42" cabinets and quartz countertops. Stainless-steel GE appliances, a tile backsplash, and modern lighting complete the kitchen. Upstairs, the third level hosts a spacious Primary Suite with a walk-in closet and contemporary double-vanity bathroom, with separate tub and shower, and a linen closet. Additionally, there's another bedroom with a private bathroom and a convenient laundry room. Market Square isn't just a place to live; it's a lifestyle—a fusion of thoughtful design and convenience. This home is expected ...

**Want to Know More
About This Home?**

CONTACT OUR COMMUNITY SALES MANAGER
Call Us @ 678.372.1644



TERRACE

Elevations B & C Floor Plan Layout

Want to Know More
About This Home?

CONTACT OUR COMMUNITY SALES MANAGER
Call Us @ 678.372.1644



TERRACE

Elevations B & C Floor Plan Layout

Want to Know More
About This Home?

CONTACT OUR COMMUNITY SALES MANAGER
Call Us @ 678.372.1644



Elevations B & C Floor Plan Layout

Want to Know More
About This Home?

CONTACT OUR COMMUNITY SALES MANAGER
Call Us @ 678.372.1644

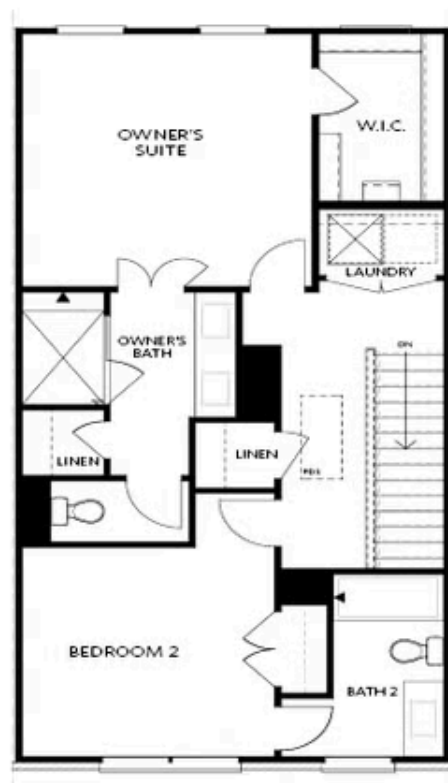

SECOND FLOOR

Elevations B & C Floor Plan Layout

Want to Know More
About This Home?

CONTACT OUR COMMUNITY SALES MANAGER
Call Us @ 678.372.1644

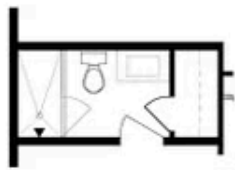

OPT Bath 3 Shower & Tub/Shower Combo

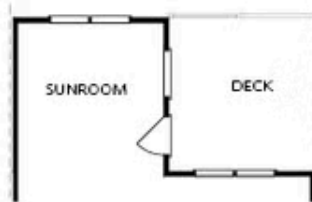

OPT Sunroom & Full Deck



OPT Owner's Walk-Through Shower

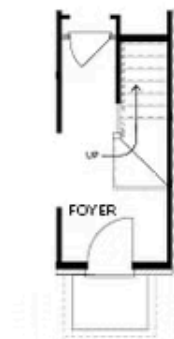

OPT Stair Landing on Terrace



OPT Fireplace



OPT Linear Fireplace



OPT Owner's Shower & Tub Combo

OPTIONS

Want to Know More
About This Home?

CONTACT OUR COMMUNITY SALES MANAGER
Call Us @ 678.372.1644

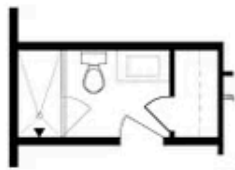

OPT Bath 3 Shower & Tub/Shower Combo

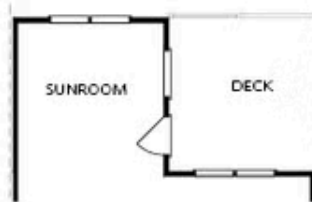

OPT Sunroom & Full Deck



OPT Owner's Walk-Through Shower

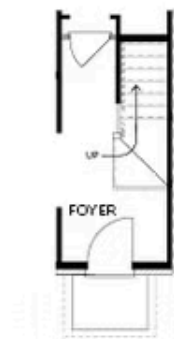

OPT Stair Landing on Terrace



OPT Fireplace



OPT Linear Fireplace



OPT Owner's Shower & Tub Combo

OPTIONS

Want to Know More
About This Home?

CONTACT OUR COMMUNITY SALES MANAGER
Call Us @ 678.372.1644