



PRICED AT
\$447,900

 **1373 Sq Ft**

 **2 Beds**

 **2.5 Baths**

 **1 Car Garage**

 **3.0 Story**

\$20,000 Towards Closing Cost for Contracts written this month when financing is completed with Preferred Lender, Capital City Home Loans PLUS Move In Package: GE Refrigerator & Blinds throughout home for contracts written in February! *Homes already include GE Profile 2 in 1 Washer Dryer! * Discover urban living right at your doorstep in the vibrant Market Square District of Sawnee Village. With a mix of retail and dining options just steps away, convenience and excitement abound. Whether you're a first-time homebuyer or seeking quality downsizing, Market Square offers something for everyone. Nestled in Cumming, GA, this community features stylish 3 Story Stacked Townhome with Condominium Ownership designed with you in mind. This Magnolia Plan hosts The Providence Groups' Warm Stone Design Collection. The plan spans 3 levels, boasting 2 bedrooms and 2.5 bathrooms across 1373 sq. ft. On the terrace level, find a gracious foyer and laundry room. The main level seamlessly combines the family room, dining area, chef-style kitchen with 42" cabinets and quartz countertops, and a covered porch. Stainless-steel GE appliances, a tile backsplash, and a modern lighting package complete this dreamy kitchen. On the third level, you'll find a spacious Primary Suite boasting a walk-in closet ...

**Want to Know More
About This Home?**

CONTACT OUR COMMUNITY SALES MANAGER
Call Us @ 678.372.1644



FIRST FLOOR

Elevations 1 & 1A Floor Plan Layout

Want to Know More
About This Home?

CONTACT OUR COMMUNITY SALES MANAGER
Call Us @ 678.372.1644

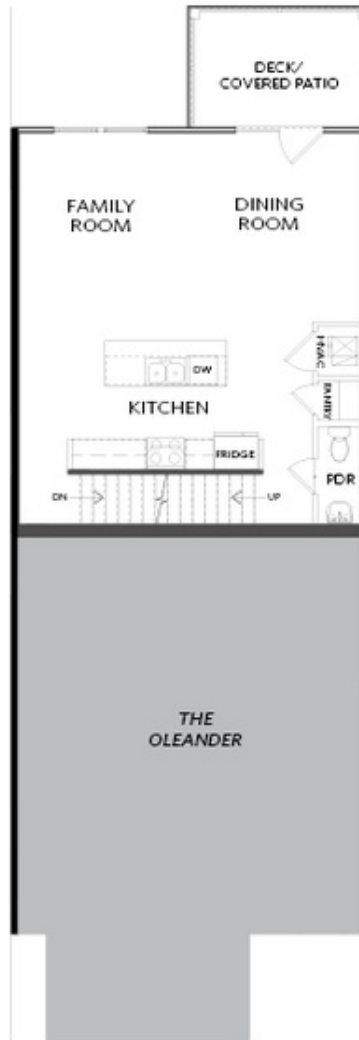

SECOND FLOOR

Elevations 1 & 1A Floor Plan Layout

Want to Know More
About This Home?

CONTACT OUR COMMUNITY SALES MANAGER
Call Us @ 678.372.1644



THIRD FLOOR

Elevations 1 & 1A Floor Plan Layout

Want to Know More
About This Home?

CONTACT OUR COMMUNITY SALES MANAGER
Call Us @ 678.372.1644