



PRICED AT
\$431,620

 1373 Sq Ft

 2 Beds

 2.5 Baths

 1 Car Garage

 3.0 Story

Quick Move In Home with \$35K ANYWAY OR 4.875% FIXED RATE (LIMITED OPPORTUNITY) with Preferred Lender, Capital City Home Loans + Move In Ready Package (Refrigerator, Blinds - GE Profile Combo Washer/Dryer already included). Discover urban living right at your doorstep in the vibrant Market Square District of Sawnee Village. With a mix of retail and dining options just steps away, convenience and excitement abound. Whether you're a first-time homebuyer or seeking quality downsizing, Market Square offers something for everyone. Nestled in Cumming, GA, this community features stylish 3 Story Stacked Townhome with Condominium Ownership designed with you in mind. This Magnolia Plan hosts The Providence Groups' Warm Stone Design Collection. The plan spans 3 levels, boasting 2 bedrooms and 2.5 bathrooms across 1373 sq. ft. On the terrace level, find a gracious foyer and laundry room. The main level seamlessly combines the family room, dining area, chef-style kitchen with 42" cabinets and quartz countertops, and a covered porch. Stainless-steel GE appliances, a tile backsplash, and a modern lighting package complete this dreamy kitchen. On the third level, you'll find a spacious Primary Suite boasting a walk-in closet and a contemporary double-vanity bathroom. Additionally, there's an extra bedroom with its ...

**Want to Know More
About This Home?**

CONTACT OUR COMMUNITY SALES MANAGER
Call Us @ 678.372.1644

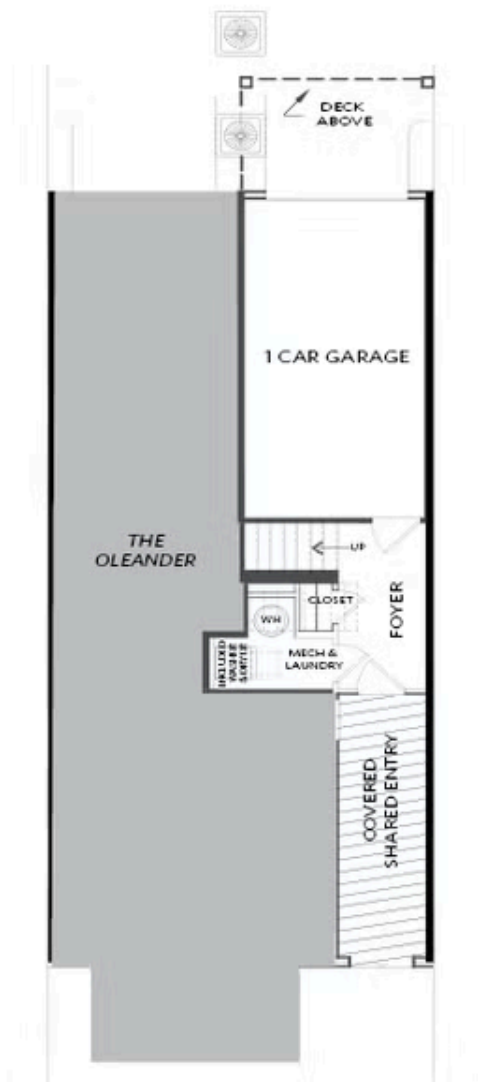

FIRST FLOOR

Elevations 1 & 1A Floor Plan Layout

Want to Know More
About This Home?

CONTACT OUR COMMUNITY SALES MANAGER
Call Us @ 678.372.1644

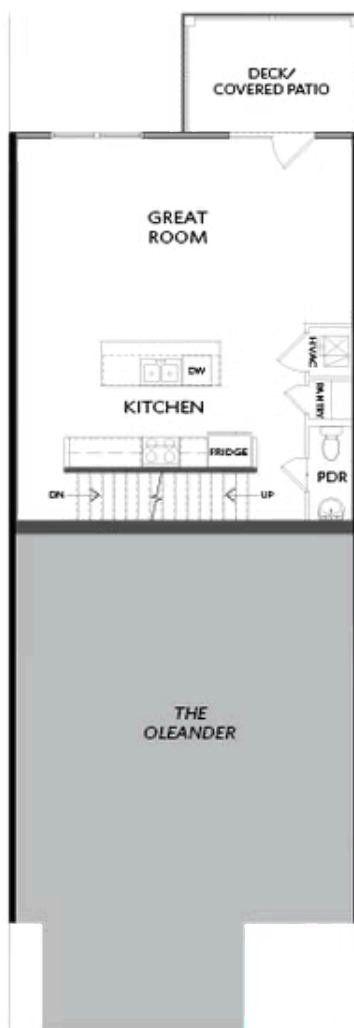

SECOND FLOOR

Elevations 1 & 1A Floor Plan Layout

Want to Know More
About This Home?

CONTACT OUR COMMUNITY SALES MANAGER
Call Us @ 678.372.1644

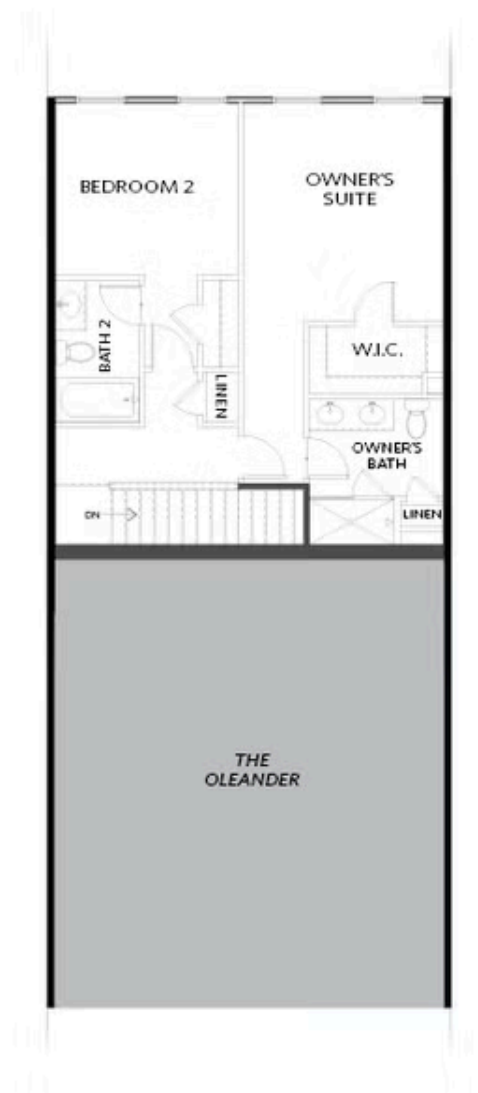

THIRD FLOOR

Elevations 1 & 1A Floor Plan Layout

Want to Know More
About This Home?

CONTACT OUR COMMUNITY SALES MANAGER
Call Us @ 678.372.1644