



PRICED AT  
**\$570,450**

 **1903 Sq Ft**

 **3 Beds**

 **3.5 Baths**

 **2 Car Garage**

 **3.0 Story**

**Fabulous Fall Savings - Immerse yourself in the vibrant rhythm of urban life within Sawnee Village's dynamic Market Square District. Just moments away from an enticing array of shops and dining spots, this neighborhood pulsates with convenience and energy. Market Square beckons both those embarking on their first home-buying journey and those in search of refined downsizing options. Tucked into the heart of Cumming, GA, this lively community showcases a diverse selection of chic townhomes tailored to fulfill your every desire. The Glendale Plan, adorned with The Providence Groups' sophisticated Warm Linen Design Collection, spans three levels, encompassing 3 bedrooms and 3.5 bathrooms within its generous 1903 sq. ft. Step into the terrace level, where a welcoming bedroom paired with a luxurious ensuite awaits—a versatile space perfect for guests, a home office, or your personal gym sanctuary. Ascend to the main floor, where an airy, open layout seamlessly integrates the family room and dining area with a chef-inspired kitchen boasting elegant 42" white cabinets and striking Calacatta Prado quartz countertops atop a grand island. Complete with stainless-steel GE appliances, a stylish tile backsplash, and contemporary lighting fixtures, this kitchen is a dream come true. Sunlight floods into the adjoining sunroom, ...**

**Want to Know More  
About This Home?**

**CONTACT OUR COMMUNITY SALES MANAGER**  
**Call Us @ 678.372.1644**



TERRACE

Elevations B & C Floor Plan Layout

Want to Know More  
About This Home?

CONTACT OUR COMMUNITY SALES MANAGER  
Call Us @ 678.372.1644



Elevations B & C Floor Plan Layout

Want to Know More  
About This Home?

CONTACT OUR COMMUNITY SALES MANAGER  
Call Us @ 678.372.1644



FIRST FLOOR

Elevations B & C Floor Plan Layout

Want to Know More  
About This Home?

CONTACT OUR COMMUNITY SALES MANAGER  
Call Us @ 678.372.1644

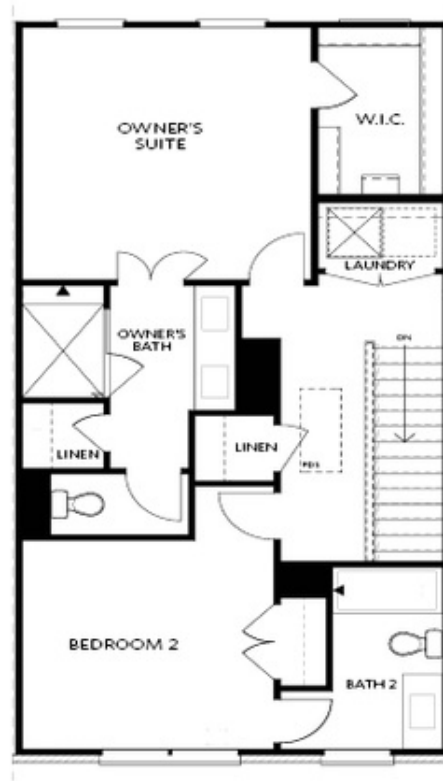

**SECOND FLOOR**

Elevations B & C Floor Plan Layout

**Want to Know More  
About This Home?**

**CONTACT OUR COMMUNITY SALES MANAGER**  
**Call Us @ 678.372.1644**

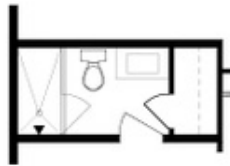

OPT Bath 3 Shower ilo  
 Tub/Shower Combo



OPT Sunroom ilo Full Deck



OPT Owner's  
 Walk-Through Shower

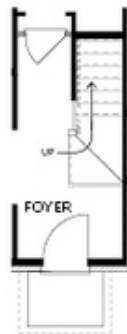

OPT Stair Landing  
 on Terrace



OPT Fireplace



OPT Linear Fireplace



OPT Owner's Shower &  
 Tub Combo

OPTIONS

Want to Know More  
 About This Home?

CONTACT OUR COMMUNITY SALES MANAGER  
 Call Us @ 678.372.1644

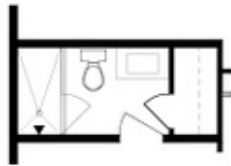

OPT Bath 3 Shower ilo  
 Tub/Shower Combo



OPT Sunroom ilo Full Deck



OPT Owner's  
 Walk-Through Shower

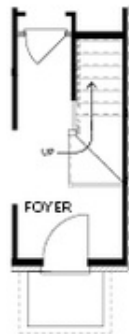

OPT Stair Landing  
 on Terrace



OPT Fireplace



OPT Linear Fireplace



OPT Owner's Shower &  
 Tub Combo

OPTIONS

Want to Know More  
 About This Home?

CONTACT OUR COMMUNITY SALES MANAGER  
 Call Us @ 678.372.1644