







PRICED AT
\$487,900

-  1703 Sq Ft
-  3 Beds
-  3.5 Baths
-  1 Car Garage
-  3.0 Story

Spring into a New Home with \$10K Anyway & \$5K towards Closing Cost with Preferred Lender, Capital City Home Loans PLUS Move In Ready Package (Refrigerator, Blinds - GE Profile Combo Washer/Dryer already included). Quick Move In! Welcome to Market Square at Sawnee Village- A Master Planned Community with Shoppes, Dining & Entertainment right at your entrance~ The Oleander Plan: 3 Bedroom, 3.5 Bath Stacked Townhome with Condominium Ownership. Designed with sophistication and functionality in mind, this 1,703 sq/ft townhome embraces The Providence Group's Cool Linen Design Collection and spans three impressive levels: Terrace Level: A private bedroom with full bathroom and private terrace patio—ideal for hosting guests, setting up your home office, or creating a personal fitness retreat. Enjoy oversized 1 car garage outfitted with EV Charger plus driveway for additional garage. Main Level: Entertain with ease in the open-concept layout featuring a family room, dining area, and a chef-inspired kitchen. The kitchen boasts 42" cabinetry, quartz countertops, stainless-steel GE appliances, a sleek tile backsplash, and designer lighting. Upper Level: Retreat to the Primary Suite with a walk-in closet and spa-like double-vanity bathroom, complete with a luxurious walk-in shower. A secondary bedroom with its private bathroom completes this level ...

**Want to Know More
About This Home?**

CONTACT OUR COMMUNITY SALES MANAGER
Call Us @ 678.372.1644

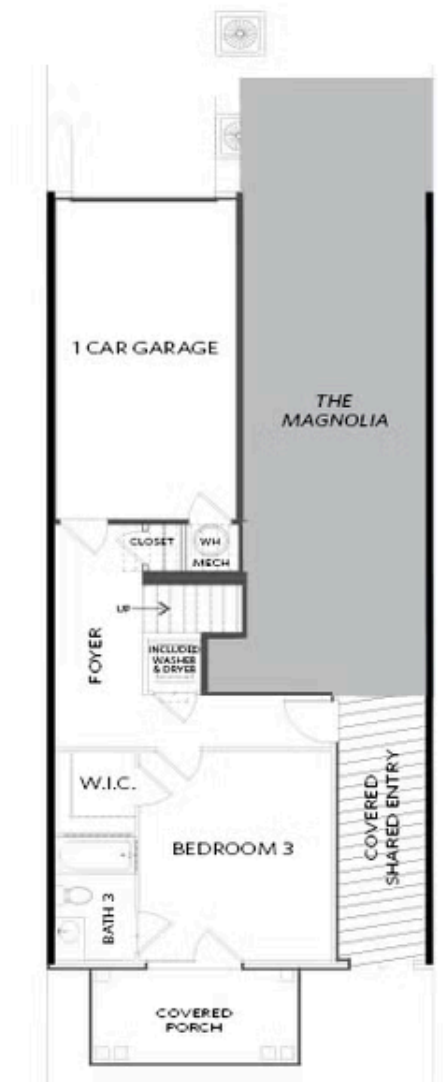

FIRST FLOOR

Elevations 1 & 1A Floor Plan Layout

Want to Know More
About This Home?

CONTACT OUR COMMUNITY SALES MANAGER
Call Us @ 678.372.1644

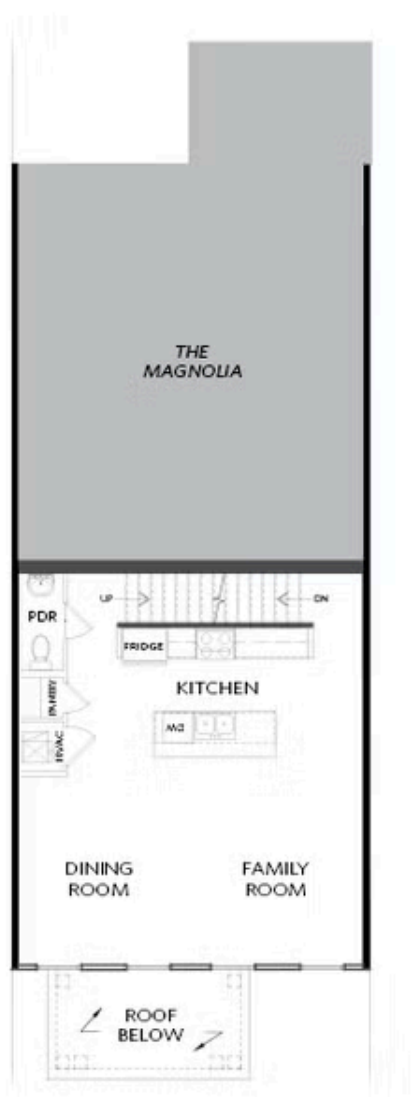

SECOND FLOOR

Elevations 1 & 1A Floor Plan Layout

Want to Know More
About This Home?

CONTACT OUR COMMUNITY SALES MANAGER
Call Us @ 678.372.1644

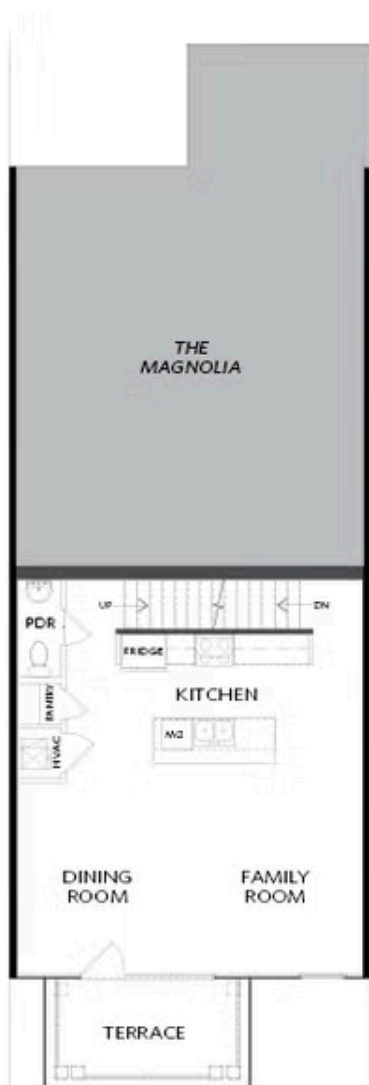

SECOND FLOOR

Elevations 1 & 1A Floor Plan Layout

Want to Know More
About This Home?

CONTACT OUR COMMUNITY SALES MANAGER
Call Us @ 678.372.1644

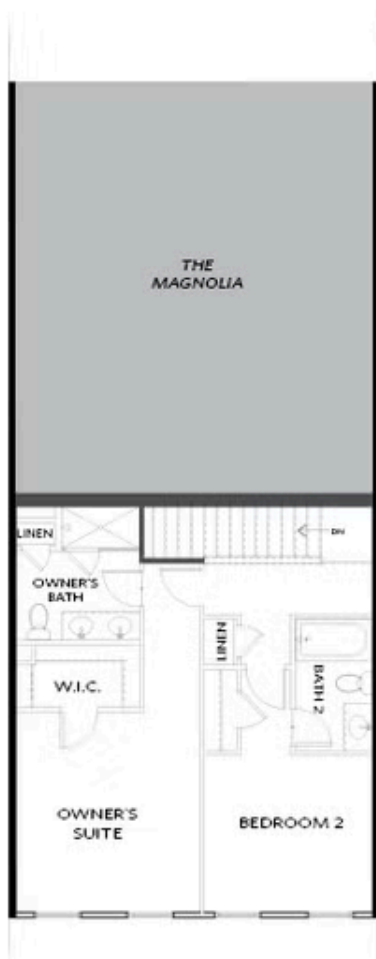

THIRD FLOOR

Elevations 1 & 1A Floor Plan Layout

Want to Know More
About This Home?

CONTACT OUR COMMUNITY SALES MANAGER
Call Us @ 678.372.1644