



PRICED AT  
**\$487,900**

 1703 Sq Ft

 3 Beds

 3.5 Baths

 1 Car Garage

 3.0 Story

Spring into a New Home with \$30,000 Anyway OR 5.25% Fixed Rate (Limited) with Preferred Lender, Capital City Home Loans PLUS Move In Package: GE Refrigerator & Blinds throughout for contracts this month! \*Homes already include GE Profile 2 in 1 Washer Dryer! \* Welcome to Market Square at Sawnee Village- A Master Planned Community with Shoppes, Dining & Entertainment right at your entrance~ The Oleander Plan: 3 Bedroom, 3.5 Bath Stacked Townhome with Condominium Ownership. Designed with sophistication and functionality in mind, this 1,703 sq/ft townhome embraces The Providence Group's Cool Linen Design Collection and spans three impressive levels: Terrace Level: A private bedroom with full bathroom and private terrace patio —ideal for hosting guests, setting up your home office, or creating a personal fitness retreat. Enjoy oversized 1 car garage outfitted with EV Charger plus driveway for additional garage. Main Level: Entertain with ease in the open-concept layout featuring a family room, dining area, and a chef-inspired kitchen. The kitchen boasts 42" cabinetry, quartz countertops, stainless-steel GE appliances, a sleek tile backsplash, and designer lighting. Upper Level: Retreat to the Primary Suite with a walk-in closet and spa-like double-vanity bathroom, complete with a luxurious walk-in shower. A secondary bedroom ...

**Want to Know More  
About This Home?**

CONTACT OUR COMMUNITY SALES MANAGER  
Call Us @ 678.372.1644



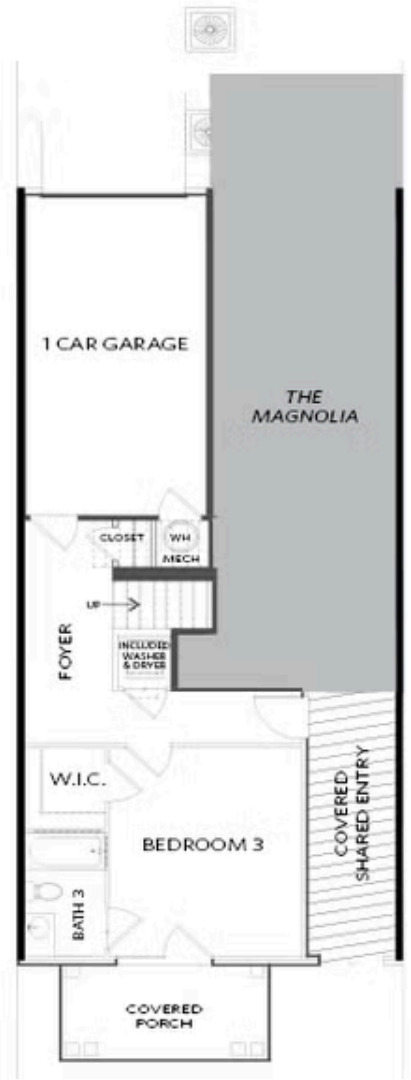

FIRST FLOOR

Elevations 1 & 1A Floor Plan Layout

Want to Know More  
About This Home?

CONTACT OUR COMMUNITY SALES MANAGER  
Call Us @ 678.372.1644

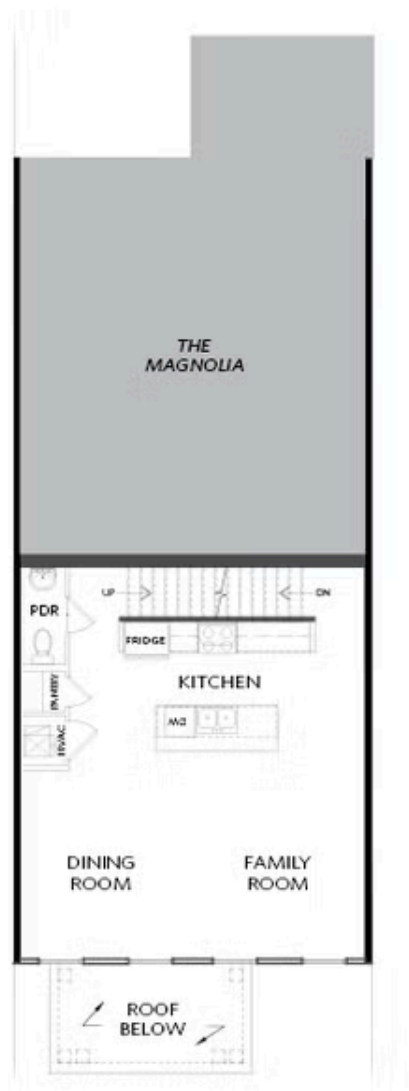

SECOND FLOOR

Elevations 1 & 1A Floor Plan Layout

Want to Know More  
About This Home?

CONTACT OUR COMMUNITY SALES MANAGER  
Call Us @ 678.372.1644



SECOND FLOOR

Elevations 1 & 1A Floor Plan Layout

Want to Know More  
About This Home?

CONTACT OUR COMMUNITY SALES MANAGER  
Call Us @ 678.372.1644

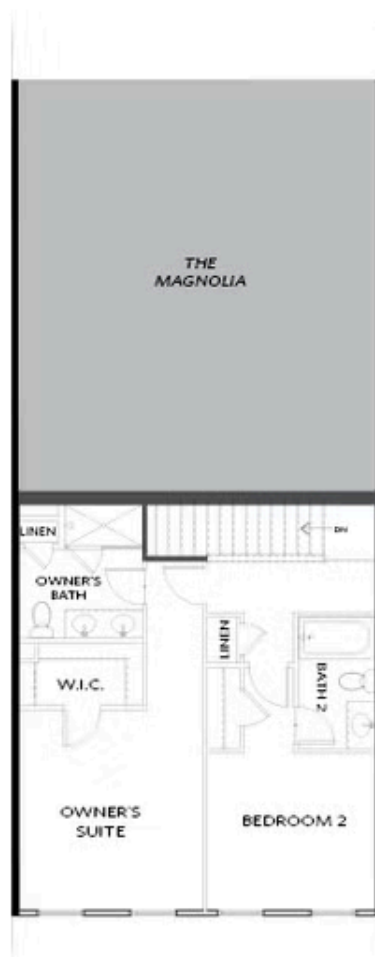

THIRD FLOOR

Elevations 1 & 1A Floor Plan Layout

Want to Know More  
About This Home?

CONTACT OUR COMMUNITY SALES MANAGER  
Call Us @ 678.372.1644