



PRICED AT
\$442,900

 **1373 Sq Ft**

 **2 Beds**

 **2.5 Baths**

 **1 Car Garage**

 **3.0 Story**

Market Square at Sawnee Village - Downtown Cummings latest Master Planned Community! Spring into a New Home with \$20,000 Towards Closing Cost for Contracts written this month when financing is completed with Preferred Lender, Capital City Home Loans PLUS Move In Package: GE Refrigerator & Blinds throughout home for contracts written in February! *Homes already include GE Profile 2 in 1 Washer Dryer! * Immerse yourself in the vibrant rhythm of urban life within Sawnee Village's dynamic Market Square District. Just moments away from an enticing array of shops and dining spots, this neighborhood pulsates with convenience and energy. Market Square beckons both those embarking on their first home-buying journey and those in search of refined downsizing options. Tucked into the heart of Cumming, GA, this lively community showcases a diverse selection of chic 3 Story Stacked Townhome with Condominium Ownership tailored to fulfill your every desire. The Magnolia Plan, adorned with The Providence Groups' sophisticated Warm Linen Design Collection, spans three levels, encompassing 2 bedrooms and 2.5 bathrooms within its generous 1373 sq. ft. Step into the terrace level, where a welcoming foyer paired with a laundry area awaits. Ascend to the main floor, where an airy, open layout ...

**Want to Know More
About This Home?**

**CONTACT OUR COMMUNITY SALES MANAGER
Call Us @ 678.372.1644**



FIRST FLOOR

Elevations 1 & 1A Floor Plan Layout

Want to Know More
About This Home?

CONTACT OUR COMMUNITY SALES MANAGER
Call Us @ 678.372.1644

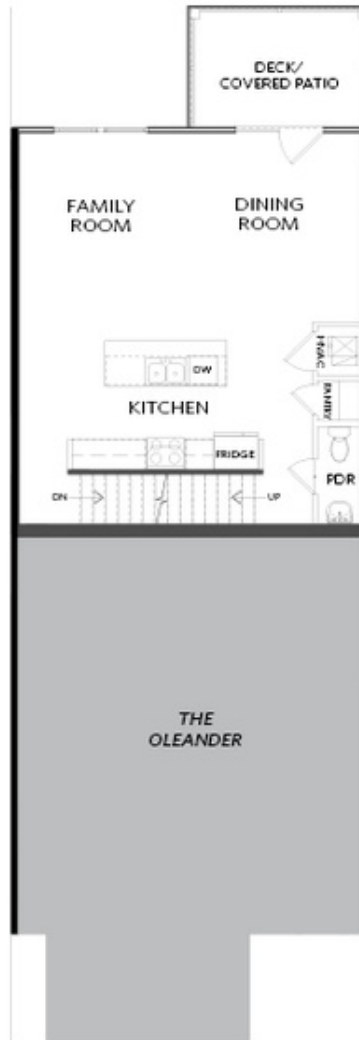

SECOND FLOOR

Elevations 1 & 1A Floor Plan Layout

Want to Know More
About This Home?

CONTACT OUR COMMUNITY SALES MANAGER
Call Us @ 678.372.1644



THIRD FLOOR

Elevations 1 & 1A Floor Plan Layout

Want to Know More
About This Home?

CONTACT OUR COMMUNITY SALES MANAGER
Call Us @ 678.372.1644