



PRICED AT
\$399,000

 1373 Sq Ft

 2 Beds

 2.5 Baths

 1 Car Garage

 3.0 Story

Immerse yourself in the vibrant rhythm of urban life within Sawnee Village's dynamic Market Square District. Just moments away from an enticing array of shops and dining spots, this neighborhood pulsates with convenience and energy. Market Square beckons both those embarking on their first home-buying journey and those in search of refined downsizing options. Tucked into the heart of Cumming, GA, this lively community showcases a diverse selection of chic 3 Story Stacked Townhome with Condominium Ownership tailored to fulfill your every desire. The Magnolia Plan, adorned with The Providence Groups' sophisticated Warm Linen Design Collection, spans three levels, encompassing 2 bedrooms and 2.5 bathrooms within its generous 1373 sq. ft. Step into the terrace level, where a welcoming foyer paired with a laundry area awaits. Ascend to the main floor, where an airy, open layout seamlessly integrates the family room and dining area with a chef-inspired kitchen boasting elegant 42" cabinets and striking quartz countertops atop a grand island. Complete with stainless-steel GE appliances, a stylish tile backsplash, and contemporary lighting fixtures, this kitchen is a dream come true. Sunlight floods the main living area leading out to an expansive deck, setting the scene for memorable gatherings. Journey to ...

**Want to Know More
About This Home?**

CONTACT OUR COMMUNITY SALES MANAGER
Call Us @ 678.372.1644

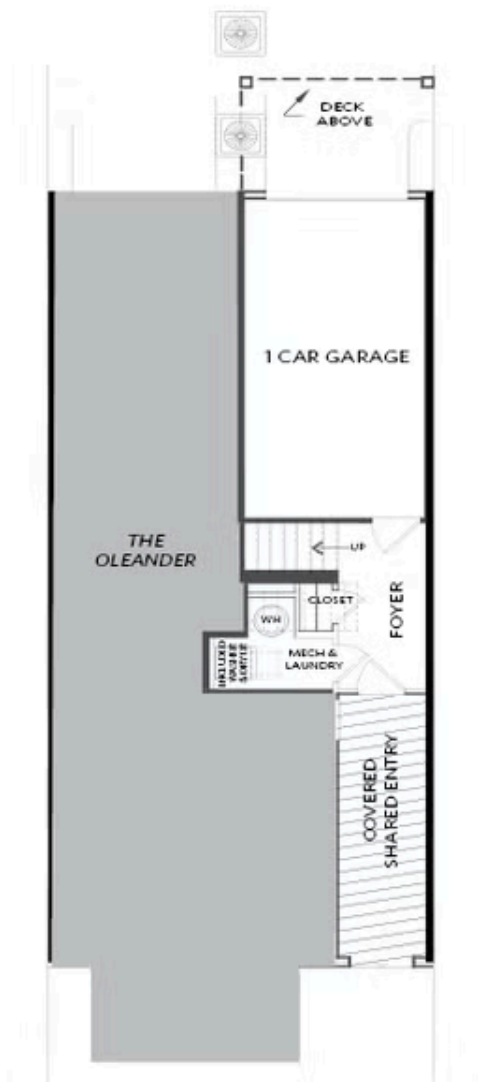

FIRST FLOOR

Elevations 1 & 1A Floor Plan Layout

Want to Know More
About This Home?

CONTACT OUR COMMUNITY SALES MANAGER
Call Us @ 678.372.1644

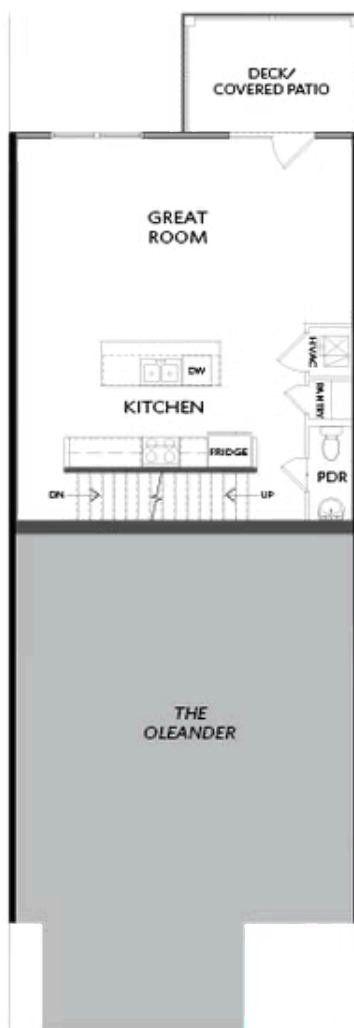

SECOND FLOOR

Elevations 1 & 1A Floor Plan Layout

Want to Know More
About This Home?

CONTACT OUR COMMUNITY SALES MANAGER
Call Us @ 678.372.1644



THIRD FLOOR

Elevations 1 & 1A Floor Plan Layout

Want to Know More
About This Home?

CONTACT OUR COMMUNITY SALES MANAGER
Call Us @ 678.372.1644