

PRICED AT
\$447,900

 1373 Sq Ft

 2 Beds

 2.5 Baths

 1 Car Garage

 3.0 Story

Spring into a New Home with \$15k Anyway & \$15k Closing Cost or 5.25% Fixed Rate (LIMITED OPPORTUNITY) with Preferred Lender, Capital City Home Loans PLUS Move In Ready Package (Refrigerator, Blinds - GE Profile Combo Washer/Dryer already included). Quick Move-In Home! Immerse yourself in the vibrant rhythm of urban life within Sawnee Village's dynamic Market Square District. Just moments from Front Yard Retail & City Center's shops and dining destinations, this neighborhood buzzes with energy and unmatched convenience. Whether you're a first-time buyer or looking to downsize in style, Market Square offers the perfect balance of modern living and thoughtful design. Nestled in the heart of Cumming, GA, this lively community features a chic collection of 3-story stacked townhomes with condominium ownership. The Magnolia Plan, thoughtfully curated with The Providence Group's sophisticated Warm Wheat Design Collection, offers 2 bedrooms, 2.5 bathrooms, and 1,373 sq. ft. of elevated living space. Enjoy light-colored engineered hardwoods throughout the main living areas and cozy carpet in the bedrooms. The kitchen is a true showstopper, showcasing Alabaster perimeter soft-close cabinets paired with a Chestnut-stained island, quartz countertops, sleek 42" cabinetry, stainless steel GE appliances, a striking tile backsplash, and stylish modern lighting. On the ...

**Want to Know More
About This Home?**

CONTACT OUR COMMUNITY SALES MANAGER
Call Us @ 678.372.1644

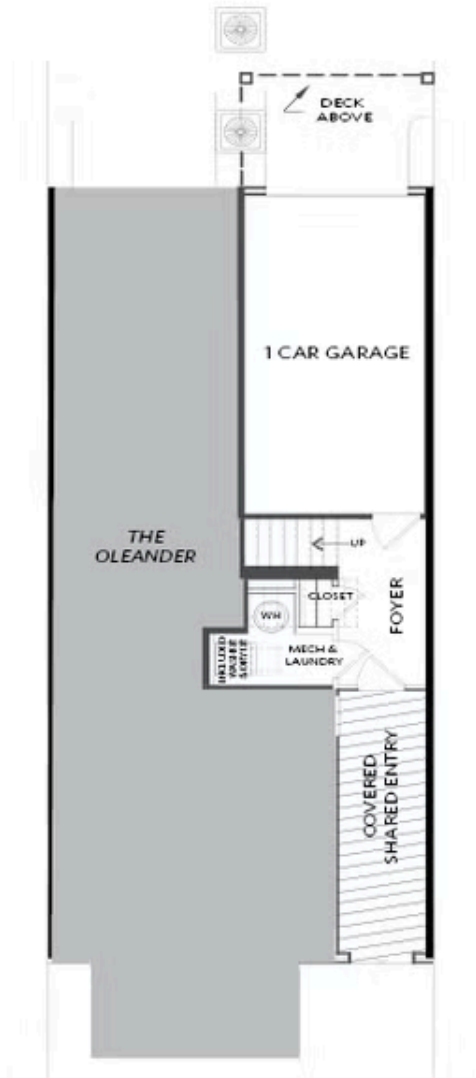

FIRST FLOOR

Elevations 1 & 1A Floor Plan Layout

Want to Know More
About This Home?

CONTACT OUR COMMUNITY SALES MANAGER
Call Us @ 678.372.1644

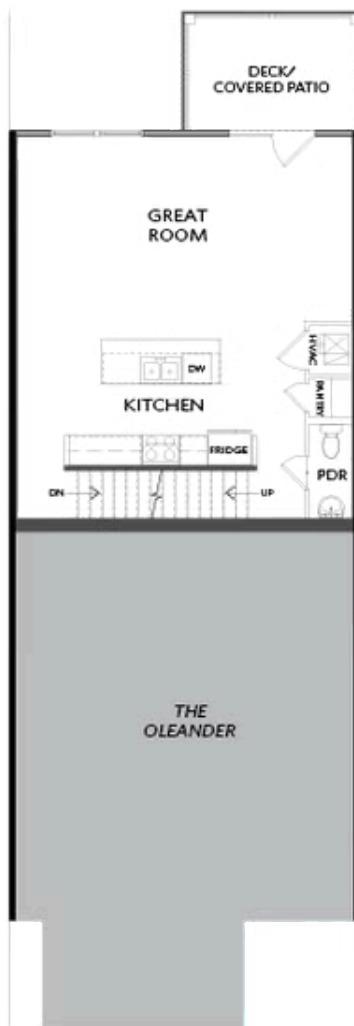

SECOND FLOOR

Elevations 1 & 1A Floor Plan Layout

Want to Know More
About This Home?

CONTACT OUR COMMUNITY SALES MANAGER
Call Us @ 678.372.1644



THIRD FLOOR

Elevations 1 & 1A Floor Plan Layout

Want to Know More
About This Home?

CONTACT OUR COMMUNITY SALES MANAGER
Call Us @ 678.372.1644