



PRICED AT
\$427,900

 **1373 Sq Ft**

 **2 Beds**

 **2.5 Baths**

 **1 Car Garage**

 **3.0 Story**

New Year, New Home, New You! \$15,000 Incentive has been applied to List Price for January PLUS Move In Package: GE Refrigerator & Blinds throughout home for contracts written in January! *Homes already include GE Profile 2 in 1 Washer Dryer! * Welcome to Market Square at Sawnee Village Step into the pulse of urban living in the dynamic Market Square District of Sawnee Village. Located in the heart of Cumming, GA, this vibrant neighborhood offers unmatched convenience with a host of shops and dining just steps away. Whether you're a first-time homebuyer or seeking the perfect downsizing solution, Market Square is designed to meet your every need. The Magnolia Plan: Sophistication Meets Functionality Adorned with The Providence Group's elegant Cool Linen Design Collection, this thoughtfully crafted 3 Story Stacked Townhome with Condominium Ownership offers 2 bedrooms, 2.5 bathrooms, and 1,373 sq. ft. of modern living: Terrace Level: A welcoming foyer greets you, alongside a conveniently located laundry area for added practicality. Main Level: The open-concept design seamlessly connects the family room, dining area, and chef-inspired kitchen. Enjoy 42" cabinets, a grand quartz-topped island, stainless-steel GE appliances, a striking tile backsplash, and modern lighting fixtures. Natural light flows through this ...

**Want to Know More
About This Home?**

CONTACT OUR COMMUNITY SALES MANAGER
Call Us @ 678.372.1644



FIRST FLOOR

Elevations 1 & 1A Floor Plan Layout

Want to Know More
About This Home?

CONTACT OUR COMMUNITY SALES MANAGER
Call Us @ 678.372.1644

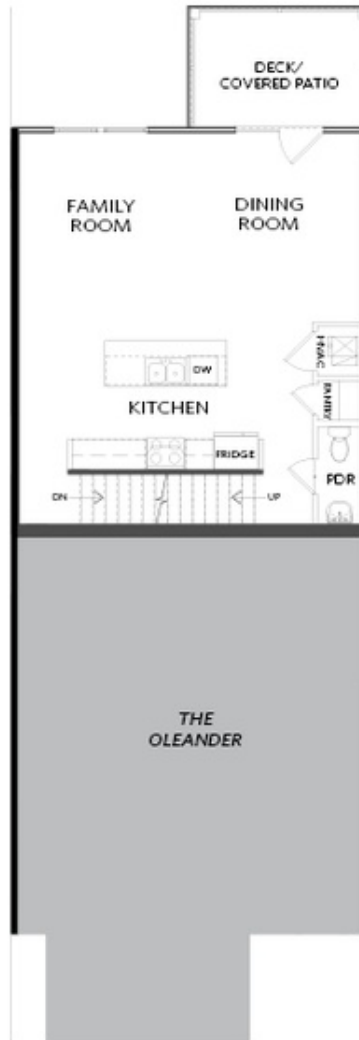

SECOND FLOOR

Elevations 1 & 1A Floor Plan Layout

Want to Know More
About This Home?

CONTACT OUR COMMUNITY SALES MANAGER
Call Us @ 678.372.1644



THIRD FLOOR

Elevations 1 & 1A Floor Plan Layout

Want to Know More
About This Home?

CONTACT OUR COMMUNITY SALES MANAGER
Call Us @ 678.372.1644