



PRICED AT  
**\$503,900**

 **1703 Sq Ft**

 **3 Beds**

 **3.5 Baths**

 **1 Car Garage**

 **3.0 Story**

**Spring into a New Home! \$20,000 Towards Closing Cost for Contracts written this month when financing is completed with Preferred Lender, Capital City Home Loans PLUS Move In Package: GE Refrigerator & Blinds throughout home \*Homes already include GE Profile 2 in 1 Washer Dryer!\* Move In Ready! Explore the charm of urban living nestled within the lively Market Square District of Sawnee Village. Surrounded by an enticing mix of retail and dining venues just a stone's throw away, the allure of convenience and adventure awaits. Whether you're taking your first step into homeownership or seeking the perfect downsizing solution, Market Square beckons with options to suit every lifestyle. Located in the heart of Cumming, GA, this community unveils a collection of impeccably designed 3 Story Stacked Townhome with Condominium Ownership tailored to your needs. Embracing The Providence Groups' Warm Wheat Design Collection, this end unit Oleander Plan spans three levels, offering 3 bedrooms and 3.5 bathrooms across 1703 sq. ft. Venture to the terrace level to discover a welcoming bedroom accompanied by a luxurious ensuite—an ideal space for guests, a home office, or a personal gym sanctuary. On the main level, an elegant fusion of the family room, dining ...**

**Want to Know More  
About This Home?**

**CONTACT OUR COMMUNITY SALES MANAGER**  
**Call Us @ 678.372.1644**

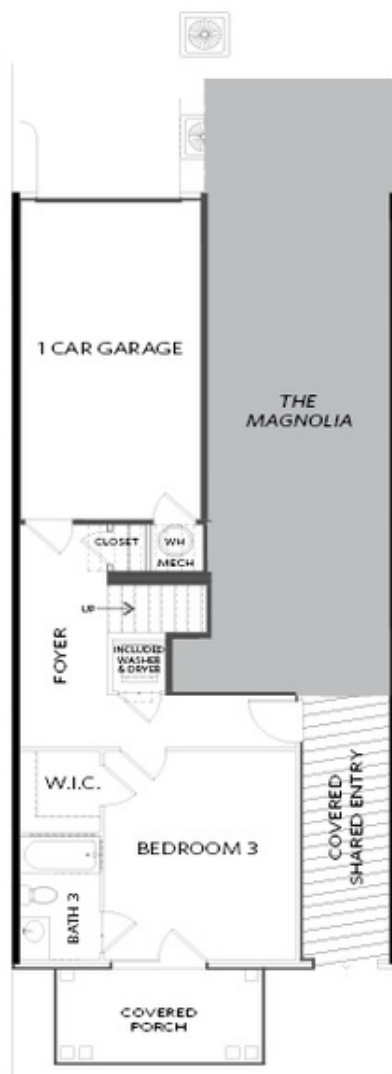

FIRST FLOOR

Elevations 1 & 1A Floor Plan Layout

Want to Know More  
About This Home?

CONTACT OUR COMMUNITY SALES MANAGER  
Call Us @ 678.372.1644

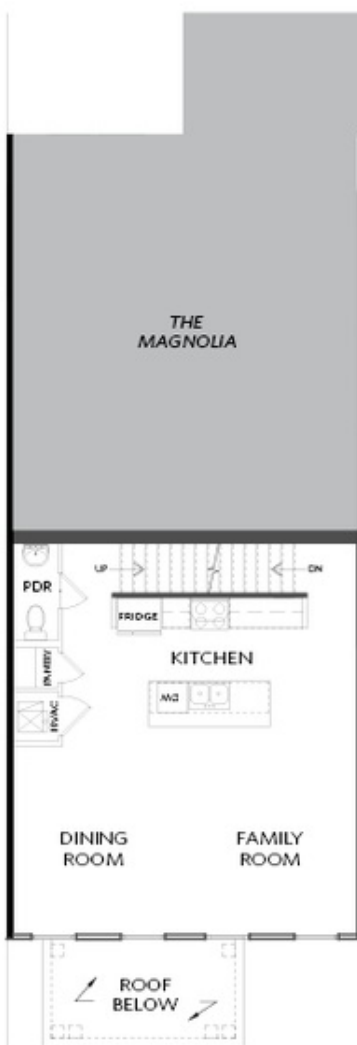

## SECOND FLOOR

Elevations 1 & 1A Floor Plan Layout

Want to Know More  
About This Home?

CONTACT OUR COMMUNITY SALES MANAGER  
Call Us @ 678.372.1644

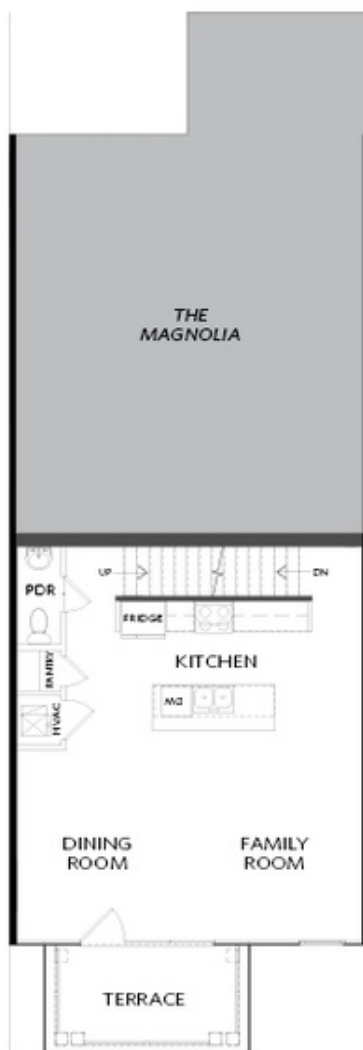

**SECOND FLOOR**

Elevations 1 & 1A Floor Plan Layout

**Want to Know More  
About This Home?**

**CONTACT OUR COMMUNITY SALES MANAGER  
Call Us @ 678.372.1644**

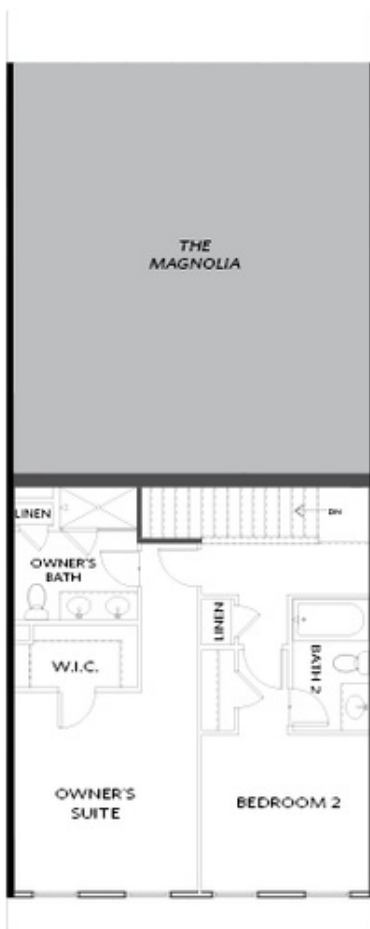

THIRD FLOOR

Elevations 1 & 1A Floor Plan Layout

Want to Know More  
About This Home?

CONTACT OUR COMMUNITY SALES MANAGER  
Call Us @ 678.372.1644