



PRICED FROM
\$439,900

 **1,373 Sq Ft**

 **2 Beds**

 **2.5 Baths**

 **1 Car Garage**

 **3.0 Story**

- **Three Story Design with an Open Main Level Layout**
- **Shared Covered Entry Way at the Front of the Building; The Oleander is at the Front of the Building while the Magnolia Floor Plan is at the Rear of the Building**
- **The Second Floor has a Gourmet Kitchen with an Island overlooking the Dining Room & Family Room**
- **A Deck or Covered Patio is Off the Dining Room (Per Plan)**
- **Owner's Suite and a Secondary Bedroom with Full Bath are on the Third Level**
- **The Owner's Suite has a Walk-In Closet; The Owner's Bath Features a Dual Vanity, Linen Closet, and a**

[Read More Online](#)

Available Elevations





FIRST FLOOR

Elevations 1 & 1A Floor Plan Layout

Want to Know More
About This Home?

CONTACT OUR COMMUNITY SALES MANAGER
Call Us @ 678.372.1644

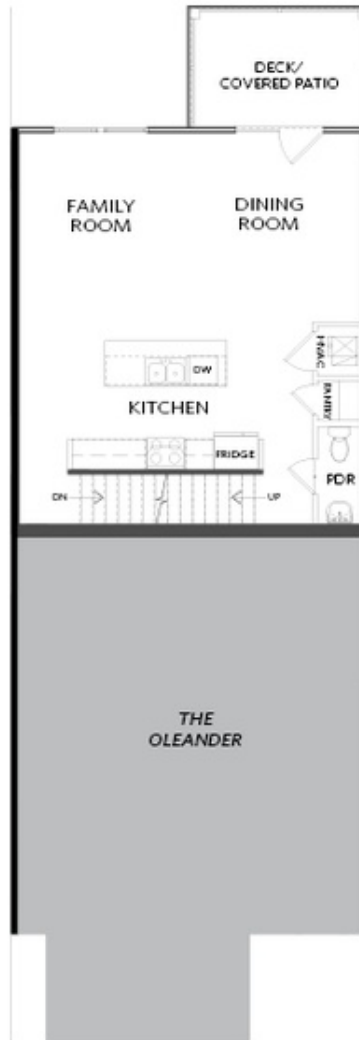

SECOND FLOOR

Elevations 1 & 1A Floor Plan Layout

Want to Know More
About This Home?

CONTACT OUR COMMUNITY SALES MANAGER
Call Us @ 678.372.1644



THIRD FLOOR

Elevations 1 & 1A Floor Plan Layout

Want to Know More
About This Home?

CONTACT OUR COMMUNITY SALES MANAGER
Call Us @ 678.372.1644