



PRICED FROM  
**\$479,900**

 **1,703 Sq Ft**

 **3 Beds**

 **3.5 Baths**

 **1 Car Garage**

 **3.0 Story**

- **Spacious Three Story Design with an Open Main Level Layout**
- **Shared Covered Entry Way at the Front of the Building; The Oleander is at the Front of the Building while the Magnolia Floor Plan is at the Rear of the Building**
- **A Bedroom on the Terrace with a Full Bath and Access to a Covered Porch**
- **On the Second Floor, a Gourmet Kitchen with an Island overlooking the Dining Room & Family Room**
- **Small Terrace off the Dining Room (Per Elevation)**
- **Owner's Suite and a Secondary Bedroom with Full Bath are on the Third Level**

[Read More Online](#)

## Available Elevations



Front Elevation Building 7



Rear Elevation Building 6



FIRST FLOOR

Elevations 1 & 1A Floor Plan Layout

Want to Know More  
About This Home?

CONTACT OUR COMMUNITY SALES MANAGER  
Call Us @ 678.372.1644

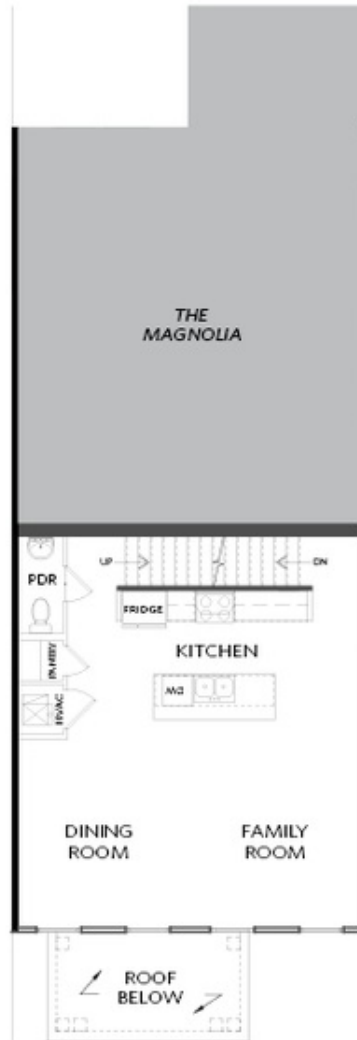

SECOND FLOOR

Elevations 1 & 1A Floor Plan Layout

Want to Know More  
About This Home?

CONTACT OUR COMMUNITY SALES MANAGER  
Call Us @ 678.372.1644

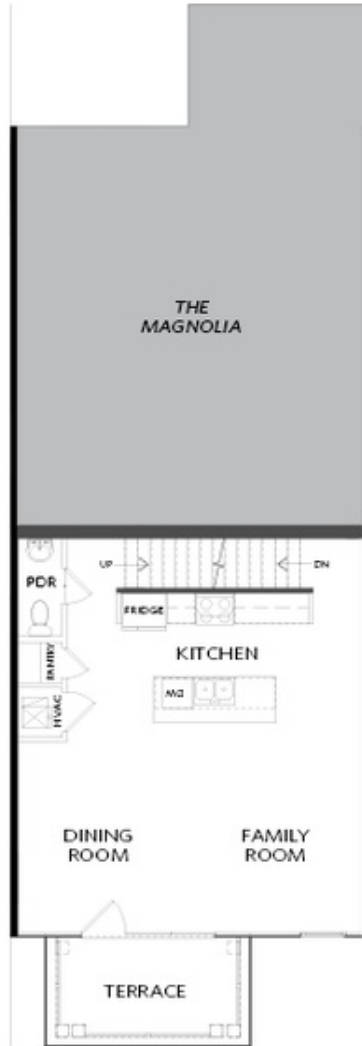

**SECOND FLOOR**

Elevations 1 & 1A Floor Plan Layout

**Want to Know More  
About This Home?**

**CONTACT OUR COMMUNITY SALES MANAGER**  
**Call Us @ 678.372.1644**

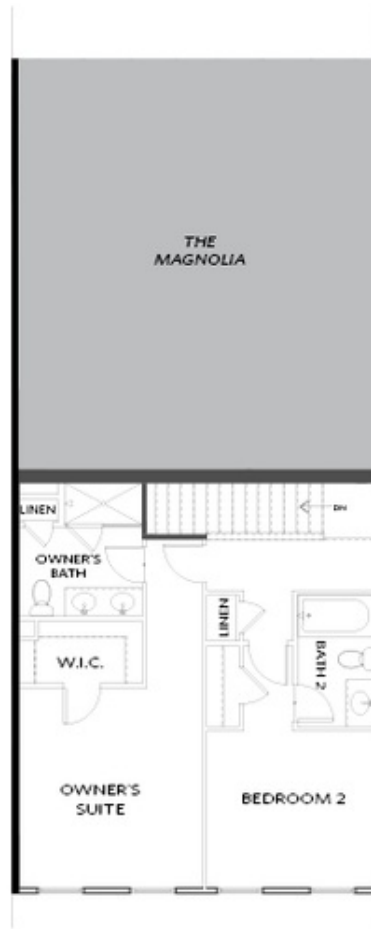

THIRD FLOOR

Elevations 1 & 1A Floor Plan Layout

Want to Know More  
About This Home?

CONTACT OUR COMMUNITY SALES MANAGER  
Call Us @ 678.372.1644