



PRICED AT
\$688,720

 **2518 Sq Ft**

 **4 Beds**

 **3.0 Baths**

 **2 Car Garage**

 **2.0 Story**

Fabulous Fall Savings! Welcome to the grand opening of Palisades at Sawnee Village, where luxury meets breathtaking views in an exclusive mountain-top setting. This stunning 4-bedroom, 3-bathroom residence spans three stories, offering an expansive living experience with spectacular vistas of the mountaintops and the town of Cumming. The thoughtfully designed home features 10-foot ceilings, with a welcoming bedroom and full bathroom on the main level. The open-plan living area showcases a gourmet kitchen equipped with 42" Cabinets with soft close doors, undercabinet lighting, stainless steel appliances and quartz countertops. Enjoy seamless indoor-outdoor living with a covered patio and an extended outdoor space ideal for both quiet relaxation and entertaining guests. The second level includes a versatile media room, while the top floor is dedicated to a private 5th bedroom and bathroom, perfect for guests or family members seeking a bit of seclusion. The luxurious owner's suite on the upper floor is highlighted by a 10-foot tray ceiling and a beautifully appointed on-suite bathroom that includes Designer Tile Shower w Frameless Shower Door and Soaking Tub. Positioned just 1.5 miles from Interstate 400 and minutes from the new Cumming City Center, Cumming Parks and Recreation, Historic Downtown Cumming, and Halcyon shopping, ...

**Want to Know More
About This Home?**

CONTACT OUR COMMUNITY SALES MANAGER

NONE

Call Us @ 470.456.9551



FIRST FLOOR

Elevation C

Want to Know More
About This Home?

CONTACT OUR COMMUNITY SALES MANAGER

NONE

Call Us @ 470.456.9551



SECOND FLOOR

Elevation C

Want to Know More
About This Home?

CONTACT OUR COMMUNITY SALES MANAGER

NONE

Call Us @ 470.456.9551



OPT THIRD FLOOR

Elevation C

Want to Know More
About This Home?

CONTACT OUR COMMUNITY SALES MANAGER

NONE

Call Us @ 470.456.9551

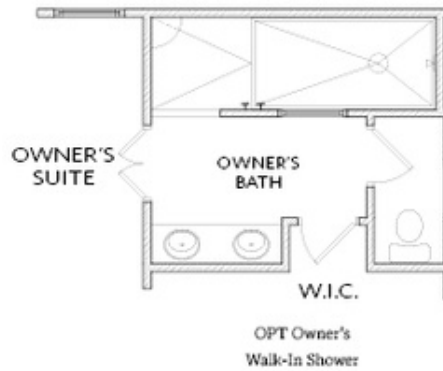

OPT Second Floor 3rd Bath
 When NO Third Floor is Selected

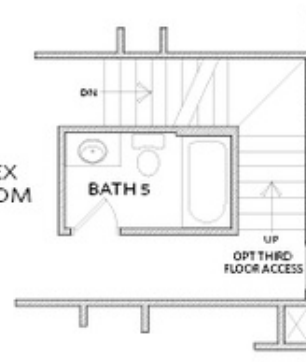

OPT Second Floor 3rd Bath
 When OPT Third Floor is Selected

OPTIONS

Want to Know More
 About This Home?

CONTACT OUR COMMUNITY SALES MANAGER

NONE

Call Us @ 470.456.9551