



PRICED AT  
**\$550,900**

 2004 Sq Ft

 3 Beds

 3.5 Baths

 2 Car Garage

 3.0 Story

Home for the holidays! Palisades at Sawnee Village, where the charm of mountain living meets modern sophistication! This exquisite Garwood floor plan by The Providence Group is a remarkable townhome nestled on the mountainside, offering stunning vistas of Cumming. We are currently offering \$15,000 any way you want it! With Energy Star Certification, the home beautifully marries rustic appeal with contemporary comforts. Upon entering, you'll find a welcoming recessed foyer leading into a bright, open-concept living space. The airy great room effortlessly transitions to a sunroom, a peaceful retreat perfect for savoring the sweeping views. Designed for seamless living, the Garwood floor plan boasts gas appliances and a range of thoughtfully selected energy-efficient features. The interior finishes are part of our stunning warm stone design collection, created by our award-winning design team. Located just a short drive from Cumming City Center and downtown, you'll enjoy convenient access to a variety of shops and dining options. Whether you're discovering the vibrant local culture or relaxing in your serene mountain getaway, this townhome offers the ideal blend of luxury, comfort, and convenience. Don't miss this exclusive opportunity—your new home at Palisades at Sawnee Village awaits!

**Want to Know More  
About This Home?**

CONTACT OUR COMMUNITY SALES MANAGER  
Call Us @ 470.456.9551



**Want to Know More  
About This Home?**

CONTACT OUR COMMUNITY SALES MANAGER  
Call Us @ 470.456.9551

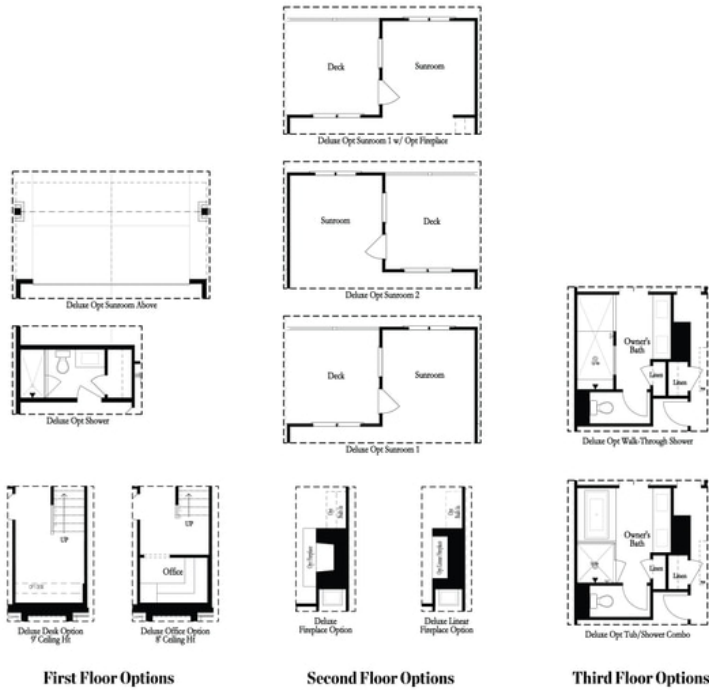

**Want to Know More  
 About This Home?**

CONTACT OUR COMMUNITY SALES MANAGER  
 Call Us @ 470.456.9551