



PRICED AT
\$674,960

 2445 Sq Ft

 4 Beds

 3.0 Baths

 2 Car Garage

 2.0 Story

Discover the elegance and convenience of this new community with a beautiful 4-bedroom, 3-bath home designed for modern living. With 10-foot ceilings and tall 8-foot doors on the main level, this home exudes sophistication and comfort. The main level features a guest room with a full bath, ideal for visitors. The open-plan layout includes a large island with quartz countertops, 42-inch cabinets with soft-close doors, under-counter lighting, and a stylish designer tile backsplash. The family room flows seamlessly into the kitchen and dining areas. Hardwood floors extend throughout the main living areas and stairs, adding a touch of luxury. Step outside to enjoy the covered patio with a concrete extension, perfect for outdoor entertaining. The property also includes an outdoor irrigation system for both the front and backyard, ensuring your outdoor spaces remain lush and inviting. Upstairs, the owner's suite is a true retreat, featuring 10-foot tray ceilings and a spa-like bath with a designer tile shower, frameless shower door, and soaking tub. A versatile loft space at the top of the stairs provides an ideal spot for an office, media room, or activity room. The farmhouse elevation of this home complements its picturesque setting, offering sky views of Cumming ...

**Want to Know More
About This Home?**

CONTACT OUR COMMUNITY SALES MANAGER

NONE

Call Us @ 470.456.9551



FIRST FLOOR

Elevation D

Want to Know More
About This Home?

CONTACT OUR COMMUNITY SALES MANAGER

NONE

Call Us @ 470.456.9551



SECOND FLOOR

Elevation D

Want to Know More
About This Home?

CONTACT OUR COMMUNITY SALES MANAGER

NONE

Call Us @ 470.456.9551

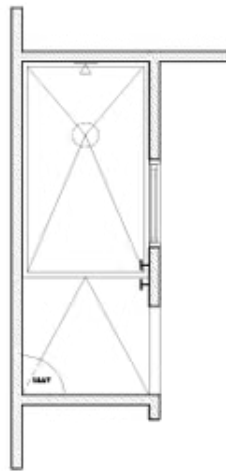

OPT Owner's Walk-In Shower

OPTIONS

Want to Know More
About This Home?

CONTACT OUR COMMUNITY SALES MANAGER

NONE

Call Us @ 470.456.9551