







PRICED AT  
**\$709,485**

-  2831 Sq Ft
-  5 Beds
-  4.0 Baths
-  2 Car Garage
-  2.0 Story

Spring into a New Home! \$30,000 promotion is reflected in the price and has been applied to the listing for contracts in May 2025. Welcome to Palisades, a new home community where luxury meets breathtaking views in an exclusive mountain-top setting. This stunning 5-bedroom, 4-bathroom residence spans three stories, offering an expansive living experience with spectacular vistas of the mountaintops and the town of Cumming. The thoughtfully designed home features 10-foot ceilings, with a welcoming bedroom and full bathroom featuring a standing shower on the main level. The open-plan living area showcases a gourmet kitchen equipped with 42" Cabinets with soft close doors, undercounter lighting, stainless steel appliances and quartz countertops. Enjoy seamless indoor-outdoor living with a covered patio and an extended outdoor space ideal for both quiet relaxation and entertaining guests. The second level includes a versatile media room, while the top floor is dedicated to a private 5th bedroom and bathroom, perfect for guests or family members seeking a bit of seclusion. The luxurious owner's suite on the upper floor is highlighted by a 10-foot tray ceiling and a beautifully appointed en-suite bathroom that includes Designer Tile Shower w Frameless Shower Door and Soaking Tub. Iron fencing included ...

**Want to Know More  
About This Home?**

CONTACT OUR COMMUNITY SALES MANAGER  
**NONE**  
Call Us @ 470.456.9551



Elevation C

Want to Know More  
About This Home?

CONTACT OUR COMMUNITY SALES MANAGER

NONE

Call Us @ 470.456.9551



Elevation C

Want to Know More  
About This Home?

CONTACT OUR COMMUNITY SALES MANAGER

NONE

Call Us @ 470.456.9551



Elevation D

Want to Know More  
About This Home?

CONTACT OUR COMMUNITY SALES MANAGER

NONE

Call Us @ 470.456.9551



Elevation C & D

Want to Know More  
About This Home?

CONTACT OUR COMMUNITY SALES MANAGER

NONE

Call Us @ 470.456.9551



OPT Fireplace

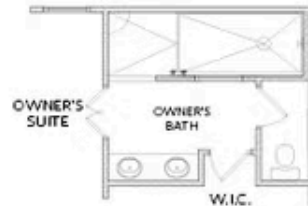

OPT Owner's  
Walk-In Shower



OPT Second Floor 3rd Bath  
When NO Third Floor is Selected

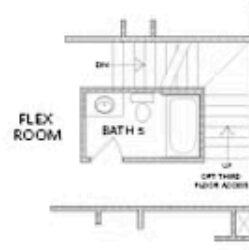

OPT Second Floor 3rd Bath  
When OPT Third Floor is Selected

Want to Know More  
About This Home?

CONTACT OUR COMMUNITY SALES MANAGER

NONE

Call Us @ 470.456.9551