



PRICED FROM
\$645,900

 **2,518 - 2,831 Sq Ft**

 **4 - 5 Beds**

 **3 - 5 Baths**

 **2 Car Garage**

 **2.0 - 3.0 Story**

- **Classic 2-Story Single-Family Home with Optional 3rd Story**
- **Open Concept with a view from the Kitchen to the Dining to the Family Room**
- **L-Shaped Kitchen with seating for 3 at the Large Kitchen Island**
- **Sliding Glass Door Opens to a Patio off the Family Room - Brings the Outdoors In**
- **Optional Covered Patio off the Family Room**
- **Second Floor Features the Owner's Suite, a Loft and Two Secondary Bedrooms**
- **Optional 3rd Floor Adds a 5th Bedroom and Full Bath**

[Read More Online](#)

Available Elevations



Elevation C



Elevation D



FIRST FLOOR

Elevation C

Want to Know More
About This Home?

CONTACT OUR COMMUNITY SALES MANAGER

NONE

Call Us @ 470.456.9551



SECOND FLOOR

Elevation C

Want to Know More
About This Home?

CONTACT OUR COMMUNITY SALES MANAGER

NONE

Call Us @ 470.456.9551



OPT THIRD FLOOR

Elevation C

Want to Know More
About This Home?

CONTACT OUR COMMUNITY SALES MANAGER

NONE

Call Us @ 470.456.9551

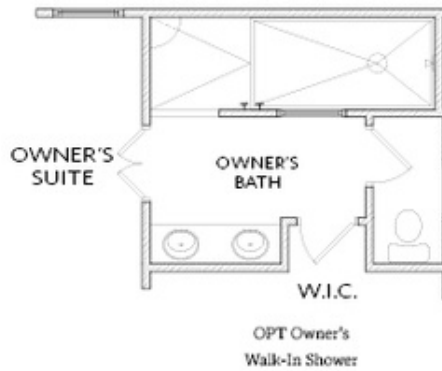

OPT Second Floor 3rd Bath
 When NO Third Floor is Selected

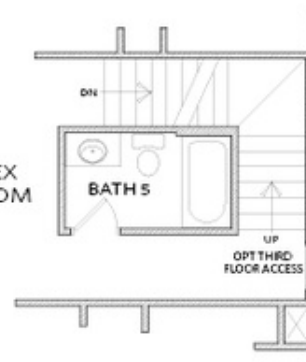

OPT Second Floor 3rd Bath
 When OPT Third Floor is Selected

OPTIONS

Want to Know More
 About This Home?

CONTACT OUR COMMUNITY SALES MANAGER

NONE

Call Us @ 470.456.9551