



PRICED AT  
**\$788,345**

 **2783 Sq Ft**

 **4 Beds**

 **3.5 Baths**

 **2 Car Garage**

 **2.0 Story**

**FABULOUS FALL SAVINGS!!** Welcome to the home you've been eagerly anticipating in the highly sought-after 55+ active adult community of Sawnee Village Promenade! Crafted with meticulous attention to detail and designed for effortless living, this MODEL Home offers a blend of comfort, convenience, and luxury. As you approach, a charming covered front porch welcomes you, setting the stage for the warmth and hospitality found within. Step inside to discover a thoughtfully laid-out floor plan that seamlessly combines style and functionality. The main level spacious kitchen with stainless appliances ideal for culinary adventures and casual gatherings, overlooking the inviting Family room with cozy gas fireplace and Dining area perfect for hosting memorable meals with friends and family. A main level Study provides a tranquil space for work or relaxation, while Main level Owner's suite offers a serene retreat with dual vanities, a walk-in closet, and a zero-entry shower with a convenient drying area—all designed for ultimate comfort. This home move in ready, with GE Profile Counter-Depth Refrigerator, Washer/Dryer & cabinets @ Laundry. Practicality meets convenience with a two-car garage, supplemented by a dedicated golf cart garage or storage space, ensuring ample room for vehicles and recreational gear. Outside, the side yard ...

Want to Know More  
About This Home?

CONTACT OUR COMMUNITY SALES MANAGER  
Call Us @ 470.462.9178



FIRST FLOOR

Elevation A

Want to Know More  
About This Home?

CONTACT OUR COMMUNITY SALES MANAGER  
Call Us @ 470.462.9178

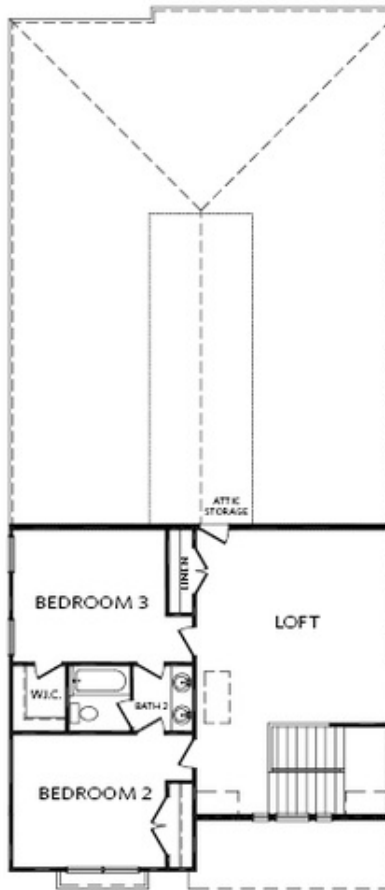

SECOND FLOOR

Elevation A

Want to Know More  
About This Home?

CONTACT OUR COMMUNITY SALES MANAGER  
Call Us @ 470.462.9178



OPT Sliding Glass Door



OPT Golf Cart Garage



OPT Tub/Shower Combo

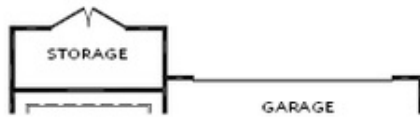

OPT Storage



OPT Larger Shower

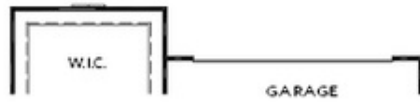

OPT Larger Owner's Closet

OPTIONS FIRST FLOOR

Want to Know More  
 About This Home?

CONTACT OUR COMMUNITY SALES MANAGER  
 Call Us @ 470.462.9178



OPT Bedroom 4 w/ Full Bath 3

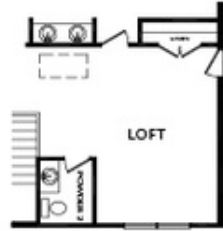

OPT 2nd Powder Room

OPTIONS SECOND FLOOR

Want to Know More  
About This Home?

CONTACT OUR COMMUNITY SALES MANAGER  
Call Us @ 470.462.9178