



PRICED AT
\$715,000

 **2964 Sq Ft**

 **4 Beds**

 **3.5 Baths**

 **2 Car Garage**

 **2.0 Story**

SPRING INTO A NEW YEAR, NEW HOME, NEW YOU!! We are almost a year old here at The Promenade at Sawnee Village. TPG's newest 55+OLDER ACTIVE ADULT COMMUNITY is continuing to grow! The Promenade is a gated community located in the heart of Cumming, featuring 221 homes all with the primary bedroom on main floor! The Amhurst is featured in our Arden Collection. This gorgeous 4 bedroom, 3 1/2-bathroom home is located on a corner lot closest to one of our many parks found throughout the community. This new home is under construction and will be ready in October, November of 2025. The curb appeal starts from the pretty streetscape as you approach this home. When you enter the foyer, you will find a designated dining space and a home office or additional living space. The family room opens up to the well-appointed kitchen featuring quartz countertops, under cabinet lighting, double stacked cabinets, GE appliances and all with soft touch drawers and doors. The primary bedroom is conveniently located on the main floor and features a sitting area perfect for the home office...large bathroom sporting a tub and glass frameless shower round off this spa like environment. An amazing loft ...

**Want to Know More
About This Home?**

CONTACT OUR COMMUNITY SALES MANAGER
Call Us @ 470.462.9178



FIRST FLOOR

Elevation A

Want to Know More
About This Home?

CONTACT OUR COMMUNITY SALES MANAGER
Call Us @ 470.462.9178

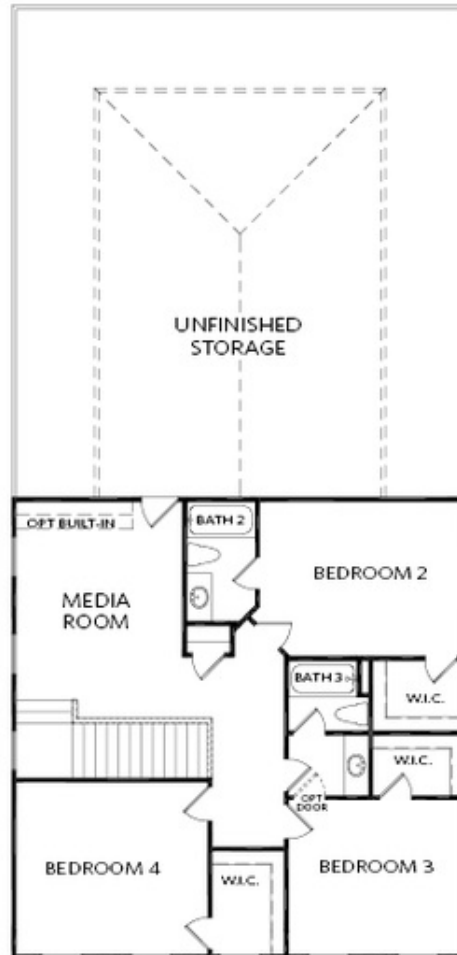

SECOND FLOOR

Elevation A

Want to Know More
About This Home?

CONTACT OUR COMMUNITY SALES MANAGER
Call Us @ 470.462.9178

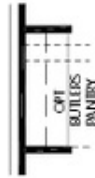

OPT Butler's Pantry

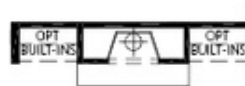

OPT Fireplace



OPT Owner's
Walk-In Shower



OPT Golf Cart Garage

OPTIONS

Want to Know More
About This Home?

CONTACT OUR COMMUNITY SALES MANAGER
Call Us @ 470.462.9178