



PRICED AT  
**\$807,900**

 **3140 Sq Ft**

 **4 Beds**

 **4.0 Baths**

 **2 Car Garage**

 **2.0 Story**

**SPRING INTO A NEW HOME....!** Are you looking for an amazing opportunity to practically customize your new home? We have just released the Bullard floorplan and presenting YOU the ability to select your structural options (fireplace, slider doors, etc) and then visit our amazing Design Center to select all your interior finishes!! Come visit the Promenade at Sawnee Village, The Providence Groups Newest and most Anticipated Gated **ACTIVE 55+ COMMUNITY** is now **OPEN!!** The community itself will feature 3 different home collections, the Motor court, the Arden and the Plaza. All of our new construction homes will have the primary bedroom on main floor for convenience and comfort. The Promenade is just around the corner from: Lake Lanier, the Northside Forsyth Hospital, the City of Cumming downtown area and the Cumming City Center. If you like location, location, location...come see us! We are conveniently located near GA 400 and the Sawnee Mountains!! Such a gorgeous area. We will be a gated **ACTIVE 55+ ADULT COMMUNITY**...exclusive amenities include pickleball, a clubhouse with catering kitchen, exercise room, great pool and fireplaces. Now that you are in love with the community, let's discuss this beautiful home known as the Bullard found in our ...

Want to Know More  
About This Home?

CONTACT OUR COMMUNITY SALES MANAGER  
Call Us @ 470.462.9178



FIRST FLOOR

Elevation A

Want to Know More  
About This Home?

CONTACT OUR COMMUNITY SALES MANAGER  
Call Us @ 470.462.9178

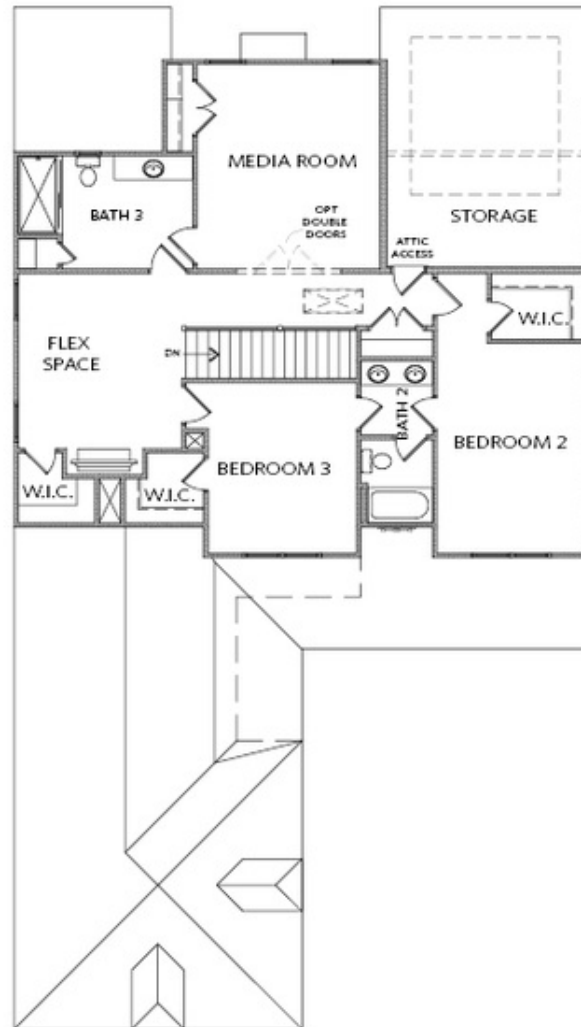

SECOND FLOOR

Elevation A

Want to Know More  
About This Home?

CONTACT OUR COMMUNITY SALES MANAGER  
Call Us @ 470.462.9178

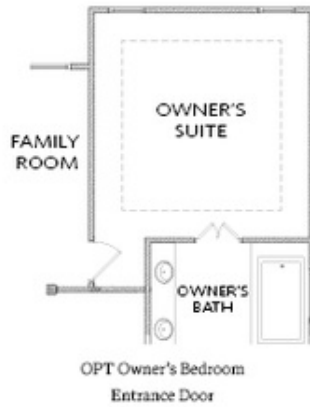

FIRST FLOOR

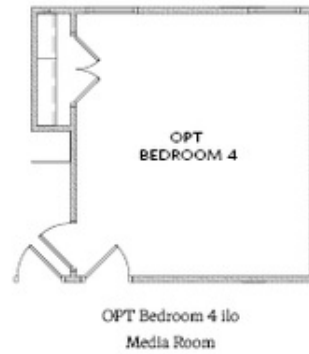

SECOND FLOOR

OPTIONS

Want to Know More  
About This Home?

CONTACT OUR COMMUNITY SALES MANAGER  
Call Us @ 470.462.9178