



PRICED FROM
\$693,900

 **2,963 - 3,005 Sq Ft**

 **4 Beds**

 **3.5 Baths**

 **2 Car Garage**

 **2.0 Story**

- **Stunning Owner's Suite On the Main Level with Large Walk-In Closet And Sitting Room Plus Easy Access to Laundry Room**
- **Owner's Bath features a 2 Sink Vanity, Soaking Tub and Separate Shower**
- **Spacious Gourmet Kitchen Overlooking Breakfast Room, Family Room and Outdoor Patio**
- **Formal Dining Room and Library on Main Level**
- **Upper Level Features Three Additional Bedrooms All with Walk In Closets**
- **Upper Level Flex Space Perfect for Media Room or Secondary Family Room**

[Read More Online](#)

Available Elevations



Elevation A



Elevation D



Elevation F



FIRST FLOOR

Elevation A

Want to Know More
About This Home?

CONTACT OUR COMMUNITY SALES MANAGER
Call Us @ 470.462.9178

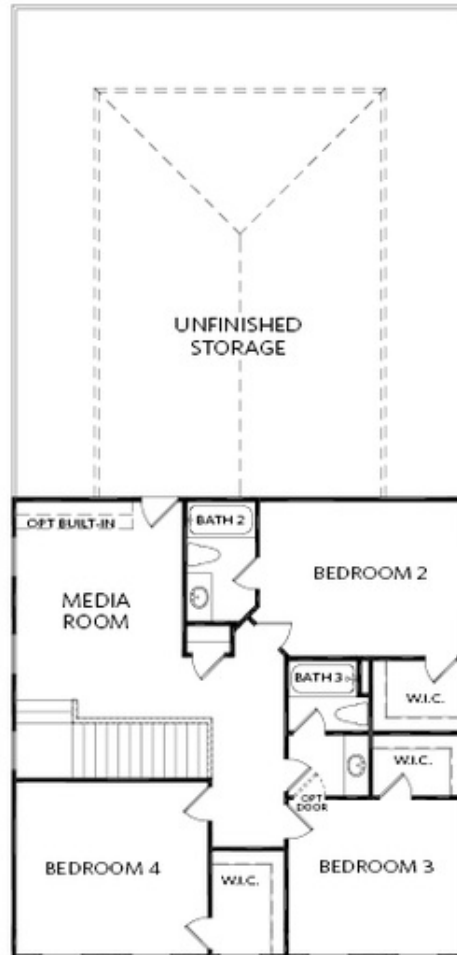

SECOND FLOOR

Elevation A

Want to Know More
About This Home?

CONTACT OUR COMMUNITY SALES MANAGER
Call Us @ 470.462.9178

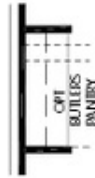

OPT Butler's Pantry

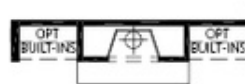

OPT Fireplace



OPT Owner's
Walk-In Shower



OPT Golf Cart Garage

OPTIONS

Want to Know More
About This Home?

CONTACT OUR COMMUNITY SALES MANAGER
Call Us @ 470.462.9178