



PRICED FROM
\$682,900

 2,727 - 2,783 Sq Ft

 3 - 4 Beds

 2.5 - 3.5 Baths

 2 Car Garage

 2.0 Story

- Spacious Owner's Suite and Bath with Dual Vanities, Walk-In Shower and Large Walk-In Closet on Main Level
- Easy access to Laundry Room from Owner's Suite
- Gourmet Kitchen with Island overlooking Dining Area and Family Room
- Double Door Open Up to a Private Study on Main Level
- Powder Bath and Large Pantry off the Mud Room
- Two Secondary Bedrooms with a Jack and Jill Bath, as well as a Loft or Media Room on Upper Level

[Read More Online](#)

Available Elevations



Elevation A



Elevation C



Elevation E



Elevation F

Please refer to actual blueprints for an accurate representation of home design. Home design and elevations subject to change without prior notice. Window, door and porch locations may vary by elevation. Subject to error, omission or withdrawal.



FIRST FLOOR

Elevation A

Want to Know More
About This Home?

CONTACT OUR COMMUNITY SALES MANAGER
Call Us @ 470.462.9178

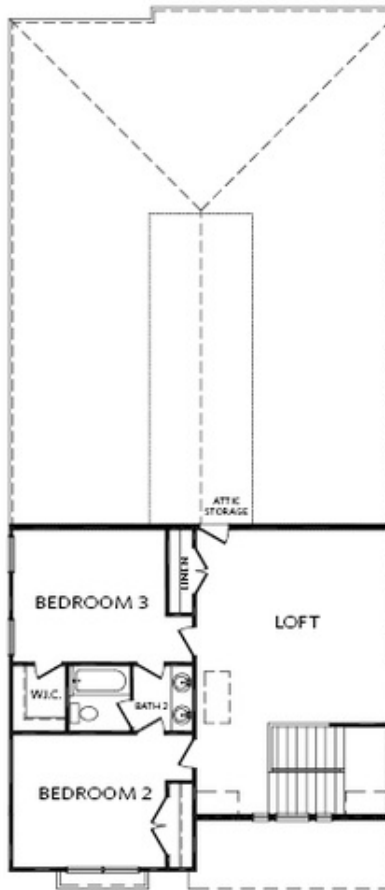

SECOND FLOOR

Elevation A

Want to Know More
About This Home?

CONTACT OUR COMMUNITY SALES MANAGER
Call Us @ 470.462.9178



OPT Sliding Glass Door



OPT Golf Cart Garage



OPT Tub/Shower Combo

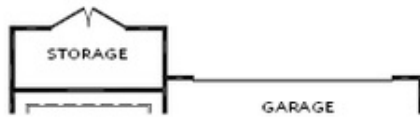

OPT Storage



OPT Larger Shower

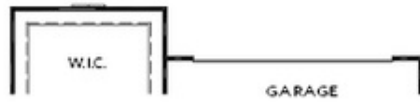

OPT Larger Owner's Closet

OPTIONS FIRST FLOOR

Want to Know More
 About This Home?

CONTACT OUR COMMUNITY SALES MANAGER
 Call Us @ 470.462.9178



OPT Bedroom 4 w/ Full Bath 3



OPT 2nd Powder Room

OPTIONS SECOND FLOOR

Want to Know More
About This Home?

CONTACT OUR COMMUNITY SALES MANAGER
Call Us @ 470.462.9178