



PRICED AT
\$579,750

 2264 Sq Ft

 3 Beds

 3.5 Baths

 2 Car Garage

 3.0 Story

Welcome to WATERHAVEN ~~~ THE PROVIDENCE GROUP's newest community here in Cumming. TO BE BUILT - NORTH FACING building. HURRY and pick your own DESIGN PACKAGE! Receive \$5,000 in Closing Cost when using one of our 5-preferred lenders! Homesite 437 will feature the 3BR/3.5BA Taylor floorplan. This spacious plan has a terrace level private bedroom & bath - perfect for visitors or home office area. The main level living space offers a beautiful open floorplan with kitchen, dining, family room & sunroom that leads to A covered deck. The Taylor kitchen design offers an L shaped island + a 2nd larger island giving you so much counter space for dinner prep & area for bar seating. Features include 42" upper Timberlake cabinets with crown molding, soft close doors & drawers, under cabinet lighting, Beautiful quartz counters, GE Stainless appliance package & Vent Hood. 2 pantry's + a storage closet gives you tons of space for kitchen staples & small appliances. A gas fireplace in the family room creates a cozy atmosphere. Head to the upper floor for the primary suite with sitting room that expands this space. The sitting room has access to an upper deck so you can soak ...

**Want to Know More
About This Home?**

CONTACT OUR COMMUNITY SALES MANAGER
Call Us @ 678.424.6275



Elevation M Floor Plan Layout

Want to Know More
About This Home?

CONTACT OUR COMMUNITY SALES MANAGER
Call Us @ 678.424.6275



Elevation M Floor Plan Layout

Want to Know More
About This Home?

CONTACT OUR COMMUNITY SALES MANAGER
Call Us @ 678.424.6275



Elevation M Floor Plan Layout

Want to Know More
About This Home?

CONTACT OUR COMMUNITY SALES MANAGER
Call Us @ 678.424.6275

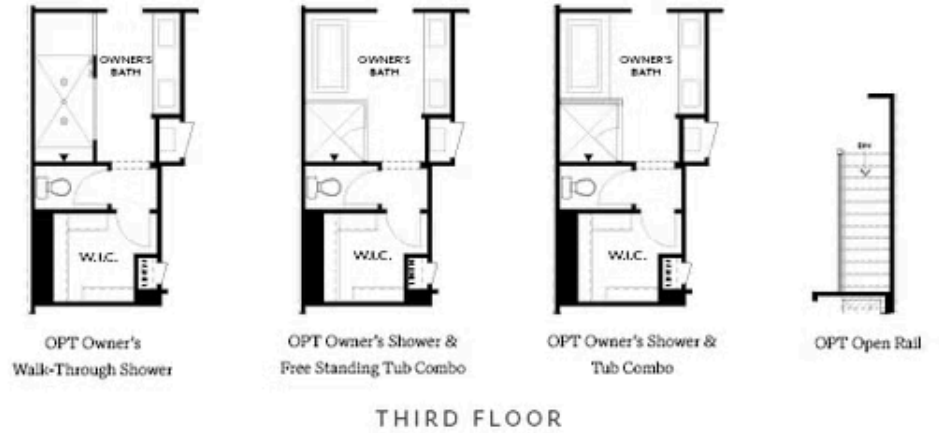

Want to Know More
 About This Home?

CONTACT OUR COMMUNITY SALES MANAGER
 Call Us @ 678.424.6275