



PRICED AT
\$578,670

 2264 Sq Ft

 3 Beds

 3.5 Baths

 2 Car Garage

 3.0 Story

Welcome to WATERHAVEN ~~~ THE PROVIDENCE GROUP's newest community here in Cumming. ELEVATE YOUR SAVINGS with \$7,500 Promotion can be used towards Closing Cost or upgraded design options when you use one of our Preferred Lenders. READY NOW! Homesite 329 offers a fenced front courtyard with a private gate that leads the Taylor 3BR/3.5BA plan. A welcoming foyer entrance on the terrace level leads to a full bedroom on bath ~ great for a guest retreat or home office. Hardwood stair treads lead to the 2nd floor open floorplan. This main floor living space has 10' ceilings 7 hardwood floors throughout creating a very spacious area. The kitchen features white cabinets with soft close doors & drawers, under cabinet lighting & upgraded gold hardware. An L shaped island gives space for a couple of barstools while the 2nd larger island is a great spot for food prep & is illuminated by 2 pretty pendant lights. Stainless GE appliances & vent hood are classic additions to the kitchen space. A dining area is centrally located between the kitchen & family room. A cozy fireplace is the focal point & adds tons of charm to the family room. A sunroom is at ...

**Want to Know More
About This Home?**

CONTACT OUR COMMUNITY SALES MANAGER
Call Us @ 678.424.6275



Elevation M Floor Plan Layout

Want to Know More
About This Home?

CONTACT OUR COMMUNITY SALES MANAGER
Call Us @ 678.424.6275



Elevation M Floor Plan Layout

Want to Know More
About This Home?

CONTACT OUR COMMUNITY SALES MANAGER
Call Us @ 678.424.6275



Elevation M Floor Plan Layout

Want to Know More
About This Home?

CONTACT OUR COMMUNITY SALES MANAGER
Call Us @ 678.424.6275

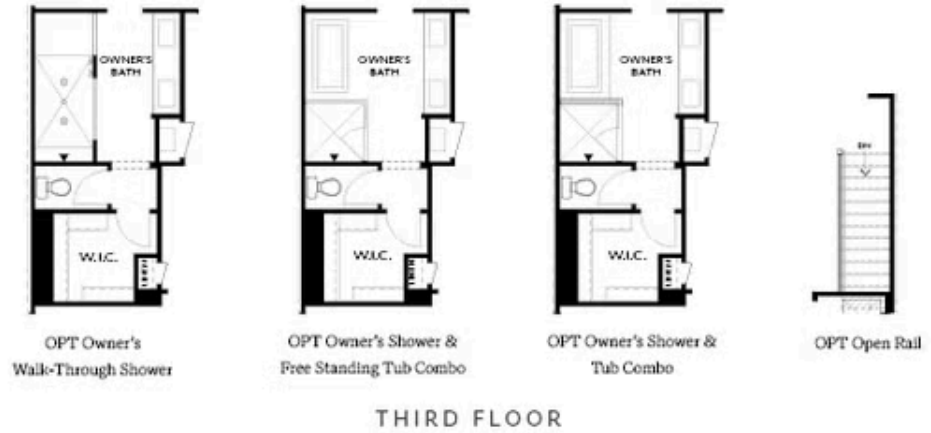

Want to Know More
 About This Home?

CONTACT OUR COMMUNITY SALES MANAGER
 Call Us @ 678.424.6275