



PRICED AT
\$545,900

 2264 Sq Ft

 3 Beds

 3.5 Baths

 2 Car Garage

 3.0 Story

~~~ MOVE IN READY TAYLOR 3 BEDROOM TOWNHOME ~~ WATERHAVEN ~~~ Welcome to THE PROVIDENCE GROUP's newest community here in Cumming where sought out schools and shopping are part of your new lifestyle. - . Discover The Taylor by The Providence Group. \$5,000 closing cost with Preferred Lender(s). This new townhome plan is sure to encourage you to make space for life. Open concept living and soft gray color pallet throughout allowing you to add any design style that showcases your personality. This 3-story home offers a Terrace level bedroom with en-suite bath and upgraded walk-in-shower perfect for office space, roommate style living or guest suite for friends and family. Sunroom off the Family Room great for added lounge space, play area or office set up. Large Kitchen and upgraded GE Profile Stainless Steel appliance package sets you up to serve your secret family recipe. Deck off the Sunroom in the rear to sip your morning coffee and watch the sun come up. Third floor offers a Secondary Bedroom with en-suite bath for privacy. Owner's Suite includes a SITTING ROOM with DECK so star gazing just became easier. Your Owner's Bath has large shower, double vanity and HUGE WALK-IN CLOSET! Welcome ...

**Want to Know More  
About This Home?**

CONTACT OUR COMMUNITY SALES MANAGER  
Call Us @ 678.424.6275



Elevation M Floor Plan Layout

Want to Know More  
About This Home?

CONTACT OUR COMMUNITY SALES MANAGER  
Call Us @ 678.424.6275



Elevation M Floor Plan Layout

Want to Know More  
About This Home?

CONTACT OUR COMMUNITY SALES MANAGER  
Call Us @ 678.424.6275



Elevation M Floor Plan Layout

Want to Know More  
About This Home?

CONTACT OUR COMMUNITY SALES MANAGER  
Call Us @ 678.424.6275

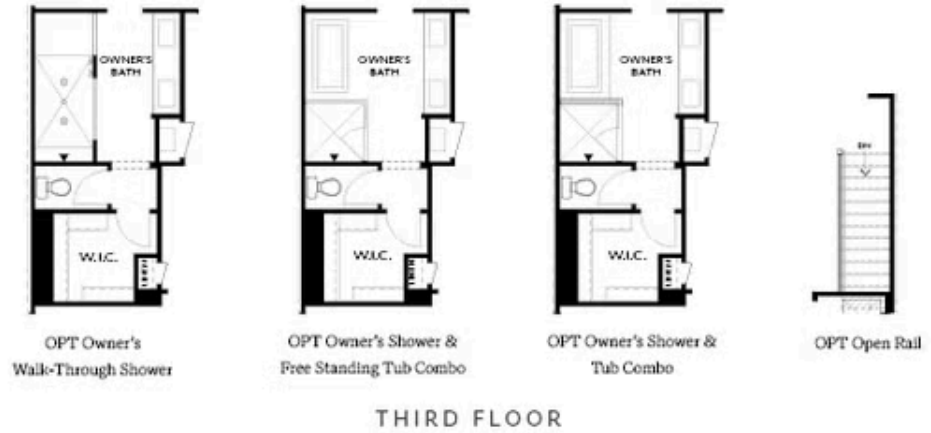

Want to Know More  
 About This Home?

CONTACT OUR COMMUNITY SALES MANAGER  
 Call Us @ 678.424.6275