



PRICED AT
\$519,900

 2264 Sq Ft

 3 Beds

 3.5 Baths

 2 Car Garage

 3.0 Story

INTRODUCING OUR BEST PRICING @ WATERHAVEN ~~~ THE PROVIDENCE GROUP's newest community here in Cumming. READY NOW! AMENITIES NOW OPEN! Homesite 323 - The Taylor I - features a beautifully landscaped, fenced in front yard that leads you into your new home here at Waterhaven. Upon entering the home you will find the entrance on the terrace level leading into a full bedroom with private bath and walk in shower ~ great for a guest retreat or home office. Hardwood stair treads lead to the 2nd floor open floorplan. This main floor living space has 10' ceilings and pre engineered floors throughout creating a very spacious area. The kitchen features white cabinets with soft close doors & drawers, quartz countertops, under cabinet lighting & tile backsplash. An L shaped island gives space for a few barstools while the 2nd larger island is a great spot for food prep & is illuminated by 2 gorgeous pendant lights. Stainless GE appliances & vent hood are classic additions to the kitchen space. A dining area is centrally located between the kitchen & family room. A cozy fireplace is the focal point & adds tons of charm to the family room. A sunroom is ...

**Want to Know More
About This Home?**

CONTACT OUR COMMUNITY SALES MANAGER
Call Us @ 678.424.6275



Elevation M Floor Plan Layout

Want to Know More
About This Home?

CONTACT OUR COMMUNITY SALES MANAGER
Call Us @ 678.424.6275



Elevation M Floor Plan Layout

Want to Know More
About This Home?

CONTACT OUR COMMUNITY SALES MANAGER
Call Us @ 678.424.6275



Elevation M Floor Plan Layout

Want to Know More
About This Home?

CONTACT OUR COMMUNITY SALES MANAGER
Call Us @ 678.424.6275

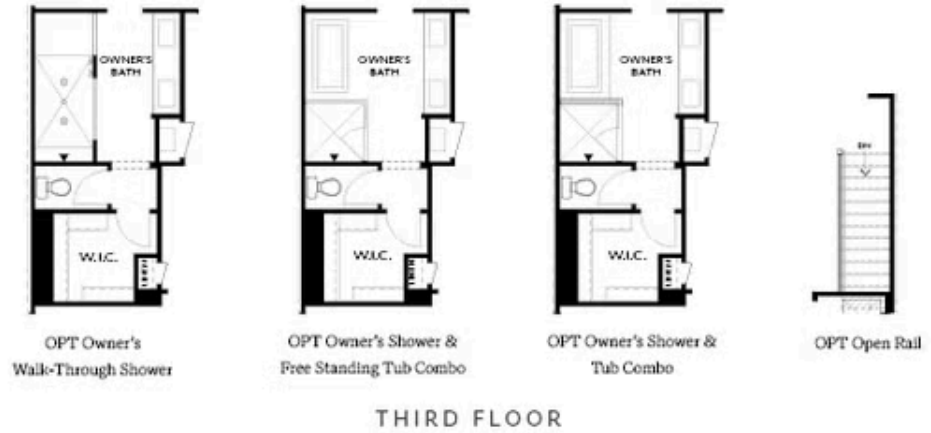
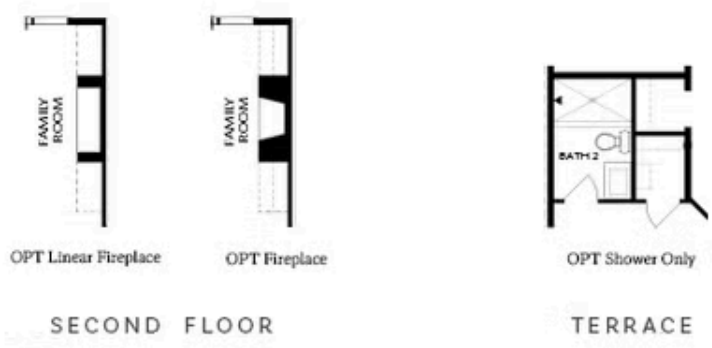

Want to Know More
 About This Home?

CONTACT OUR COMMUNITY SALES MANAGER
 Call Us @ 678.424.6275