



PRICED FROM
\$534,900

 2,264 Sq Ft

 3 Beds

 3.5 Baths

 2 Car Garage

 3.0 Story

- Terrace-Level Bedroom with Full Bath ideal for guests or a private home office
- Open Second-Floor Living Level designed for everyday living and entertaining
- L-Shaped Gourmet Kitchen with generous storage and workspace
- Sunroom and Private Deck extending the main living area outdoors
- Third-Level Owner's Suite offering privacy and separation from main living spaces
- Owner's Sitting Room creating a quiet retreat within the suite
- Private Owner's Deck for relaxed outdoor enjoyment

• Owner's Bath with an inspired layout options

[Read More Online](#)

Available Elevations



Grayson III - Benton III - Taylor I - Townhome Building



Elevation M Floor Plan Layout

Want to Know More
About This Home?

CONTACT OUR COMMUNITY SALES MANAGER
Call Us @ 678.424.6275



Elevation M Floor Plan Layout

Want to Know More
About This Home?

CONTACT OUR COMMUNITY SALES MANAGER
Call Us @ 678.424.6275



Elevation M Floor Plan Layout

Want to Know More
About This Home?

CONTACT OUR COMMUNITY SALES MANAGER
Call Us @ 678.424.6275

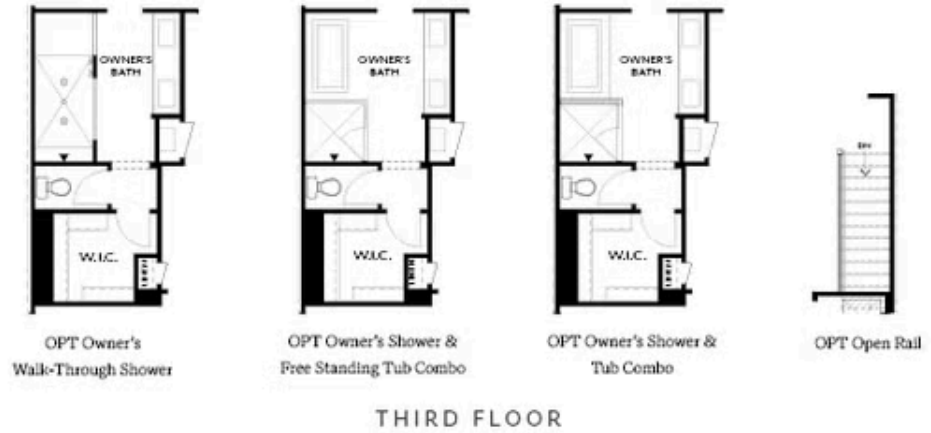

Want to Know More
 About This Home?

CONTACT OUR COMMUNITY SALES MANAGER
 Call Us @ 678.424.6275