



PRICED FROM  
**\$812,400**

 3,472 - 4,192 Sq Ft

 5 - 6 Beds

 4 - 5 Baths

 2 Car Garage

 2.0 - 3.0 Story

- Gourmet Kitchen with Island Overlooking Family Room and Breakfast Room
- Spacious Separate Dining Room
- Huge Owner's Retreat with Elegant Bath with Unique Dual Vanities and Large His and Her Walk-In Closets
- Secondary Bedrooms Feature Private or Shared Full Bath

[Read More Online](#)

## Available Elevations





Want to Know More  
About This Home?

CONTACT OUR COMMUNITY SALES MANAGER  
Call Us @ 470.248.2103

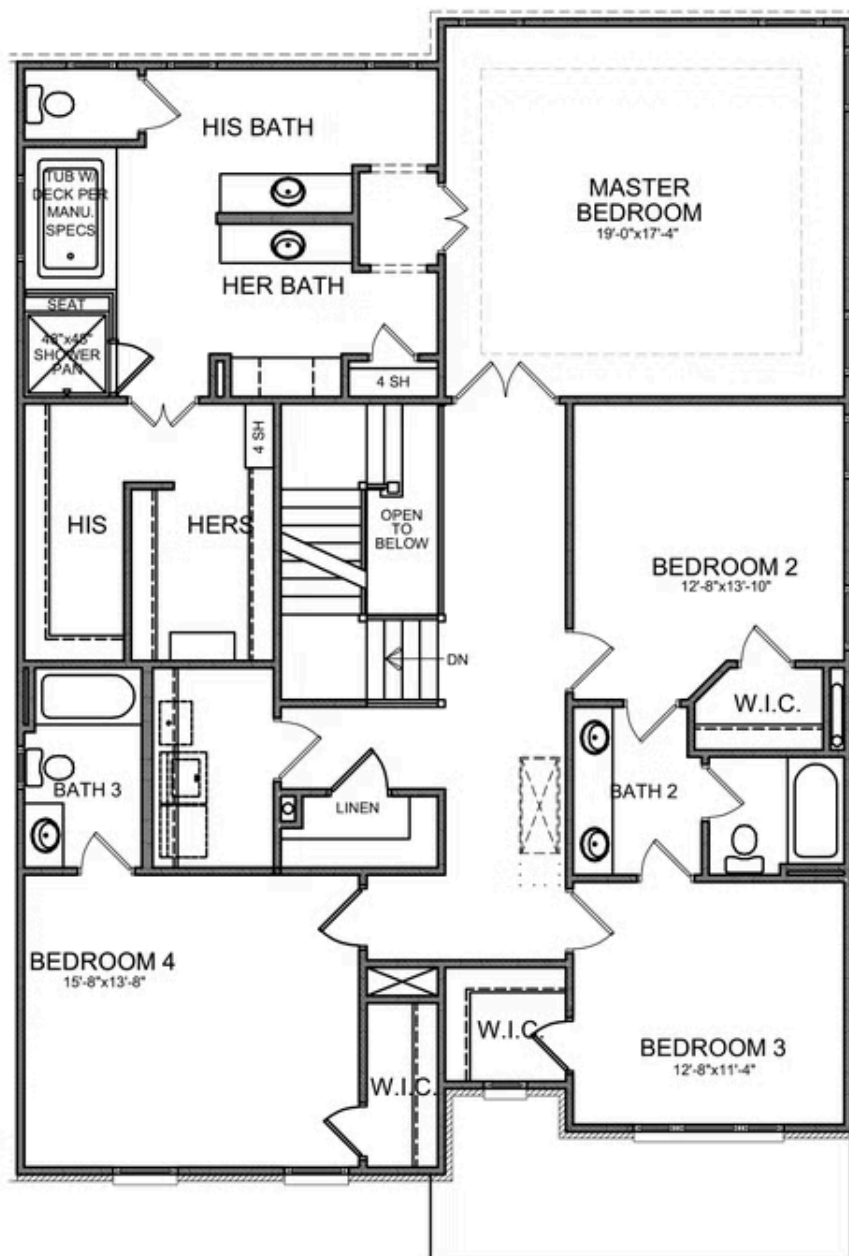

Want to Know More  
About This Home?

CONTACT OUR COMMUNITY SALES MANAGER  
Call Us @ 470.248.2103

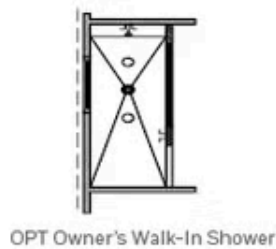

## OPTIONS

Want to Know More  
About This Home?

CONTACT OUR COMMUNITY SALES MANAGER  
Call Us @ 470.248.2103

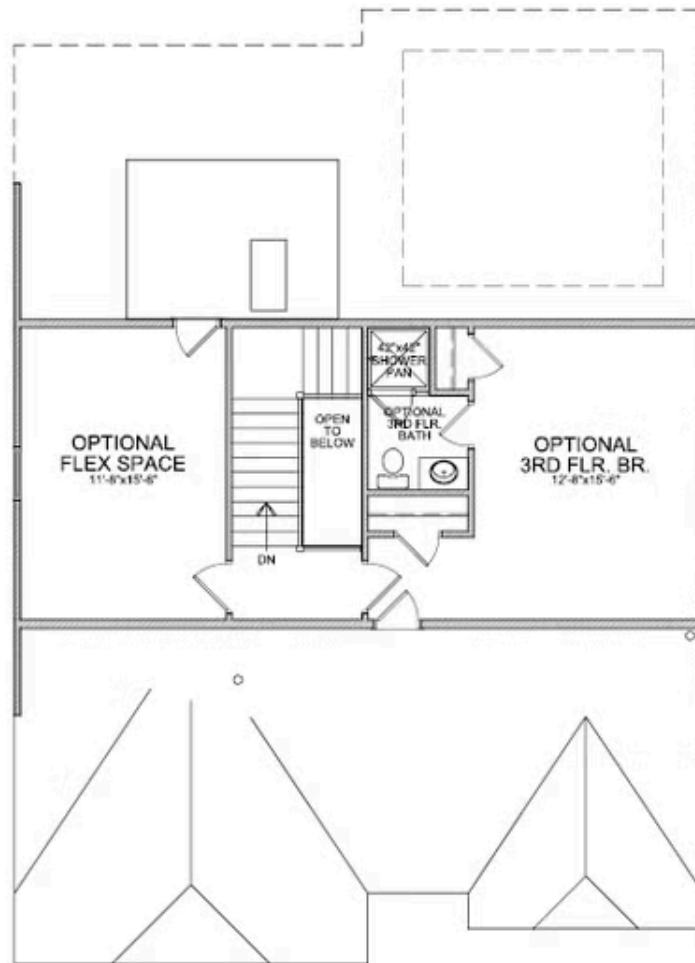

OPT Third Floor

\*Third Floor NOT available on Elevations B & E

Want to Know More  
About This Home?

CONTACT OUR COMMUNITY SALES MANAGER  
Call Us @ 470.248.2103