



PRICED AT  
**\$631,300**

 **2030 Sq Ft**

 **4 Beds**

 **3.5 Baths**

 **2 Car Garage**

 **3.0 Story**

**Fabulous Fall Savings !!! \*\*\*\$15k ANY WAY YOU WANT when purchasing in September and using one of our 5-Preferred Lenders\*\*\* This END UNIT is a great location within the community! Upon entering, you step into a welcoming foyer that seamlessly transitions into the open-concept main floor featuring a family room, kitchen & dining area that is designed to maximize space & foster a sense of connectivity between the different living areas. The family room is the heart of the home. The linear fireplace warms the space creating a cozy atmosphere. Adjacent to the family rooms is the kitchen which is the centerpiece of the open floorplan. The kitchen boasts modern appliances, ample storage & high quality finishes. The white cabinets, quartz countertops, and subway tile backsplash exudes a timeless elegance and a sense of sophistication. The oversized island provides additional workspace & seating. It's a space where functionality meets style, making it a welcoming environment for cooking, dining, and gathering with friends and family. Next to the kitchen is the spacious dining area. Whether it's a quick breakfast before work or a leisurely dinner party, the dining area is versatile enough to accommodate any occasion. A rear deck is accessed ...**

**Want to Know More  
About This Home?**

**CONTACT OUR COMMUNITY SALES MANAGER**  
**Call Us @ 470.248.2103**

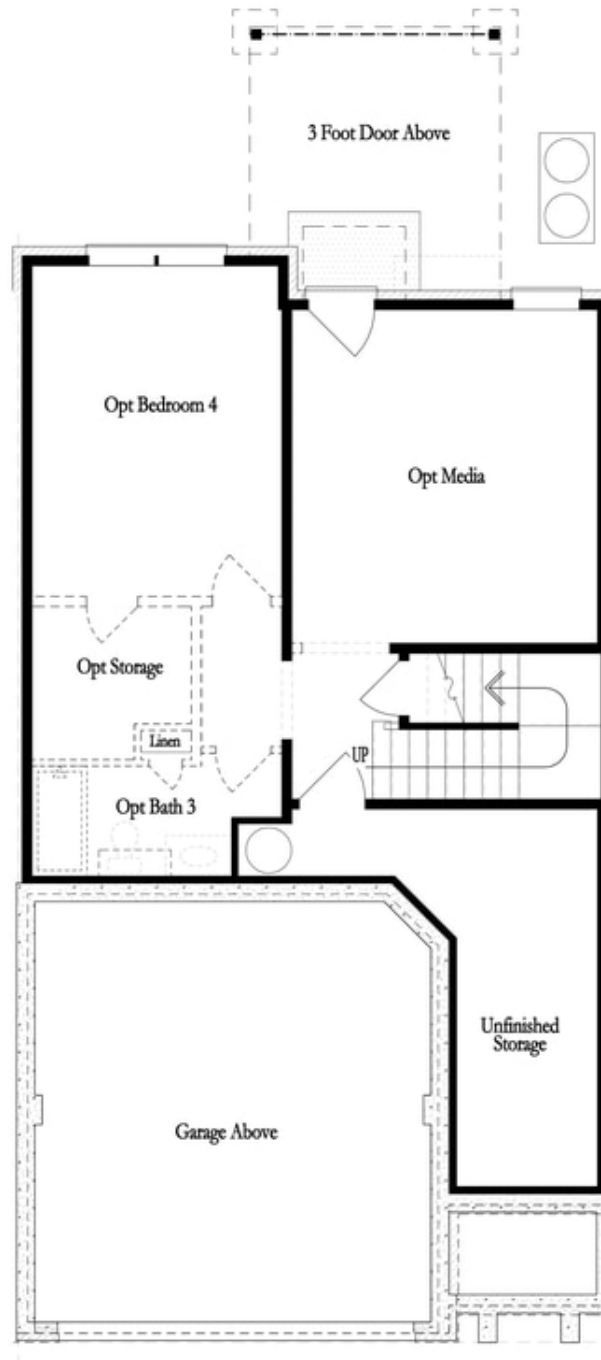

**Want to Know More  
About This Home?**

**CONTACT OUR COMMUNITY SALES MANAGER**  
Call Us @ 470.248.2103

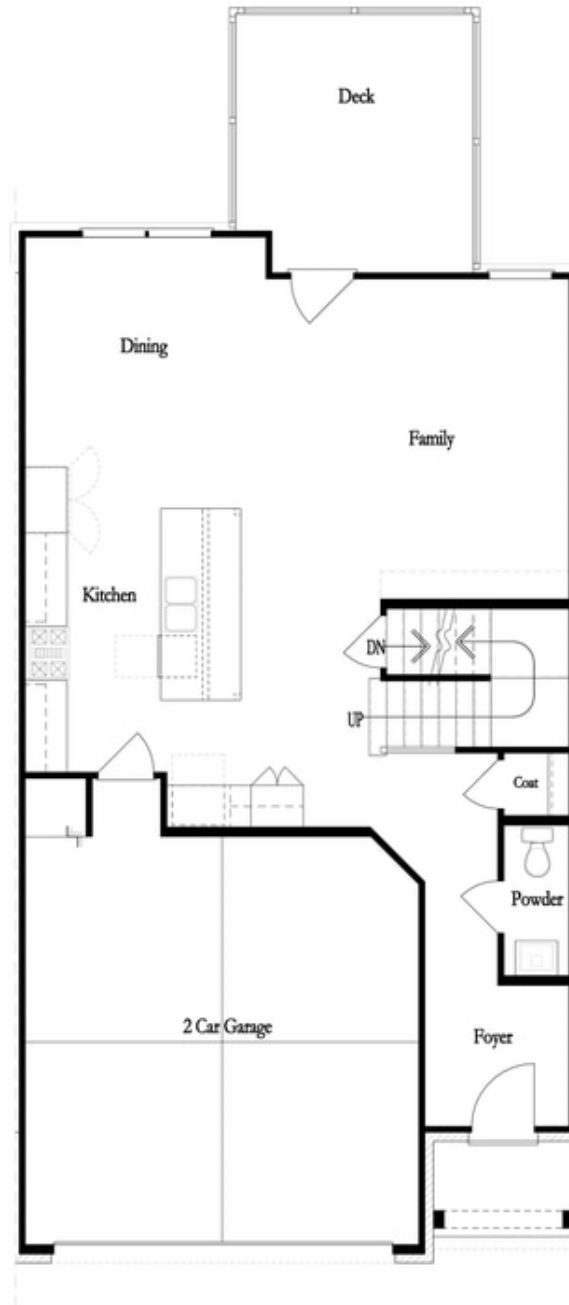

**Want to Know More  
About This Home?**

**CONTACT OUR COMMUNITY SALES MANAGER**  
Call Us @ 470.248.2103

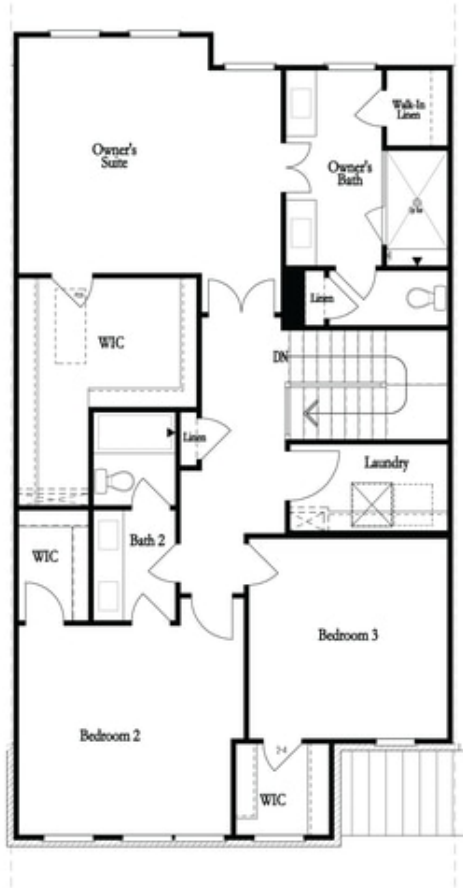

Second Floor - Owner's Rear

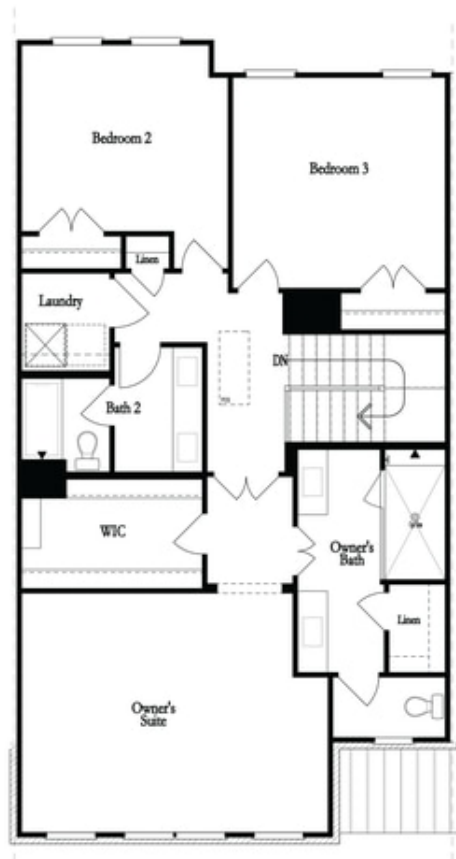

Second Floor - Owner's Front

**Want to Know More  
About This Home?**

**CONTACT OUR COMMUNITY SALES MANAGER**  
Call Us @ 470.248.2103

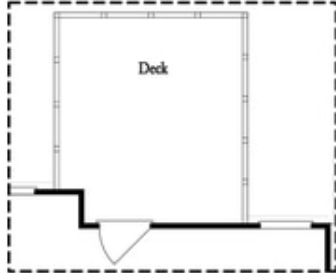

*Opt. Screened Porch*

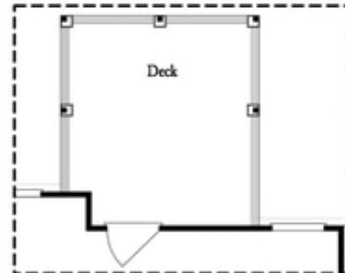

*Opt. Covered Porch*

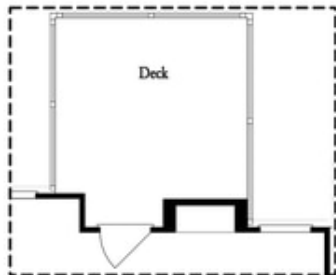

*Opt. Linear Fireplace*

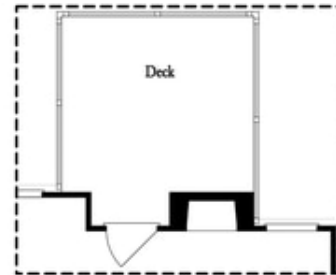

*Opt. Fireplace*

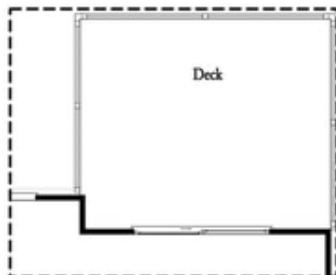

*Opt. 8' Slider Door*

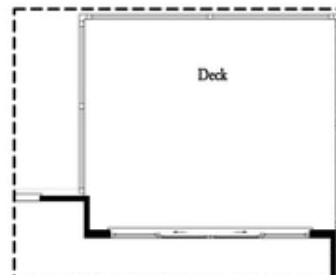

*Opt. 12' Slider*

OPTIONS  
 FIRST FLOOR

**Want to Know More  
 About This Home?**

**CONTACT OUR COMMUNITY SALES MANAGER**  
**Call Us @ 470.248.2103**

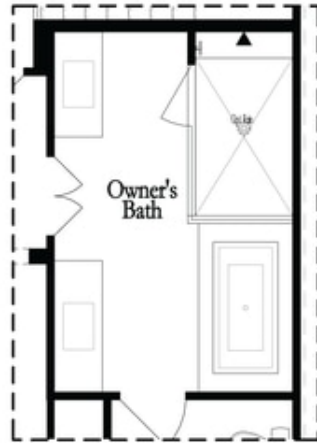

Opt. Shower/Tub

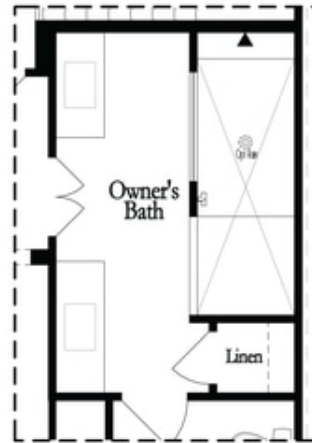

Opt. Walk-Through Shower

Owner's Front - Options

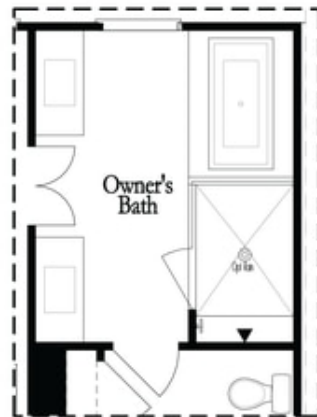

Opt. Shower/Tub

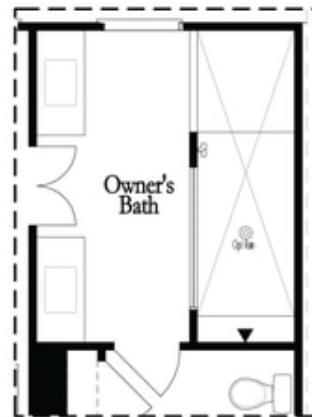

Opt. Walk-Through Shower

Owner's Rear - Options

**Want to Know More  
 About This Home?**

**CONTACT OUR COMMUNITY SALES MANAGER**  
 Call Us @ 470.248.2103