



PRICED AT  
**\$631,300**

 2030 Sq Ft

 4 Beds

 3.5 Baths

 2 Car Garage

 3.0 Story

**Sizzling Summer Savings !!! \*\*\*\$15k ANY WAY YOU WANT** when purchasing in August and using one of our 5-Preferred Lenders\*\*\* This **END UNIT** is a great location within the community! Upon entering, you step into a welcoming foyer that seamlessly transitions into the open-concept main floor featuring a family room, kitchen & dining area that is designed to maximize space & foster a sense of connectivity between the different living areas. The family room is the heart of the home. The linear fireplace warms the space creating a cozy atmosphere. Adjacent to the family rooms is the kitchen which is the centerpiece of the open floorplan. The kitchen boasts modern appliances, ample storage & high quality finishes. The white cabinets, quartz countertops, and subway tile backsplash exudes a timeless elegance and a sense of sophistication. The oversized island provides additional workspace & seating. It's a space where functionality meets style, making it a welcoming environment for cooking, dining, and gathering with friends and family. Next to the kitchen is the spacious dining area. Whether it's a quick breakfast before work or a leisurely dinner party, the dining area is versatile enough to accommodate any occasion. A rear deck is accessed ...

**Want to Know More  
About This Home?**

CONTACT OUR COMMUNITY SALES MANAGER  
Call Us @ 470.248.2103

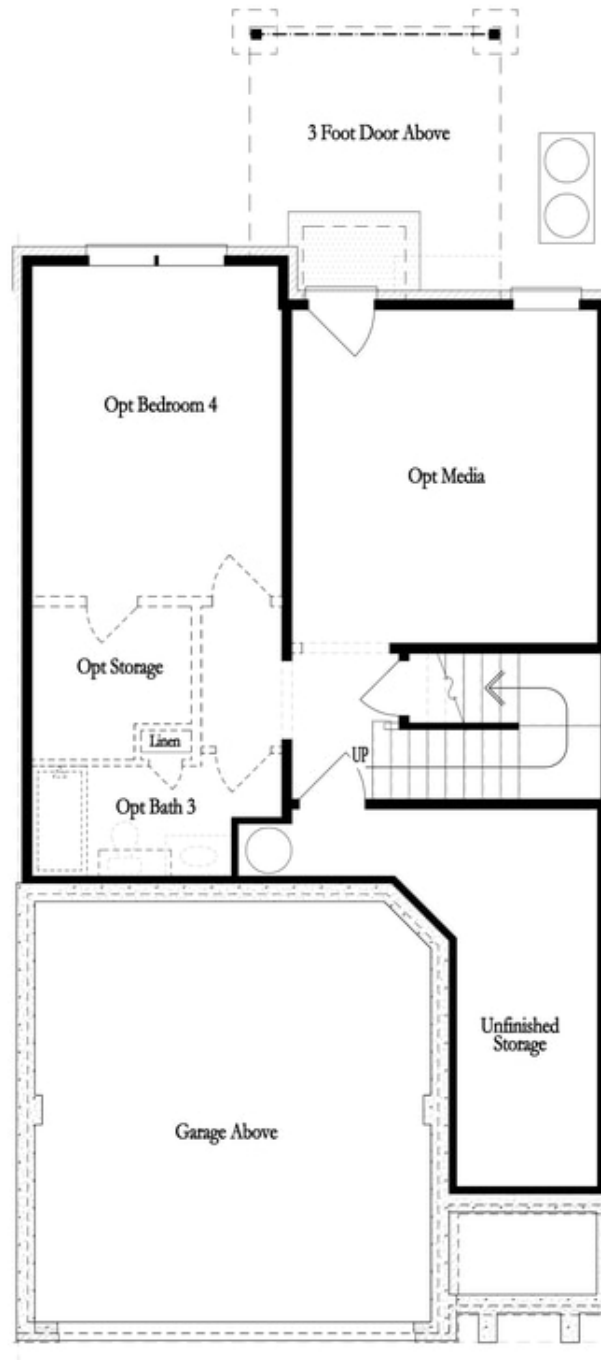

**Want to Know More  
About This Home?**

CONTACT OUR COMMUNITY SALES MANAGER  
Call Us @ 470.248.2103

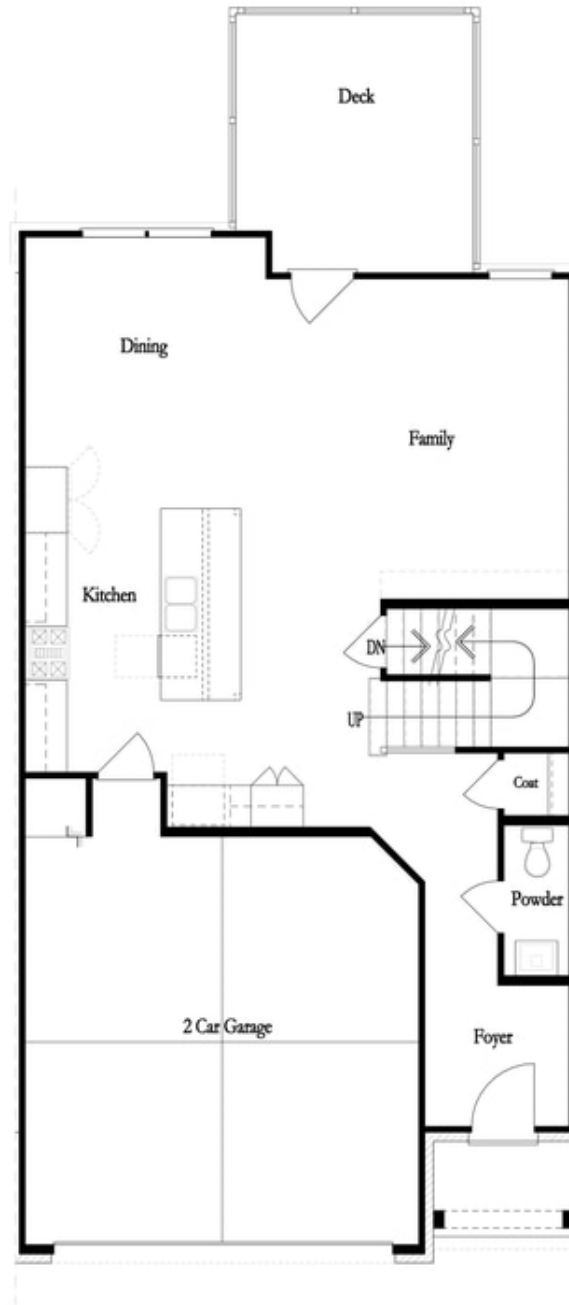

**Want to Know More  
About This Home?**

CONTACT OUR COMMUNITY SALES MANAGER  
Call Us @ 470.248.2103

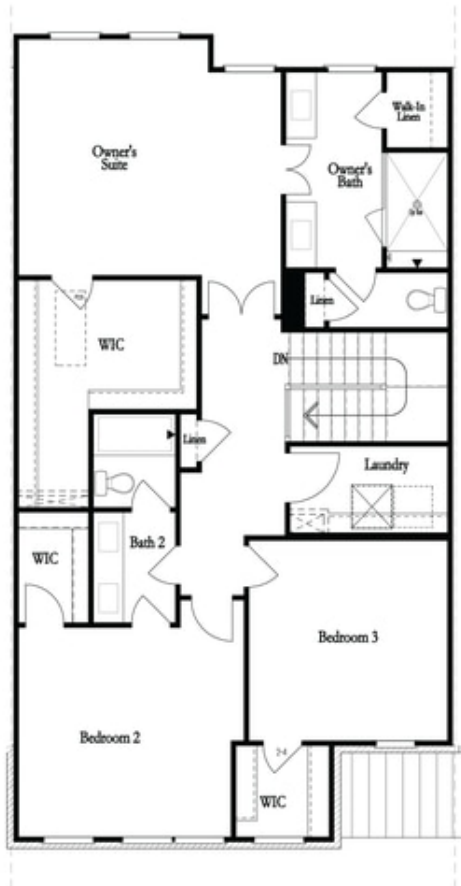

Second Floor - Owner's Rear

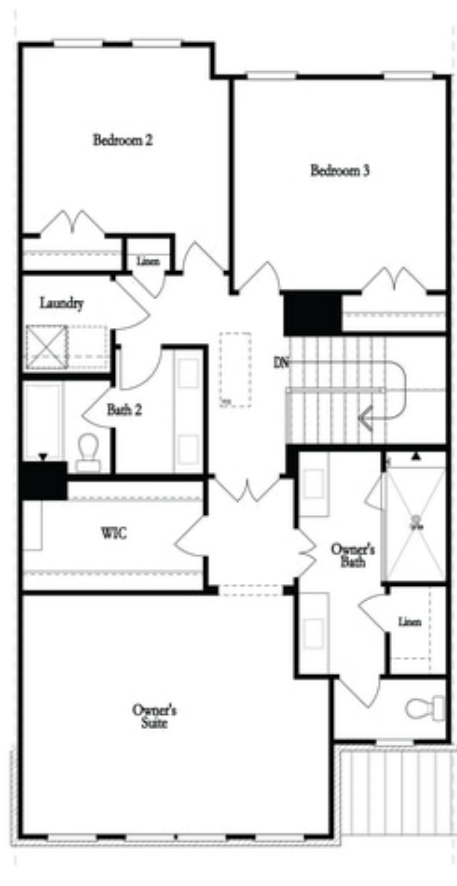

Second Floor - Owner's Front

**Want to Know More  
 About This Home?**

CONTACT OUR COMMUNITY SALES MANAGER  
 Call Us @ 470.248.2103

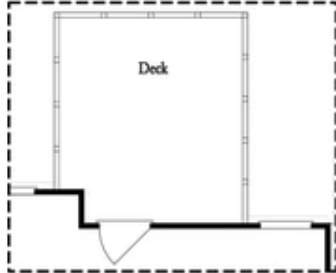

*Opt. Screened Porch*

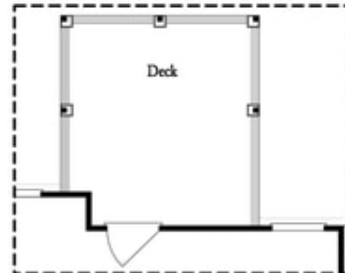

*Opt. Covered Porch*

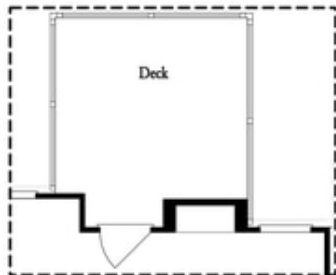

*Opt. Linear Fireplace*

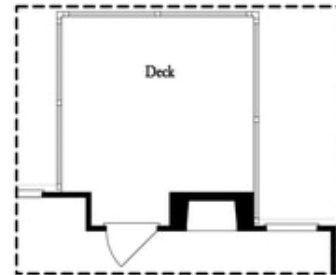

*Opt. Fireplace*

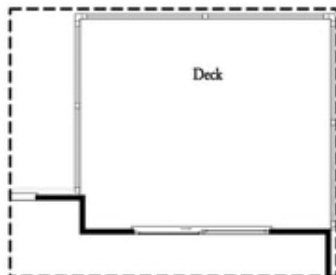

*Opt. 8' Slider Door*

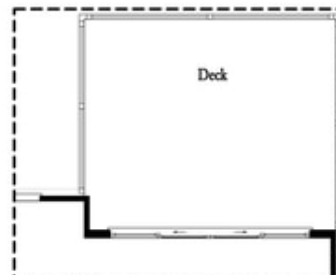

*Opt. 12' Slider*

OPTIONS  
 FIRST FLOOR

**Want to Know More  
 About This Home?**

CONTACT OUR COMMUNITY SALES MANAGER  
 Call Us @ 470.248.2103

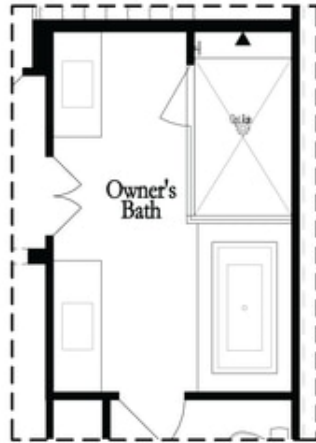

Opt. Shower/Tub

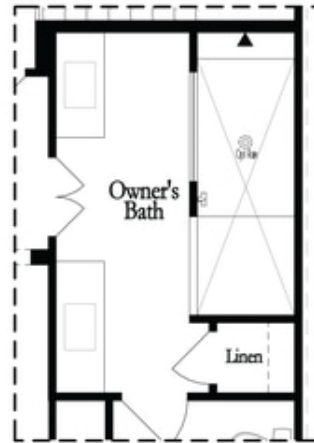

Opt. Walk-Through Shower

Owner's Front - Options

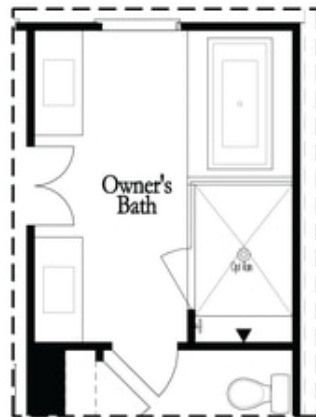

Opt. Shower/Tub

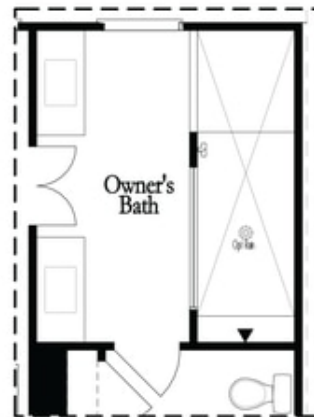

Opt. Walk-Through Shower

Owner's Rear - Options

**Want to Know More  
 About This Home?**

CONTACT OUR COMMUNITY SALES MANAGER  
 Call Us @ 470.248.2103