



PRICED AT
\$592,570

 **2010 Sq Ft**

 **3 Beds**

 **2.5 Baths**

 **2 Car Garage**

 **3.0 Story**

~~~ **NEW YEAR, NEW HOME, NEW YOU!** ~~~ **For a Limited Time Only - PRICE IMPROVEMENT!\*\*\* MOVE IN READY!!!** The Stockton is here built by **THE PROVIDENCE GROUP** to make all your home dreams come true. **OPEN CONCEPT LIVING** offering spacious bedrooms and a kitchen that's sure to impress with a jaw dropping large island and its versatile layout and luxurious amenities, this townhome provides the perfect blend of comfort and style. You'll be captivated by the expansive kitchen and family room. The kitchen boasts warm neutral tones, quartz countertops, a single bowl stainless sink, stainless steel appliances and a stylish tile backsplash, creating a sophisticated and inviting space for cooking and entertaining. Step outside to your **COVERED DECK** and enjoy the sound of the birds chirping and a sunrise morning coffee. On the upper level, the expansive **Owner's Suite** with **HUGE WALK IN CLOSET** awaits, offering a tranquil retreat after a busy day. Indulge in the luxury of the owner's tiled shower washing away the stress of the day. Two additional bedrooms with walk-in closets and a shared bath completes the upper level. The unfinished terrace level presents endless possibilities to adapt to your lifestyle needs. With the HOA ...

**Want to Know More  
About This Home?**

**CONTACT OUR COMMUNITY SALES MANAGER**  
**Call Us @ 470.248.2103**

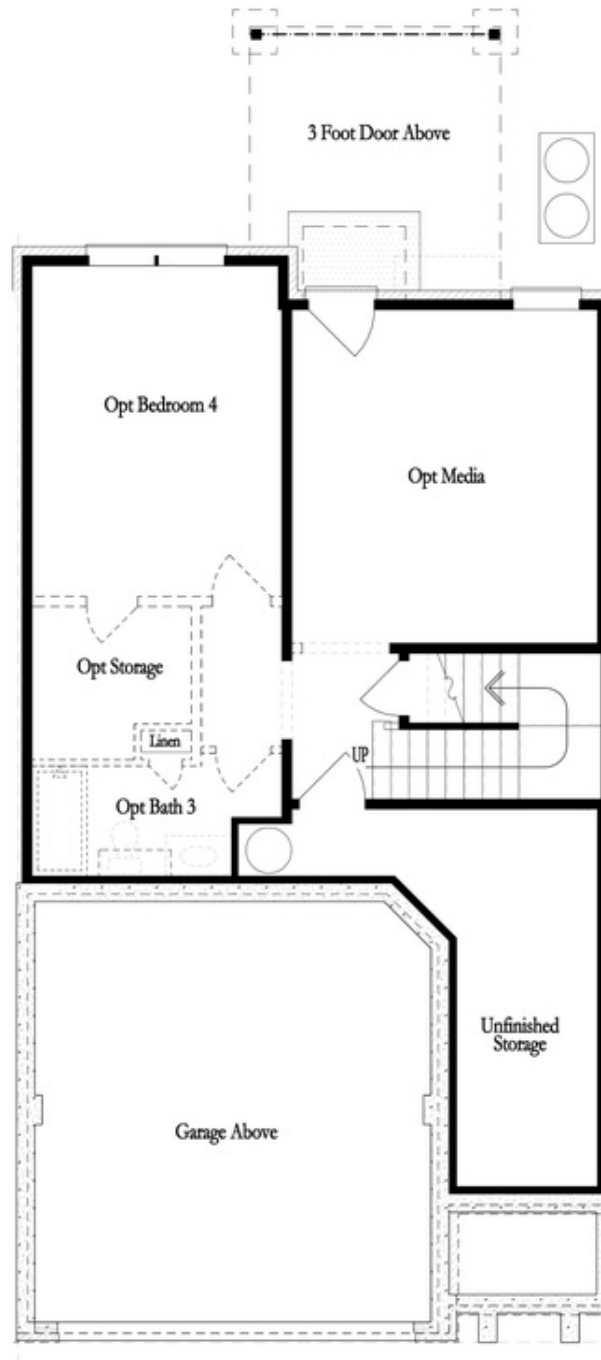

Want to Know More  
About This Home?

CONTACT OUR COMMUNITY SALES MANAGER  
Call Us @ 470.248.2103

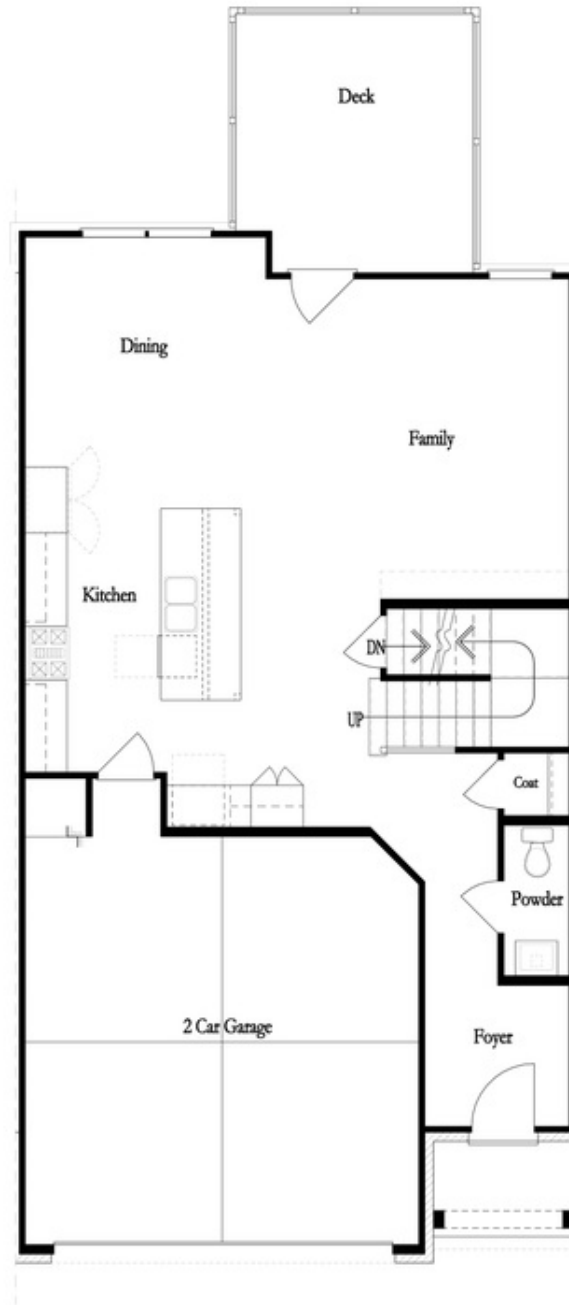

Want to Know More  
About This Home?

CONTACT OUR COMMUNITY SALES MANAGER  
Call Us @ 470.248.2103

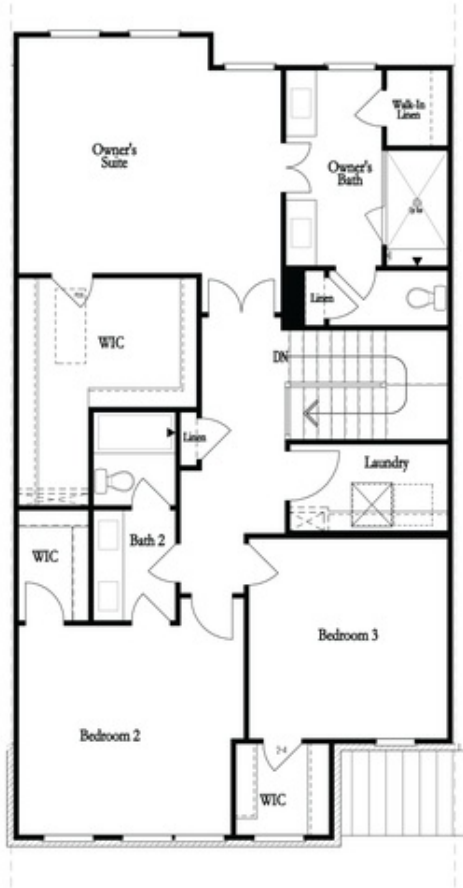

Second Floor - Owner's Rear

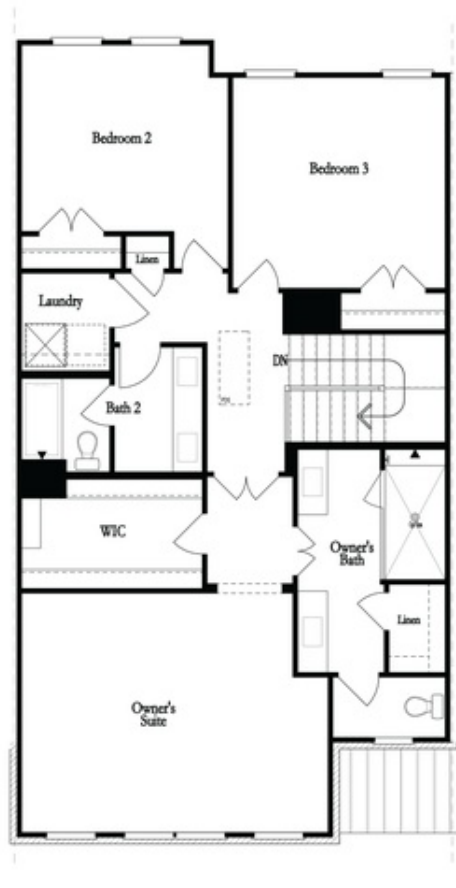

Second Floor - Owner's Front

Want to Know More  
 About This Home?

CONTACT OUR COMMUNITY SALES MANAGER  
 Call Us @ 470.248.2103

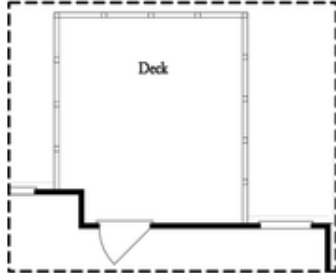

*Opt. Screened Porch*

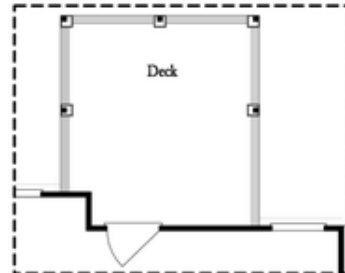

*Opt. Covered Porch*

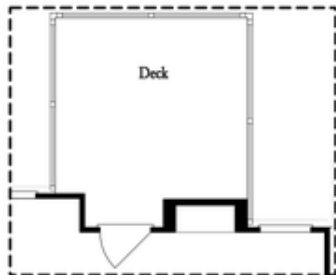

*Opt. Linear Fireplace*

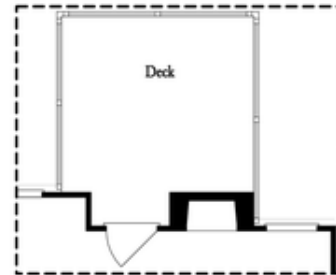

*Opt. Fireplace*

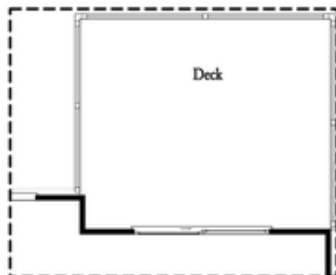

*Opt. 8' Slider Door*

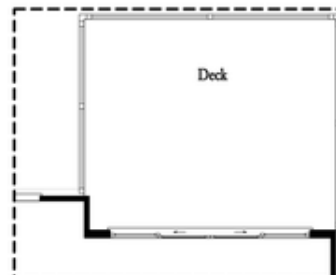

*Opt. 12' Slider*

OPTIONS  
FIRST FLOOR

Want to Know More  
About This Home?

CONTACT OUR COMMUNITY SALES MANAGER  
Call Us @ 470.248.2103

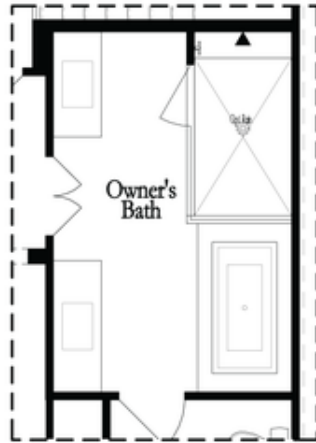

Opt. Shower/Tub

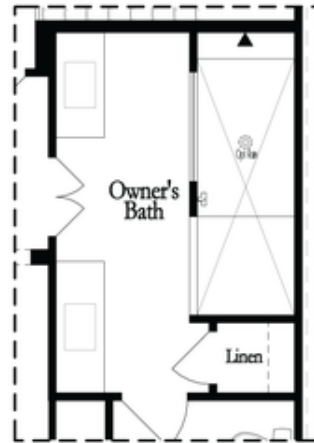

Opt. Walk-Through Shower

Owner's Front - Options

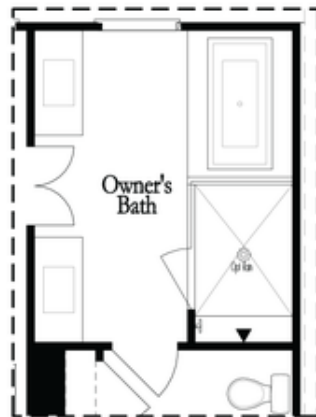

Opt. Shower/Tub

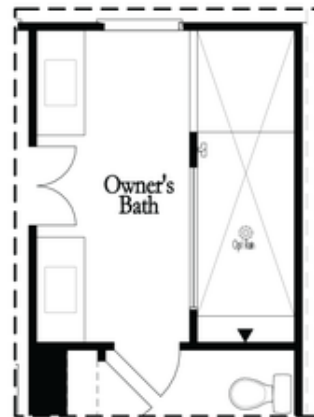

Opt. Walk-Through Shower

Owner's Rear - Options

Want to Know More  
 About This Home?

CONTACT OUR COMMUNITY SALES MANAGER  
 Call Us @ 470.248.2103