





PRICED FROM
\$632,100

 2,010 - 2,676 Sq Ft

 3 - 4 Beds

 2.5 - 3 Baths

 2 Car Garage

 2.0 - 3.0 Story

- Open Main Level with Large Kitchen with Island Overlooking Dining Room, Family Room and Outdoor Living
- Optional Layouts for Owner's Suite
- Owner's Suite with Spacious Bath with Corner Tub, Separate Shower, Separate Vanities and Huge Walk-In Closets
- Secondary Bedrooms Feature Walk-In Closets
- Upper Level Laundry Room
- Finished Basement with Bedroom, Full Bath, & Media Room

[Read More Online](#)

Available Elevations



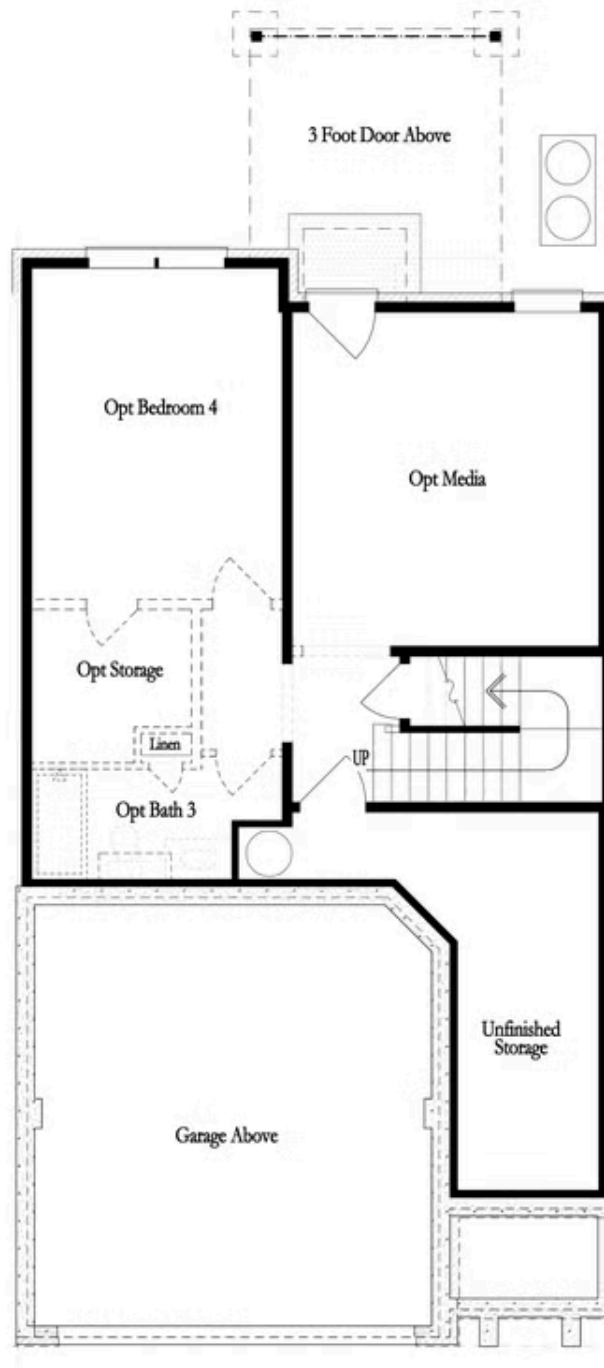

Want to Know More
About This Home?

CONTACT OUR COMMUNITY SALES MANAGER
Call Us @ 470.248.2103

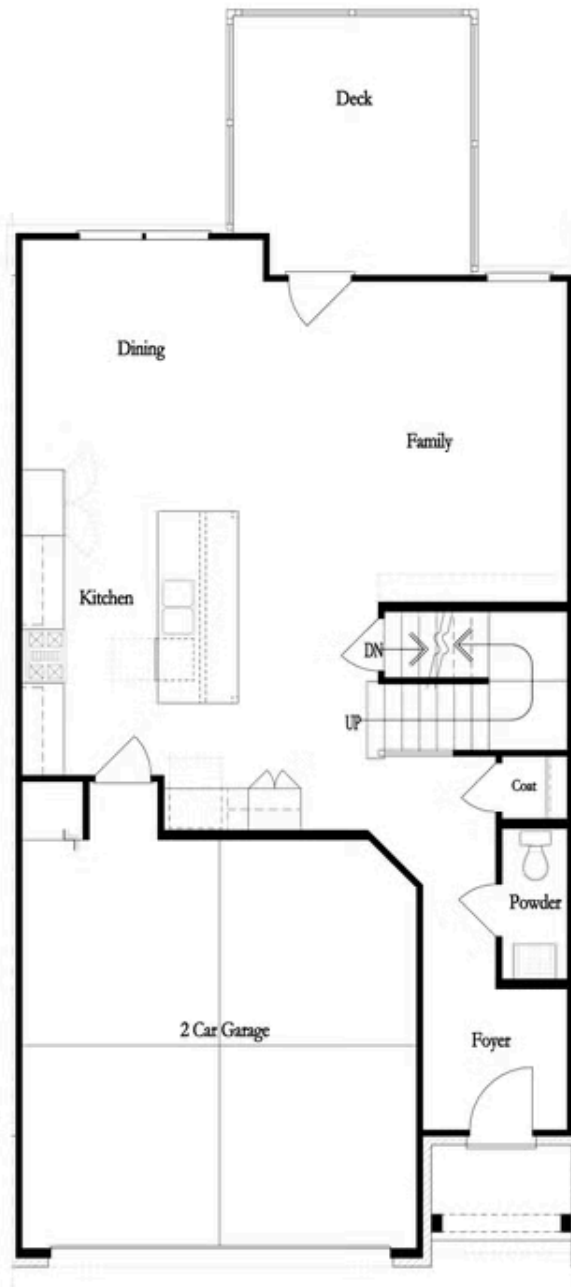

Want to Know More
About This Home?

CONTACT OUR COMMUNITY SALES MANAGER
Call Us @ 470.248.2103



Second Floor
(Owner's Front)

Elevations G, H, J1, J3 & L

Want to Know More
About This Home?

CONTACT OUR COMMUNITY SALES MANAGER
Call Us @ 470.248.2103



Second Floor
(Owner's Rear)

Elevations G, H, J1, J3 & L

Want to Know More
About This Home?

CONTACT OUR COMMUNITY SALES MANAGER
Call Us @ 470.248.2103

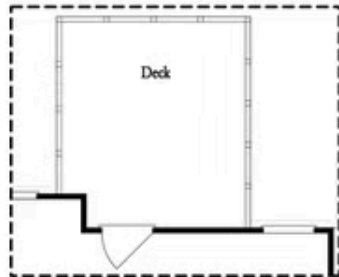

Opt. Screened Porch

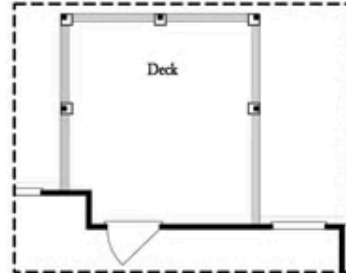

Opt. Covered Porch

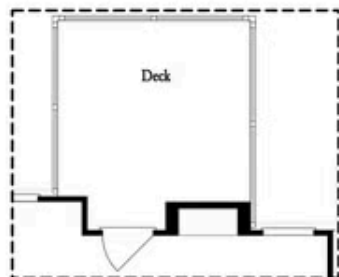

Opt. Linear Fireplace

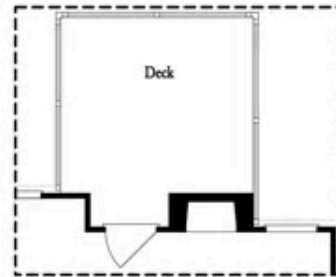

Opt. Fireplace

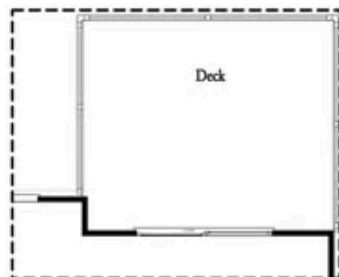

Opt. 8' Slider Door

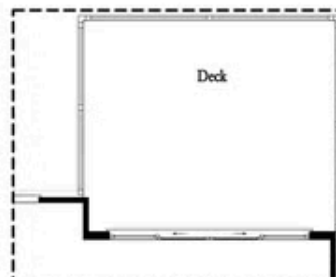

Opt. 12' Slider

OPTIONS
FIRST FLOOR

Want to Know More
About This Home?

CONTACT OUR COMMUNITY SALES MANAGER
Call Us @ 470.248.2103



Opt. Shower/Tub



Opt. Walk-Through Shower

Owner's Front - Options



Opt. Shower/Tub



Opt. Walk-Through Shower

Owner's Rear - Options

Want to Know More
About This Home?

CONTACT OUR COMMUNITY SALES MANAGER
Call Us @ 470.248.2103