



PRICED AT
\$454,800

 1994 Sq Ft

 3 Beds

 3.5 Baths

 2 Car Garage

 3.0 Story

Garwood B By The Providence Group End Unit! Bdrms have their own bthrms! 3 bdrm, 3.5 bath, Split bdrm layout, Master Bthrm has a shower & tub Sunroom, Private front entry, open concept on the main level, stone countertops in kitchen & master bthrm, You can still choose the interior design collection pkg! Great location, w access to interstates, downtown Duluth, shopping, restaurants, & schools. *Home is UNDER CONSTRUCTION & est to be completed in April/May 2022* Pictures are of a previously built home by The Providence Group!

**Want to Know More
About This Home?**

CONTACT OUR COMMUNITY SALES MANAGER
Call Us @ (678) 353-4987



**Want to Know More
About This Home?**

CONTACT OUR COMMUNITY SALES MANAGER
Call Us @ (678) 353-4987

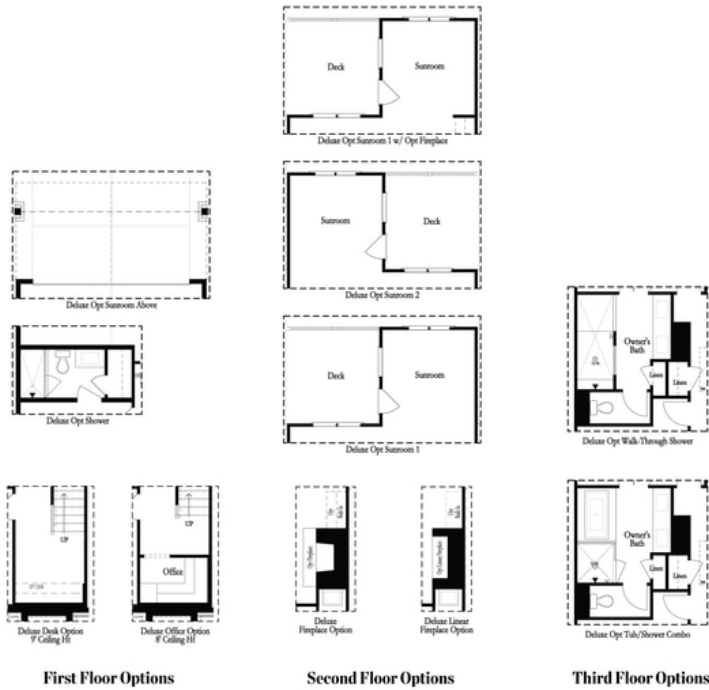

**Want to Know More
 About This Home?**

CONTACT OUR COMMUNITY SALES MANAGER
 Call Us @ (678) 353-4987