



PRICED AT
\$441,000

 1994 Sq Ft

 3 Beds

 3.5 Baths

 2 Car Garage

 3.0 Story

Garwood H - By The Providence Group. Choose your interior design collection pkg! *3 story TH, 3 bdrm, 3.5 bath. A Great Feature of this floor plan is all bdrms have their own bthrms! Master Bath has a HUGE walk in shower. Private front entry leads to an open concept on the main level. Sunroom gives extra entertaining space. Beautiful designer touches with stone countertops in kitchen & master bath. Pictures are of a previously built home by The Providence Group** The perfect location with easy access to interstates, downtown Duluth. Awesome shopping, restaurants & schools nearby. *Home is UNDER CONSTRUCTION & EST to be completed in April/May 2022. *Pictures are of a previously built home by The Providence Group!

**Want to Know More
About This Home?**

CONTACT OUR COMMUNITY SALES MANAGER
Call Us @ (678) 353-4987



Want to Know More
About This Home?

CONTACT OUR COMMUNITY SALES MANAGER
Call Us @ (678) 353-4987

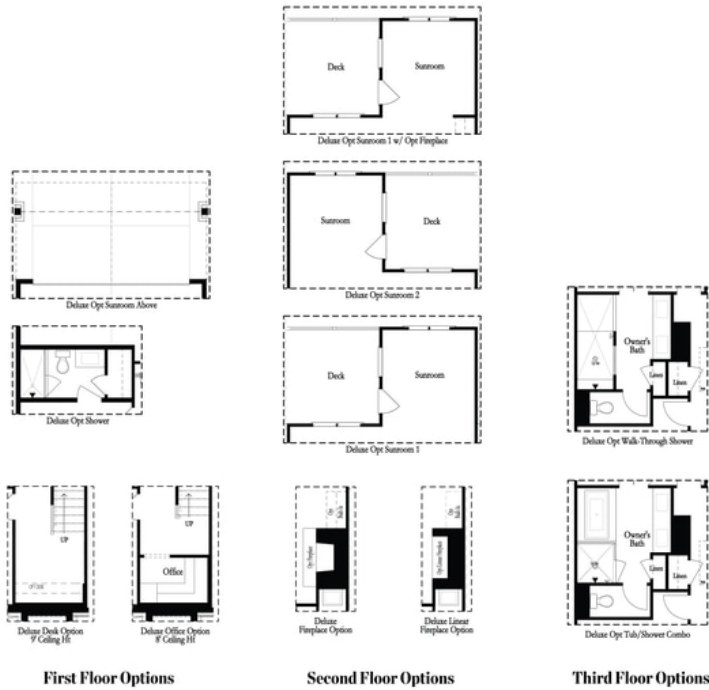

**Want to Know More
 About This Home?**

CONTACT OUR COMMUNITY SALES MANAGER
 Call Us @ (678) 353-4987