



PRICED AT
\$435,900

 **1994 Sq Ft**

 **3 Beds**

 **3.5 Baths**

 **2 Car Garage**

 **3.0 Story**

Garwood B By The Providence Group *END UNIT 3 story TH, 3 bdrm, 3.5 bath. A Great Feature of this floor plan is all bdrms have their own bthrms! Master Bath w/ frameless shower. Sunroom, Private front entry, open concept on the main level, stone countertops in kitchen & master bthrm. You can still choose the interior design collection pkg! Great location, w access to interstates, downtown Duluth, shopping, restaurants & schools. *Home is UNDER CONSTRUCTION & est to be completed in Feb/March 2022. *Pictures are of a previously built home by The Providence Group!

**Want to Know More
About This Home?**

CONTACT OUR COMMUNITY SALES MANAGER
Call Us @ (678) 353-4987



**Want to Know More
About This Home?**

CONTACT OUR COMMUNITY SALES MANAGER
Call Us @ (678) 353-4987

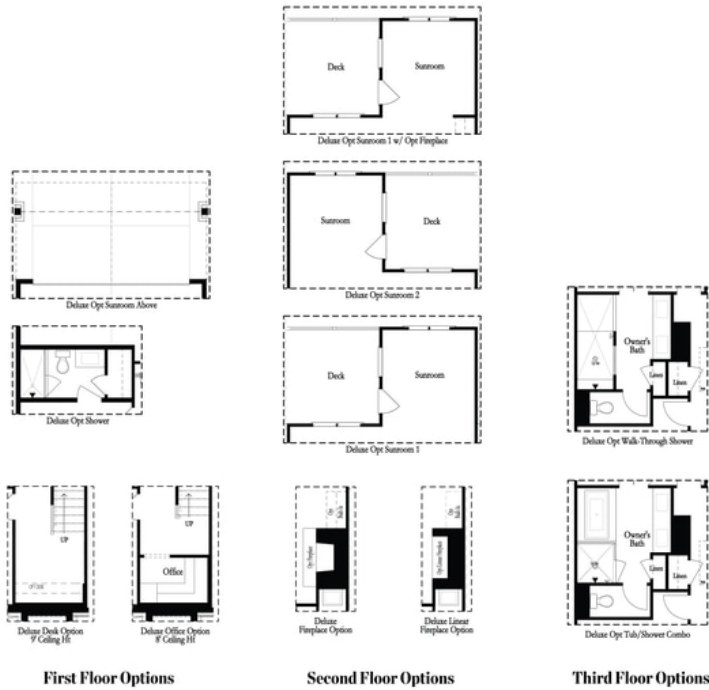

**Want to Know More
 About This Home?**

CONTACT OUR COMMUNITY SALES MANAGER
Call Us @ (678) 353-4987