



PRICED AT
\$539,900

 2018 Sq Ft

 3 Beds

 3.0 Baths

 2 Car Garage

 1.0 Story

BRAND NEW PRICE ON THIS GORGEOUS QUICK MOVE-IN! HOME!! Here at the Aberdeen, The Providence Group's newest community just minutes from downtown Hoschton!!! Discover the Conner plan, a thoughtfully designed new-construction home in Hoschton offering 3 bedrooms and 3 full baths with an open, elegant layout. The dining, family room, and kitchen flow seamlessly together, creating a bright and welcoming main living space. The kitchen features a large island and an impressive walk-in pantry—perfect for well-stocked storage and everyday convenience. The owners suite includes a spacious walk-in closet, plus a beautifully appointed bathroom with separate vanities and a dedicated linen closet. A covered porch extends the living area outdoors for year-round enjoyment. Located in a premier gated community with exceptional amenities, including a clubhouse, fitness center, pickleball courts, fire pit area, greenspaces, sidewalks, and a secure gated entrance, this home offers both luxury and lifestyle in one of Hoschton's most desirable neighborhoods. [Conner]

**Want to Know More
About This Home?**

CONTACT OUR COMMUNITY SALES MANAGER
Call Us @ 470.955.0875



Elevation A

Want to Know More
About This Home?

CONTACT OUR COMMUNITY SALES MANAGER
Call Us @ 470.955.0875



Want to Know More
 About This Home?

CONTACT OUR COMMUNITY SALES MANAGER
 Call Us @ 470.955.0875

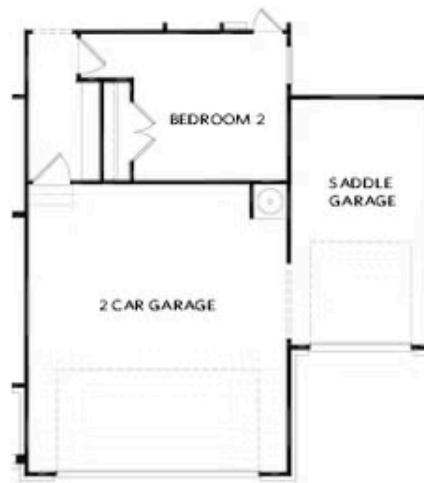

OPT Saddle Garage
*Per Lot Fit

Want to Know More
About This Home?

CONTACT OUR COMMUNITY SALES MANAGER
Call Us @ 470.955.0875