



PRICED FROM  
**\$518,900**

 2,518 - 2,831 Sq Ft

 4 - 5 Beds

 3 - 5 Baths

 2 Car Garage

 2.0 - 3.0 Story

- Classic 2-Story Single-Family Home with Optional 3rd Story
- Open Concept with a view from the Kitchen to the Dining to the Family Room
- L-Shaped Kitchen with seating for 3 at the Large Kitchen Island
- Sliding Glass Door Opens to a Patio off the Family Room - Brings the Outdoors In
- Optional Covered Patio off the Family Room
- Second Floor Features the Owner's Suite, a Loft/Flex Area and Two Secondary Bedrooms
- Optional 3rd Floor Adds a 5th Bedroom and Full Bath

• 2 Car Front Entry Garage

[Read More Online](#)

## Available Elevations





Elevation C

Want to Know More  
About This Home?

CONTACT OUR COMMUNITY SALES MANAGER  
Call Us @ 470.955.0875



Elevation C

Want to Know More  
About This Home?

CONTACT OUR COMMUNITY SALES MANAGER  
Call Us @ 470.955.0875



Elevation D

Want to Know More  
About This Home?

CONTACT OUR COMMUNITY SALES MANAGER  
Call Us @ 470.955.0875



Elevation C & D

Want to Know More  
About This Home?

CONTACT OUR COMMUNITY SALES MANAGER  
Call Us @ 470.955.0875



OPT Fireplace

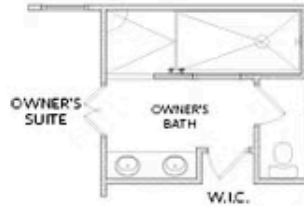

OPT Owner's  
 Walk-In Shower



OPT Second Floor 3rd Bath  
 When NO Third Floor is Selected

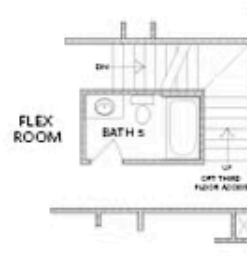

OPT Second Floor 3rd Bath  
 When OPT Third Floor is Selected

Want to Know More  
 About This Home?

CONTACT OUR COMMUNITY SALES MANAGER  
 Call Us @ 470.955.0875