



PRICED FROM  
**\$504,900**

 2,016 Sq Ft

 3 - 4 Beds

 2.5 - 3.5 Baths

 2 Car Garage

 2.0 Story

- Thoughtfully designed living space
- Open-concept main living area ideal for entertaining and everyday comfort
- Spacious owner's suite featuring a large walk-in closet and a private bath with dual vanities
- Conveniently located laundry room on main floor
- Versatile loft space on the second floor—perfect for a media room, home office, or play area
- Optional fourth bedroom and bath for added flexibility
- Well-appointed kitchen and dining area that flows seamlessly into the family room
- Optional fireplace to enhance the family room atmosphere

[Read More Online](#)

## Available Elevations



Elevation A



Elevation B



Elevation A

Want to Know More  
About This Home?

CONTACT OUR COMMUNITY SALES MANAGER  
Call Us @ 470.955.0875



Elevation A

Want to Know More  
About This Home?

CONTACT OUR COMMUNITY SALES MANAGER  
Call Us @ 470.955.0875



OPT Zero-Threshold Shower



OPT Bedroom 4 & Bath 3 ilo Loft



OPT Linear Fireplace

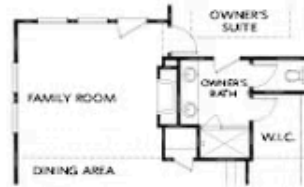

OPT Fireplace

Want to Know More  
About This Home?

CONTACT OUR COMMUNITY SALES MANAGER  
Call Us @ 470.955.0875