



PRICED FROM
\$558,900

 2,255 - 2,495 Sq Ft

 3 Beds

 2.5 Baths

 2 Car Garage

 2.0 Story

- Gourmet Kitchen with Large Island overlooking Family Room
- Laundry and separate Dining Room on Main Level
- Additional 2 Bedrooms and Office/Loft Space on Upper Level
- Two-Car Front Entry Garage

[Read More Online](#)

Available Elevations





Elevation A, B, C

Want to Know More
About This Home?

CONTACT OUR COMMUNITY SALES MANAGER
Call Us @ 470.955.0875

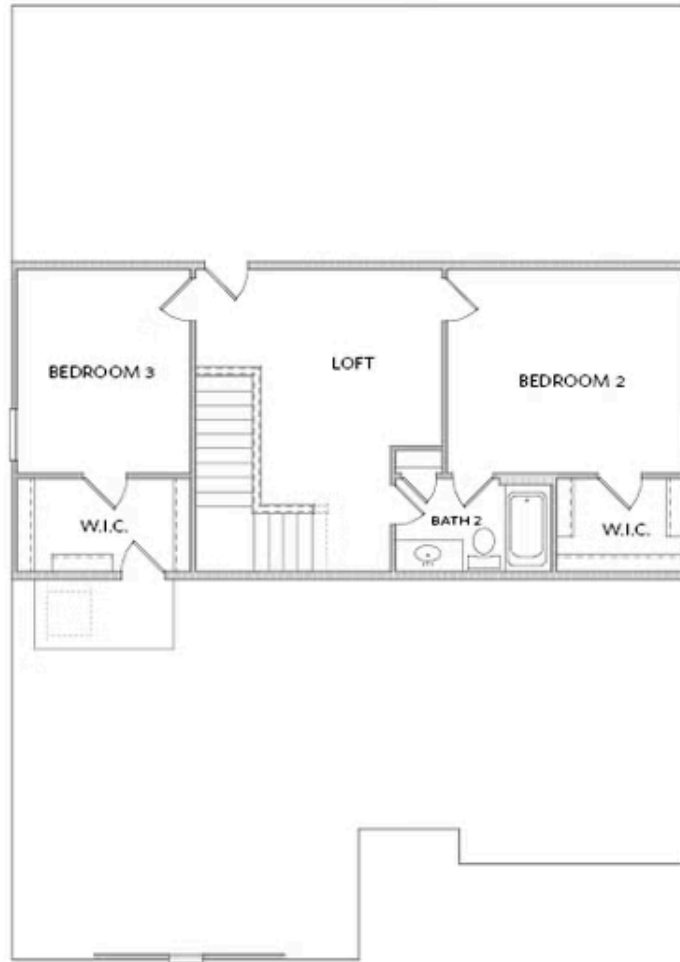

Elevation A, B, C

Want to Know More
About This Home?

CONTACT OUR COMMUNITY SALES MANAGER
Call Us @ 470.955.0875



OPT Sitting Room off Rear of Owner's Suite



OPT Covered Porch



OPT Sunroom Includes Side Patio

Want to Know More
About This Home?

CONTACT OUR COMMUNITY SALES MANAGER
Call Us @ 470.955.0875