



PRICED FROM  
**\$494,900**

 2,006 Sq Ft

 2 - 3 Beds

 2.5 - 3 Baths

 2 Car Garage

 2.0 Story

- Two-Story Villa Design with architectural depth
- Owner's Bedroom on the Main Level for everyday convenience
- Vaulted Ceilings in the Family Room for an open, light-filled feel
- Gourmet Kitchen open to the main living areas
- 2-3 Bedroom Options to suit your lifestyle
- Second-Floor Bedroom with optional Loft
- First-Floor Flex Room ideal for a home office or multipurpose space
- Optional Fireplace for added warmth and ambiance

[Read More Online](#)

## Available Elevations





Elevation A

Want to Know More  
About This Home?

CONTACT OUR COMMUNITY SALES MANAGER  
Call Us @ 470.955.0875



Elevation A

Want to Know More  
About This Home?

CONTACT OUR COMMUNITY SALES MANAGER  
Call Us @ 470.955.0875



OPT Tub & Shower



OPT Fireplace

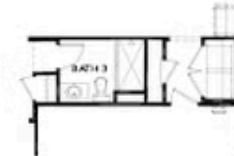

OPT Bath 3 ilo Powder Room

## FIRST FLOOR



OPT Shower Only



OPT Loft ilo Bedroom 3

## SECOND FLOOR

Want to Know More  
About This Home?

CONTACT OUR COMMUNITY SALES MANAGER  
Call Us @ 470.955.0875